

SUFFOLK DISTRICT DESIGN UNIT

REVISED	FHWA REGION	STATE	FEDERAL AID PROJECT	ROUTE	STATE PROJECT	REVISION
01-30-97	3	VA.		630	0630-099-165.M-501	4

DESIGN FEATURES RELATING TO CONSTRUCTION OR TO REGULATION AND CONTROL OF TRAFFIC MAY BE SUBJECT TO CHANGE AS DEEMED NECESSARY BY THE DEPARTMENT

NOTE: Contractor shall use extreme caution during excavation for subgrade due to lack of cover over 48", 42" and 16" Concrete Sanitary Force Main from Station 86+00± to Station 97+50±. Heavy Equipment to be restricted from operating within 6' of either side of the force mains until such time as excavation is removed by backhoe, grade all, etc. and the subgrade is placed. Contractor shall not excavate any material below the bottom of subgrade shown on the plan typical, unless otherwise directed by the Engineer. The Engineer shall contact Bill Harrison, Hampton Roads Sanitation District Systems Engineer, Telephone: (757-460-2261) two (2) working days prior to performing any excavation in the above noted locations. Basis of payment for this work to be same as other bid items.

■ DENOTES 12' HEAVY EQUIPMENT RESTRICTED OPERATING AREA.

6" Chain Link Fence	4" Cedar	Sign	4" Dogwood	3" Holly	Monarda	Light Pole	8" Metal Pipe	Inv. Out	Elev. 22.5'	Inv. In	Elev. 22.2'	2" Holly	2" Dogwood	Light Pole	Asphalt Paving	HMSD Valve	Rim Elev. 23.58	HMSD Valve	Rim Elev. 23.58	HMSD Valve	Rim Elev. 23.58	HMSD Valve	Rim Elev. 23.58
---------------------	----------	------	------------	----------	---------	------------	---------------	----------	-------------	---------	-------------	----------	------------	------------	----------------	------------	-----------------	------------	-----------------	------------	-----------------	------------	-----------------

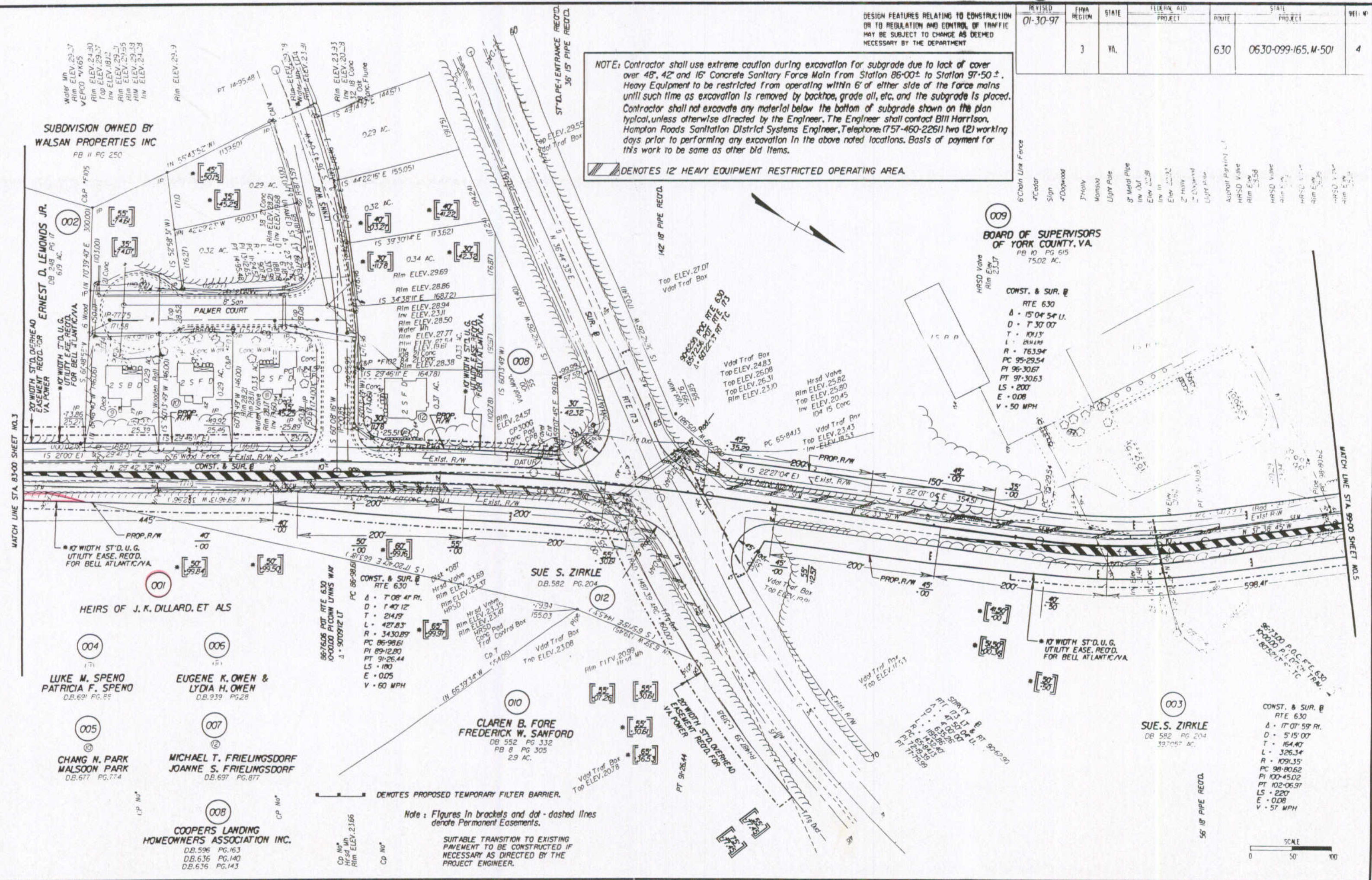

MATCH LINE STA. 83+00 SHEET NO. 3

MATCH LINE STA. 99+00 SHEET NO. 5

SUPERVISED BY: E. N. HOLLOVELL
 DESIGNED BY: D. B. WINSLOW
 CADD OPERATOR: [Name]
 REVISIONS BY: [Name]

PLAN	DATE	BY	REVISION
1	02/07/98	1453-46	

SUBDIVISION OWNED BY
WALSAN PROPERTIES INC
 PB 11 PG 250

**BOARD OF SUPERVISORS
 OF YORK COUNTY, VA.**
 PB 10 PG 615
 75.02 AC.

CONST. & SUR. #
 RTE 630
 A - 15' 04" 54" LI.
 D - 7' 30" 00"
 T - 1013'
 L - 2414'
 R - 763.94'
 PC 95+29.54
 PI 96+30.67
 PT 97+30.63
 LS - 200'
 E - 0.008
 V - 50 MPH

CONST. & SUR. #
 RTE 630
 A - 17' 07" 59" LI.
 D - 5' 15" 00"
 T - 164.40'
 L - 326.34'
 R - 1091.35'
 PC 98+80.62
 PI 100+45.02
 PT 102+06.97
 LS - 220'
 E - 0.008
 V - 57 MPH

Note: Figures in brackets and dot-dashed lines denote Permanent Easements.
 SUITABLE TRANSITION TO EXISTING PAVEMENT TO BE CONSTRUCTED IF NECESSARY AS DIRECTED BY THE PROJECT ENGINEER.

