

B:\9\01\7:24:10 AM \\\SSU-SERVER-04\PL0T\0C\A\B\Prof Barnes.JC \\\SSU-SERVER-04\Plot\01\13715003.D\F

Design File: c:\documents of me_jacob\1371513715003.dwg Ref. File: c:\documents of me_jacob\1371513715003.dwg Ref. File: c:\documents of me_jacob\1371513715003.dwg Ref. File: c:\documents of me_jacob\1371513715003.dwg Ref. File: c:\documents of me_jacob\1371513715003.dwg Ref. File: c:\documents of me_jacob\1371513715003.dwg Ref. File: c:\documents of me_jacob\1371513715003.dwg Ref. File: c:\documents of me_jacob\1371513715003.dwg Ref. File: c:\documents of me_jacob\1371513715003.dwg Ref. File: c:\documents of me_jacob\1371513715003.dwg
 Layers On: 143 Layers On: 143 Layers On: 143 Layers On: 143 Layers On: 143 Layers On: 143 Layers On: 143 Layers On: 143 Layers On: 143 Layers On: 143

SUFFOLK DISTRICT DESIGN UNIT

POWER POLES ARE PROPERTY OF DOMINION VIRGINIA POWER
 1500 HAMILTON AVE
 PORTSMOUTH, VA 23707

TELEPHONE POLES ARE PROPERTY OF VERIZON VIRGINIA INC.
 5701 CLEVELAND ST., FIFTH FLOOR
 NEWPORT NEWS, VA 23602

CABLE TELEVISION LINES PROPERTY OF COX COMMUNICATIONS
 1323 W. PEMBROKE AVE.
 HAMPTON VA 23661

NATURAL GAS LINES ARE PROPERTY OF VIRGINIA NATURAL GAS, INC.
 500 E. VIRGINIA BEACH BLVD.
 NORFOLK, VA 23502

WATERLINES PROPERTY OF NEWPORT NEWS WATERWORKS
 2600 WASHINGTON AVE, SIXTH FLOOR
 NEWPORT NEWS, VA 23607

DESIGN FEATURES RELATING TO CONSTRUCTION OR TO REGULATION AND CONTROL OF TRAFFIC MAY BE SUBJECT TO CHANGE AS DEEMED NECESSARY BY THE DEPARTMENT

REVISED	FHWA REGION	STATE	FEDERAL AID PROJECT	ROUTE	STATE PROJECT	SHEET NO.
	3	VA.		621	0621-099-181M-501	3

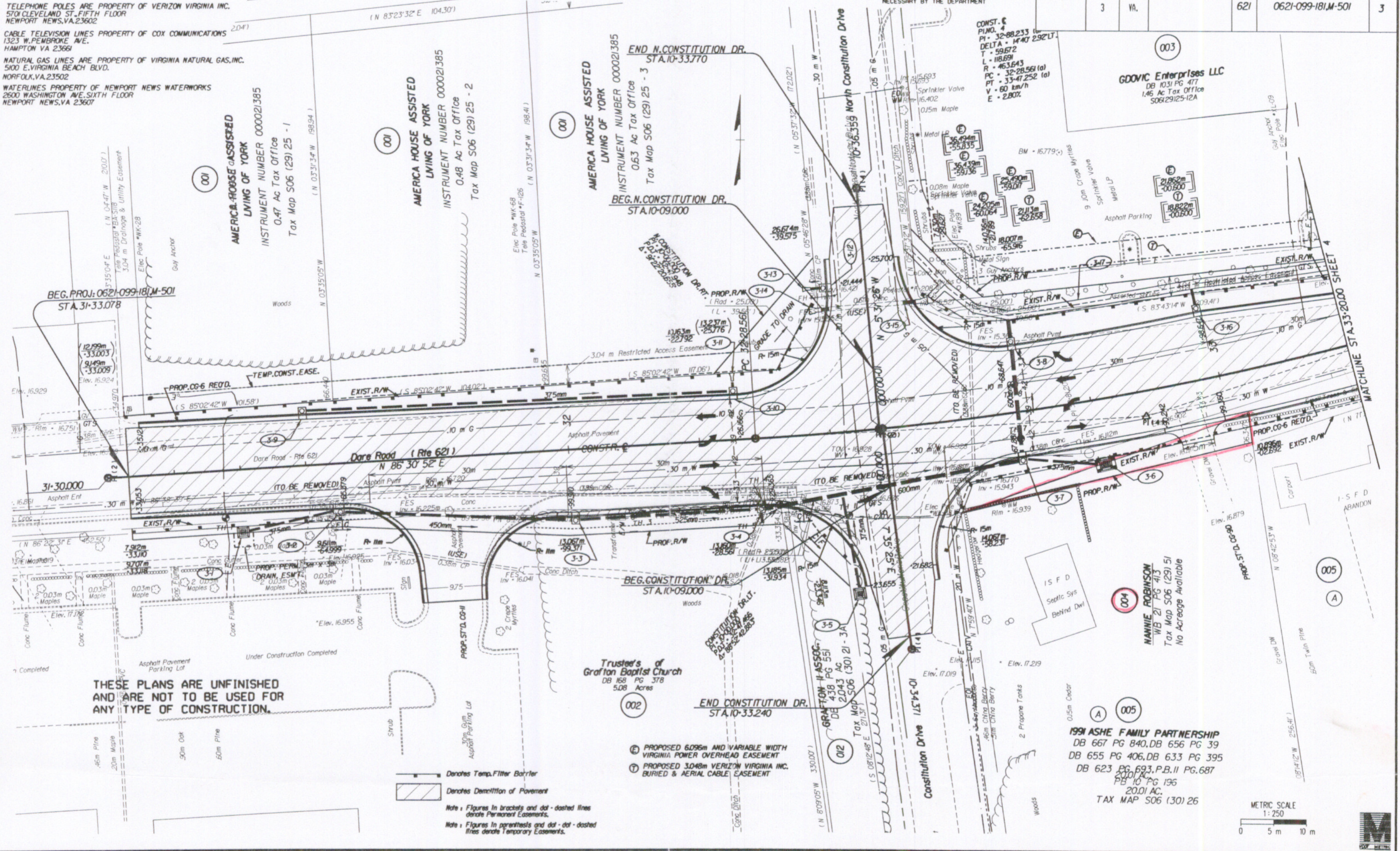

THESE PLANS ARE UNFINISHED AND ARE NOT TO BE USED FOR ANY TYPE OF CONSTRUCTION.

Denotes Temp. Filter Barrier
 Denotes Demolition of Pavement

Note: Figures in brackets and dot-dashed lines denote Permanent Easements.
 Note: Figures in parentheses and dot-dashed lines denote Temporary Easements.

CONST. E
 P.I. NO. 4
 P.I. = 32-88.233
 DELTA = 14.40 292°LT
 T = 59.672
 L = 118.691
 R = 463.643
 PC = 32-28.561 (a)
 PT = 33-47.252 (a)
 V = 60 km/h
 E = 2.80%

GDOVIC Enterprises LLC
 DB 103 PG 477
 1.46 Ac Tax Office
 506129125-12A

NANNIE ROBINSON
 WB 21 PG 413
 Tax Map S06 (29) 51
 No Acreage Available

1991 ASHE FAMILY PARTNERSHIP
 DB 667 PG 840, DB 656 PG 39
 DB 655 PG 406, DB 633 PG 395
 DB 623 PG 693, P.B. II PG. 687
 2001 AC
 TAX MAP S06 (30) 26

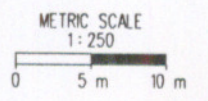

SURVEYED BY: M.L. SWANAGE, JR. 157-585-2862
 SUPERVISED BY: H.K. BAUTTS, JR. 157-945-3595
 DESIGNED BY: K.E. BATTEN, 157-945-6556
 CAD OPERATOR: M. JACOB 157-945-3715
 REVISED BY:

8/9/01 07:24:30