

VIRGINIA ELECTRIC & POWER CO.
Williamsburg - Yorktown
7 OCT 26
BETTY DIGGS
PLAT TO ACCOMPANY RIGHT-OF-WAY AGREEMENT
DISTRICT YORK COUNTY VA
SCALE: 1" = 100'

118

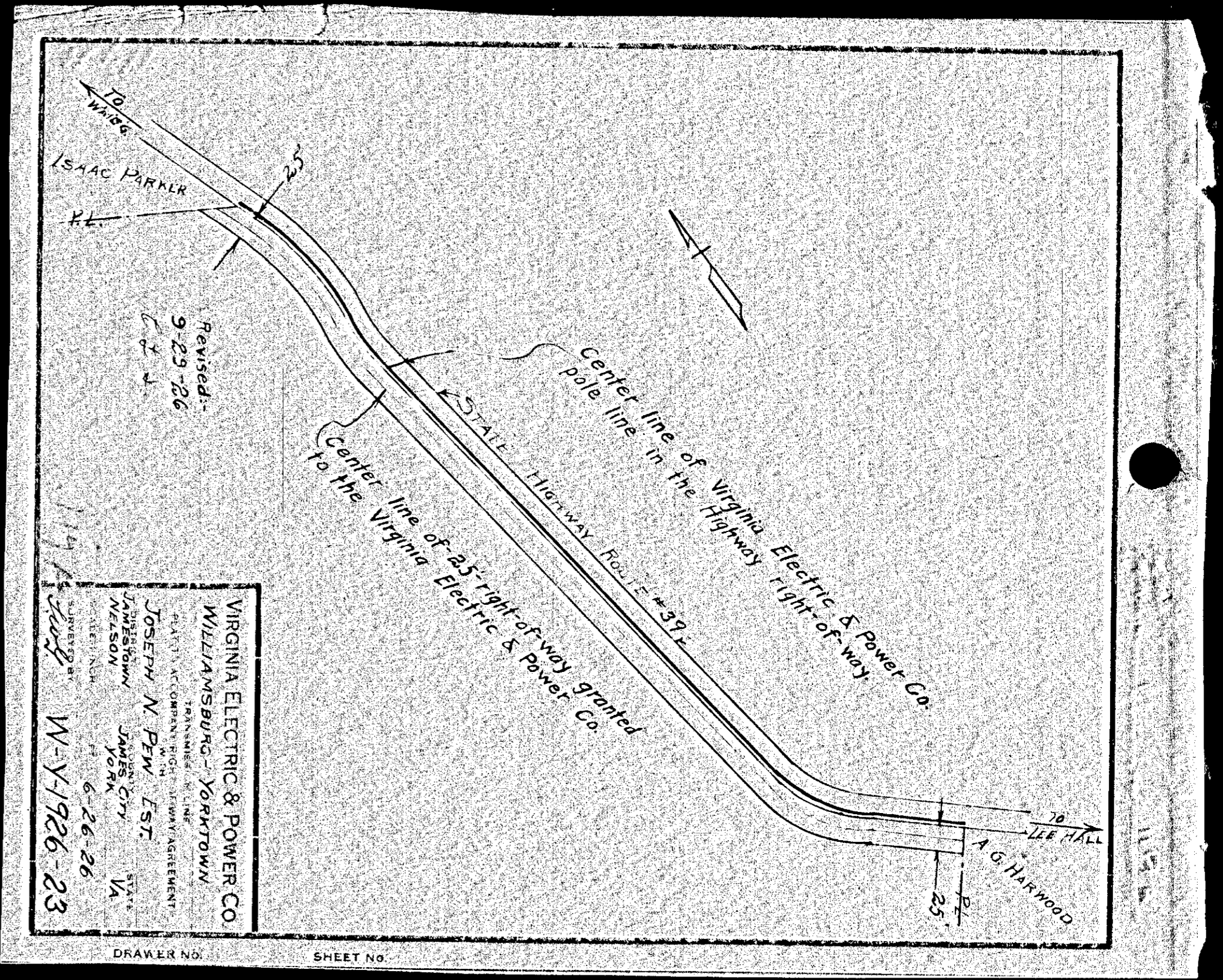

VIRGINIA ELECTRIC & POWER CO.
Williamsburg - Yorktown
JOSEPH N. PEW EST.
JAMES CITY VA
W-Y-19226-23
Revised: 9-29-26
C.I.T.

117A

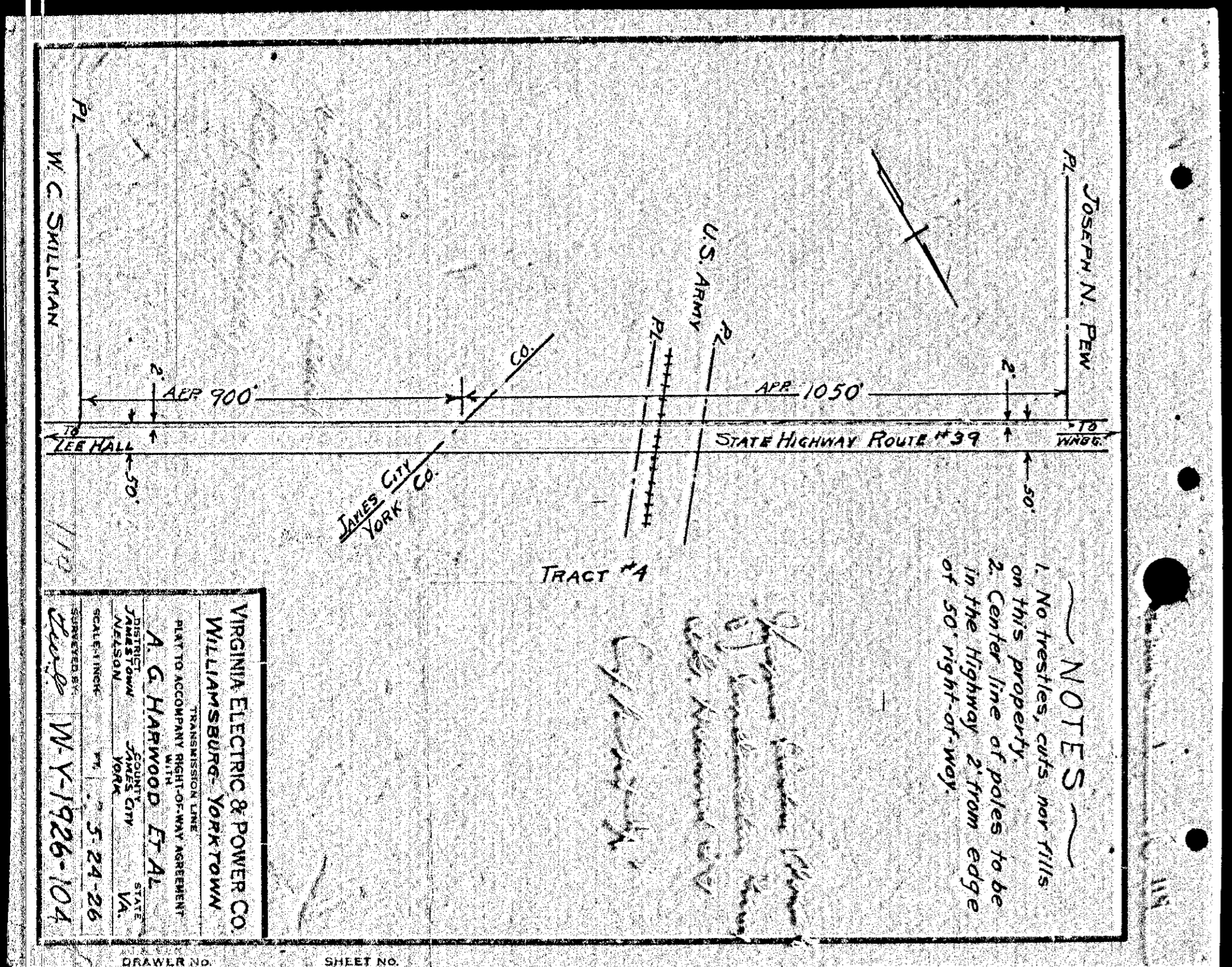

NOTES
1. No trees, cuts nor fills on this property.
2. Center line of poles to be in the Highway 2' from edge of 50' right-of-way.

VIRGINIA ELECTRIC & POWER CO.
Williamsburg - Yorktown
A. G. Harwood ET AL
JAMES CITY VA
W-Y-19226-104
Revised: 5-24-26
SCALE: 1" = 100'

119

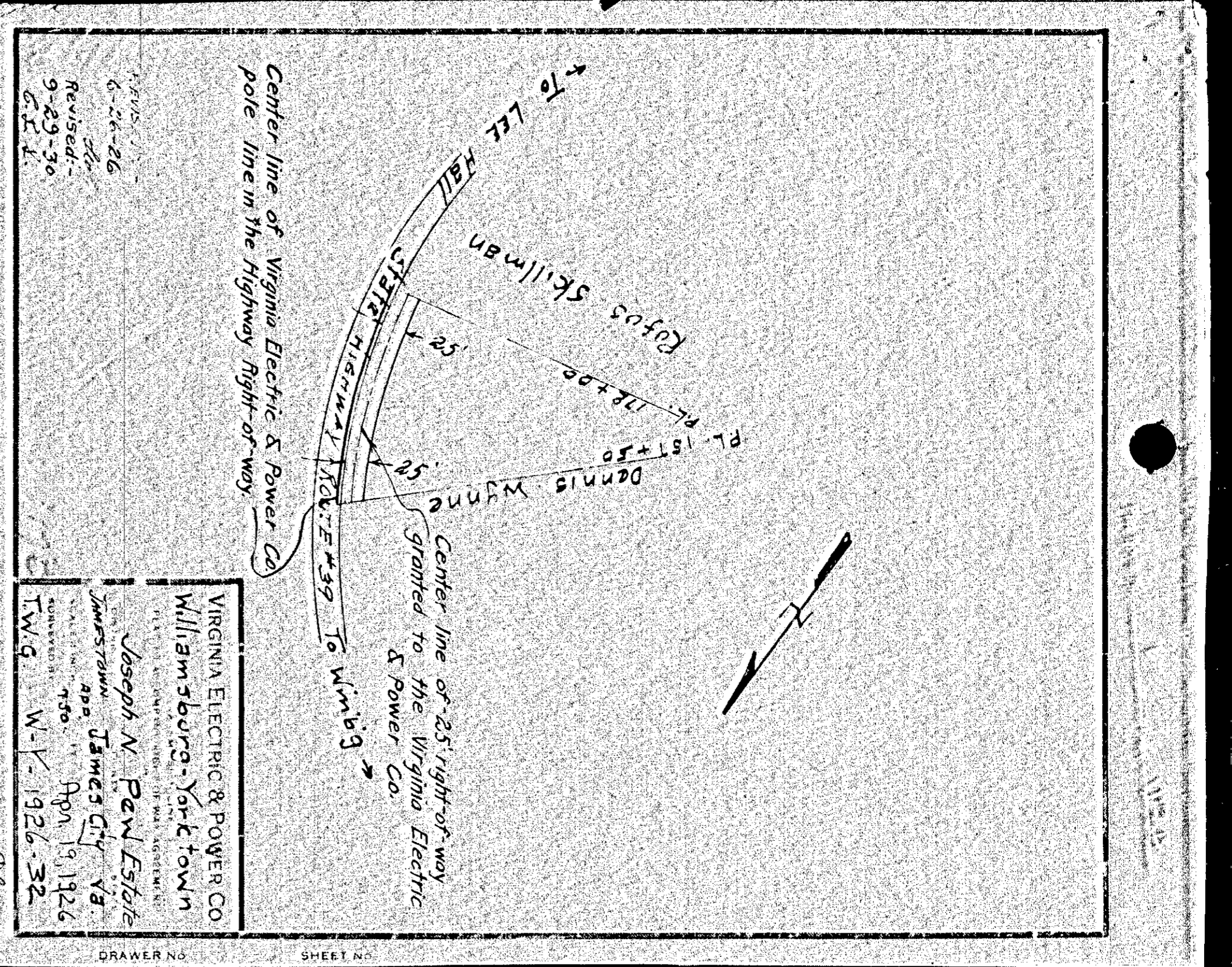

VIRGINIA ELECTRIC & POWER CO.
Williamsburg - Yorktown
Joseph N. Pew Estate
JAMES CITY VA
W-Y-19226-32
Revised: 9-29-30
C.I.T.

117B