

VIRGINIA ELECTRIC & POWER CO.
 WILLIAMSBURG - YORKTOWN
 TRANSMISSION LINE
 PLANT TO ACCOMPANY RIGHT-OF-WAY AGREEMENT
 WITH
 HATTIE LEWIS & NETTIE HARPER
 DISTRICT YORK VA.
 NELSON YORK VA.
 SCALE 1/4" = 200 FT. APRIL 22, 1928
 SUPERVISOR T.W.G. W-Y-1928-60

DRAWER NO. SHEET NO.

122

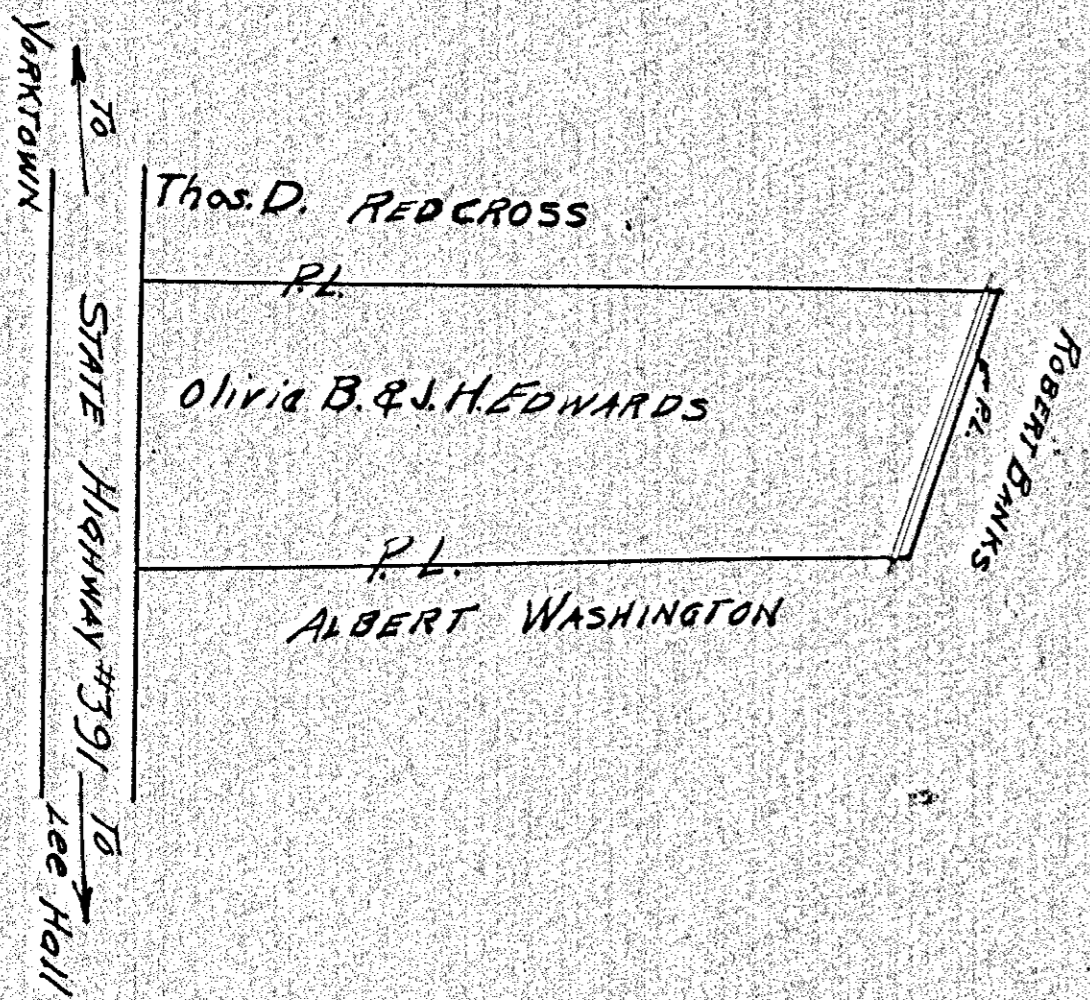

VIRGINIA ELECTRIC & POWER CO.
 WILLIAMSBURG - YORKTOWN
 TRANSMISSION LINE
 PLANT TO ACCOMPANY RIGHT-OF-WAY AGREEMENT
 WITH
 OLIVIA B. & J. H. EDWARDS
 DISTRICT YORK VA.
 NELSON YORK VA.
 SCALE 1/4" = 200 FT. APRIL 22, 1928
 SUPERVISOR T.W.G. W-Y-1928-56

W-Y-1928-56

123