

FILED OCT 21 1937  
 RECORDED  
 BOOK 52, PAGE 43  
 Floyd McIlwainy  
 Clerk

|   |                     |
|---|---------------------|
| VIRGINIA ELECTRIC & POWER CO.<br>YORK RIVER EXTENSION         |                     |
| TRANSMISSION LINE<br>PLAT TO ACCOMPANY RIGHT-OF-WAY AGREEMENT |                     |
| DISTRICT<br>BEUTON  | COUNTY<br>YORK      |
| STATE<br>VIRGINIA   |                     |
| SCALE: 1 INCH =   | FEET                |
| SUBMITTED BY<br>EBS   | DATE<br>APR 19 1937 |
| DRAWN BY<br>WMBG-1269   |                     |

DRAWER No. SHEET No.

341

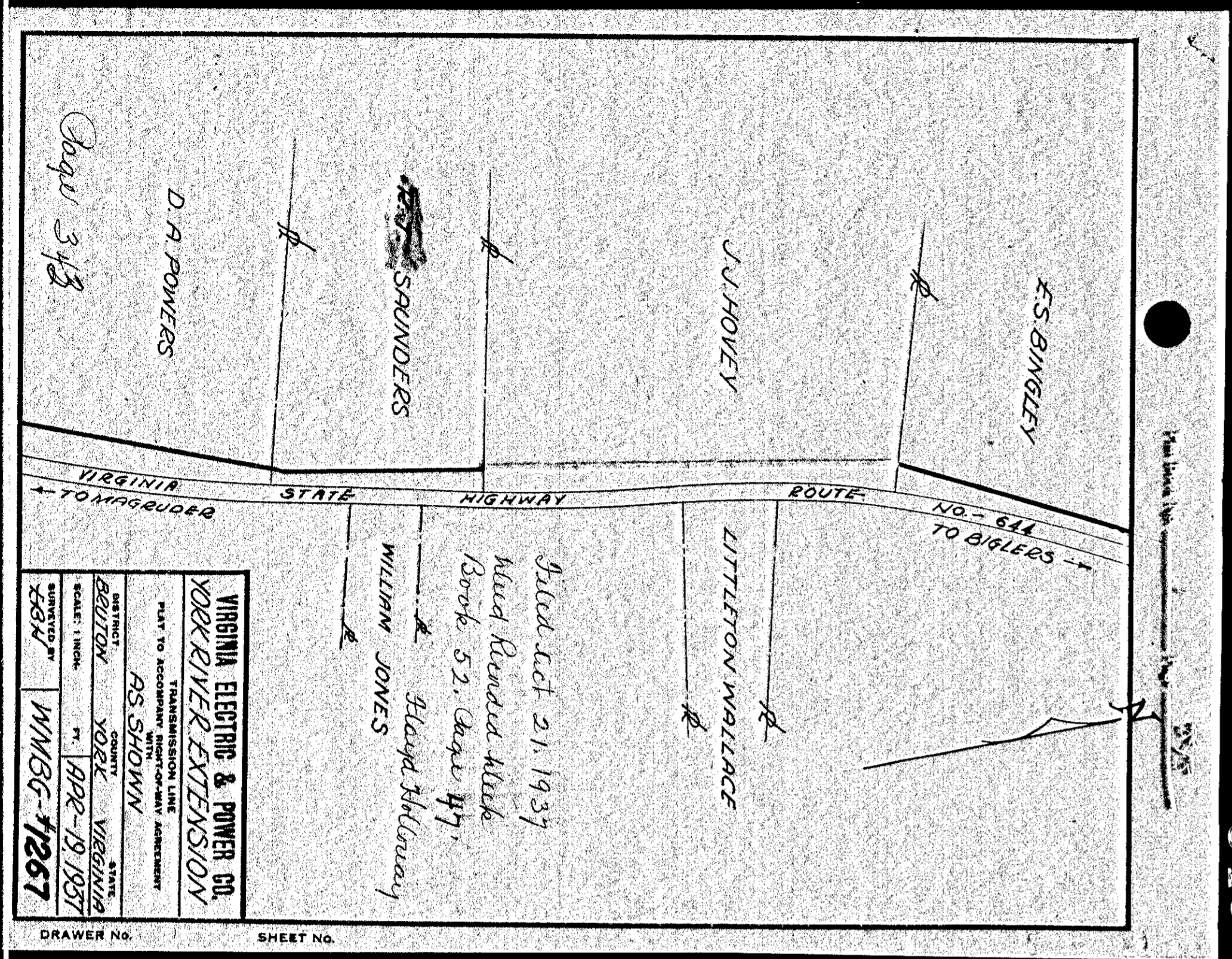

FILED OCT 21 1937  
 RECORDED  
 BOOK 52, PAGE 47  
 William Jones  
 Floyd McIlwainy  
 Clerk

|   |                     |
|---|---------------------|
| VIRGINIA ELECTRIC & POWER CO.<br>YORK RIVER EXTENSION         |                     |
| TRANSMISSION LINE<br>PLAT TO ACCOMPANY RIGHT-OF-WAY AGREEMENT |                     |
| DISTRICT<br>BEUTON  | COUNTY<br>YORK      |
| STATE<br>VIRGINIA   |                     |
| SCALE: 1 INCH =   | FEET                |
| SUBMITTED BY<br>EBS   | DATE<br>APR 19 1937 |
| DRAWN BY<br>WMBG-1267   |                     |

DRAWER No. SHEET No.

343

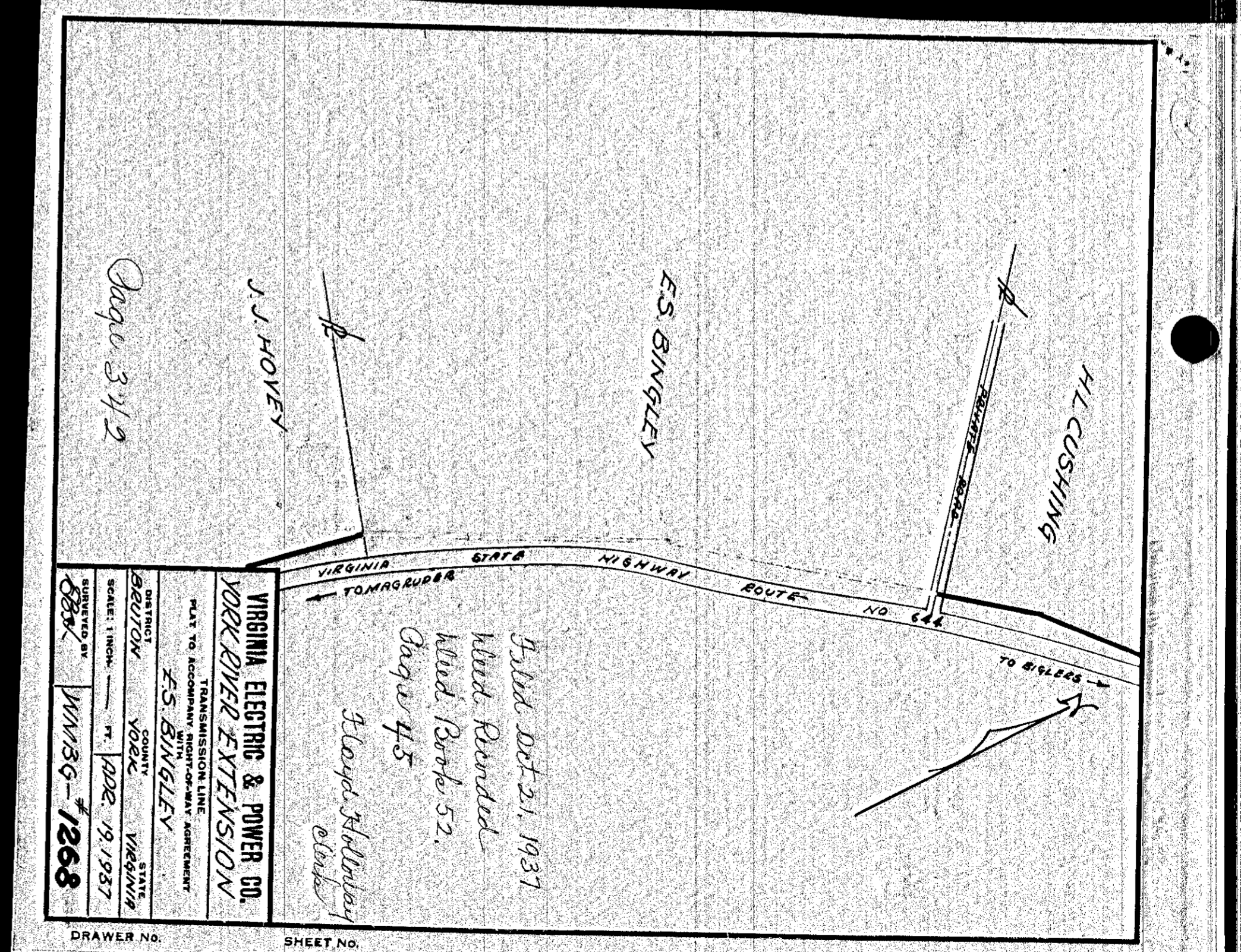

FILED OCT 21 1937  
 RECORDED  
 BOOK 52, PAGE 45  
 Floyd McIlwainy  
 Clerk

|   |                     |
|---|---------------------|
| VIRGINIA ELECTRIC & POWER CO.<br>YORK RIVER EXTENSION         |                     |
| TRANSMISSION LINE<br>PLAT TO ACCOMPANY RIGHT-OF-WAY AGREEMENT |                     |
| DISTRICT<br>BEUTON  | COUNTY<br>YORK      |
| STATE<br>VIRGINIA   |                     |
| SCALE: 1 INCH =   | FEET                |
| SUBMITTED BY<br>EBS   | DATE<br>APR 19 1937 |
| DRAWN BY<br>WMBG-1268   |                     |

DRAWER No. SHEET No.

342

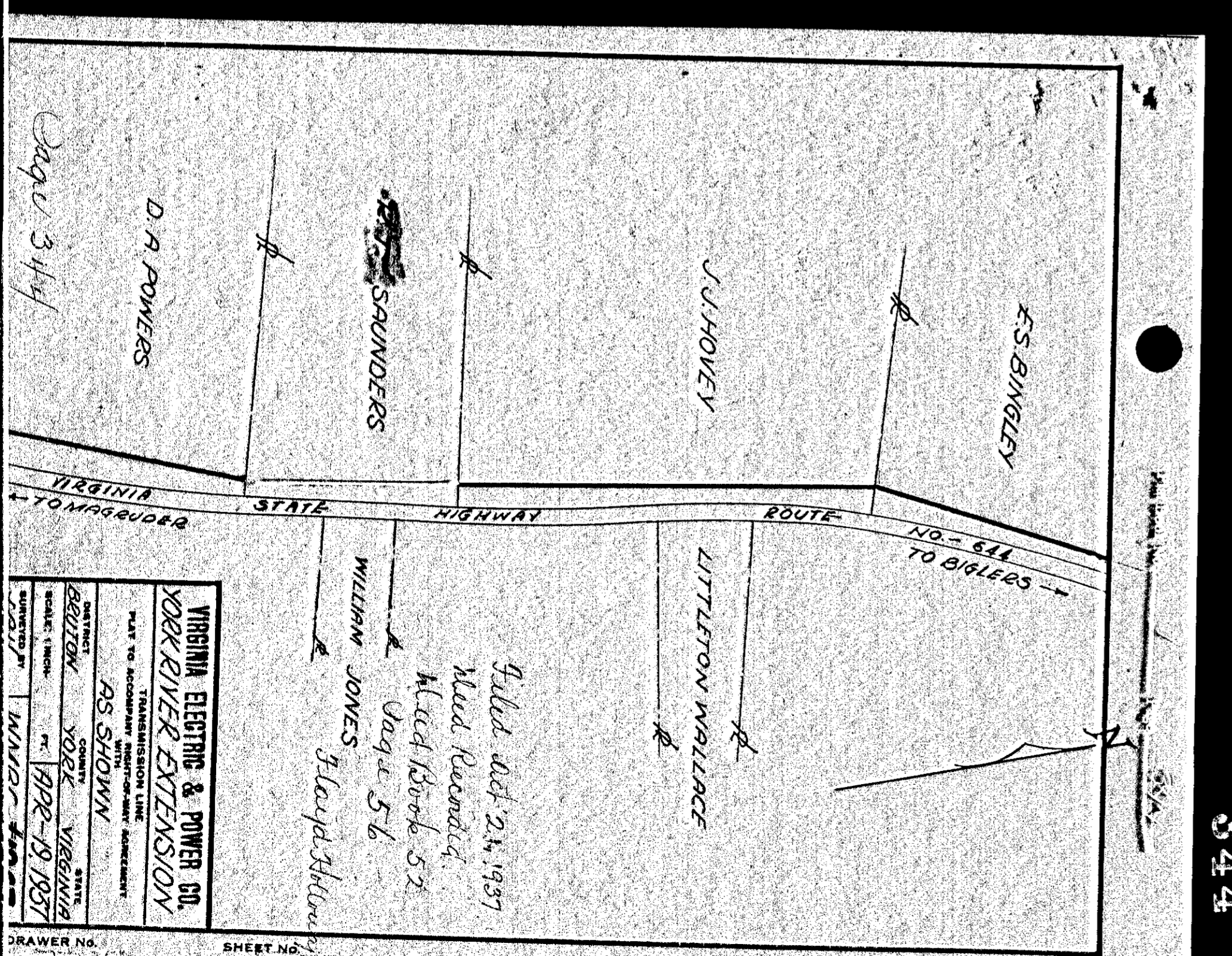

FILED OCT 24 1937  
 RECORDED  
 BOOK 52, PAGE 56  
 William Jones  
 Floyd McIlwainy  
 Clerk

|   |                     |
|---|---------------------|
| VIRGINIA ELECTRIC & POWER CO.<br>YORK RIVER EXTENSION         |                     |
| TRANSMISSION LINE<br>PLAT TO ACCOMPANY RIGHT-OF-WAY AGREEMENT |                     |
| DISTRICT<br>BEUTON  | COUNTY<br>YORK      |
| STATE<br>VIRGINIA   |                     |
| SCALE: 1 INCH =   | FEET                |
| SUBMITTED BY<br>EBS   | DATE<br>APR 19 1937 |
| DRAWN BY<br>WMBG-1267   |                     |

DRAWER No. SHEET No.

344