

VIRGINIA ELECTRIC & POWER CO.
 YORK RIVER EXTENSION
 TRANSMISSION LINE
 PLAT TO ACCOMPANY RIGHT-OF-WAY AGREEMENT
 DISTRICT POWERS & SHEPPARD
 COUNTY YORK
 STATE VIRGINIA
 SURVEYED BY WMBG-1266
 SCALE: 1 INCH = 100 FT. APR-19-1937
 DRAWN BY ZBN

DRAWER No. SHEET No.

345

347

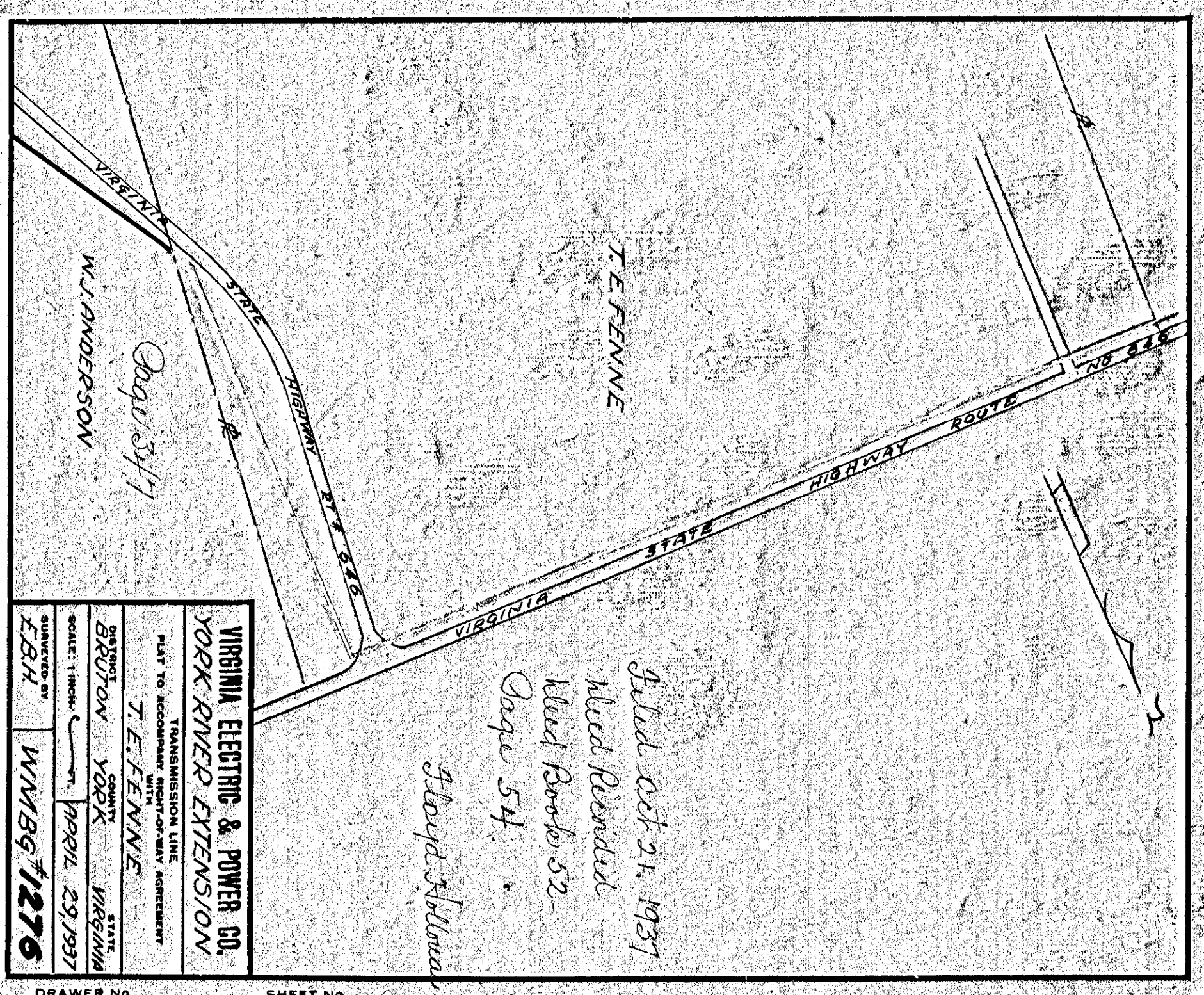

VIRGINIA ELECTRIC & POWER CO.
 YORK RIVER EXTENSION
 TRANSMISSION LINE
 PLAT TO ACCOMPANY RIGHT-OF-WAY AGREEMENT
 DISTRICT T.E. FENNE
 COUNTY YORK
 STATE VIRGINIA
 SURVEYED BY WMBG-1276
 SCALE: 1 INCH = 100 FT. APR-19-1937
 DRAWN BY ZBN

DRAWER No. SHEET No.

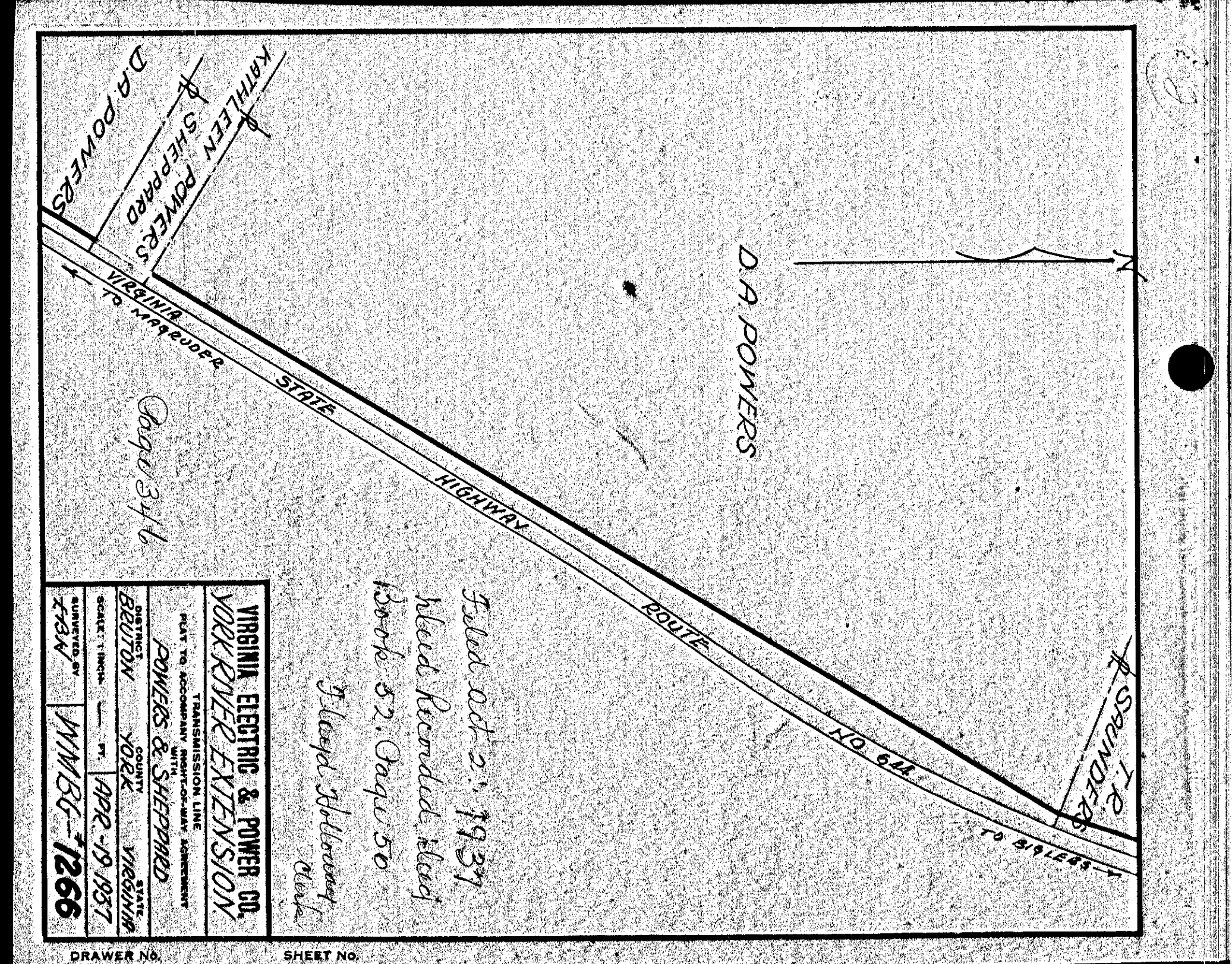

VIRGINIA ELECTRIC & POWER CO.
 YORK RIVER EXTENSION
 TRANSMISSION LINE
 PLAT TO ACCOMPANY RIGHT-OF-WAY AGREEMENT
 DISTRICT POWERS & SHEPPARD
 COUNTY YORK
 STATE VIRGINIA
 SURVEYED BY WMBG-1266
 SCALE: 1 INCH = 100 FT. APR-19-1937
 DRAWN BY ZBN

DRAWER No. SHEET No.

346

348

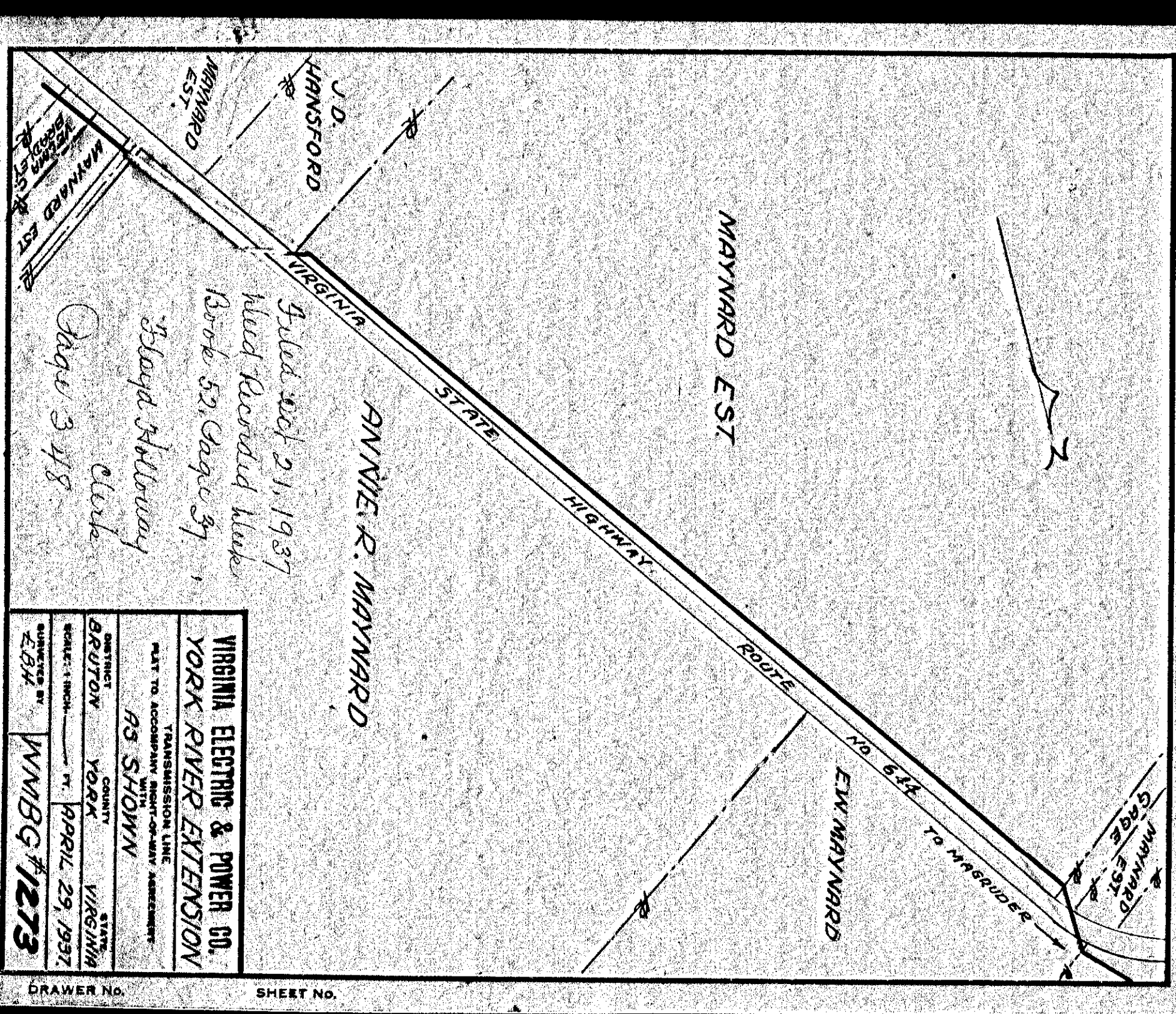

VIRGINIA ELECTRIC & POWER CO.
 YORK RIVER EXTENSION
 TRANSMISSION LINE
 PLAT TO ACCOMPANY RIGHT-OF-WAY AGREEMENT
 DISTRICT AS SHOWN
 COUNTY YORK
 STATE VIRGINIA
 SURVEYED BY WMBG-1273
 SCALE: 1 INCH = 100 FT. APR-19-1937
 DRAWN BY ZBN

DRAWER No. SHEET No.