

Page 404
 Filed May 16, 1938
 Deed Recorded
 Deed Book No. 53, Page 477
 Floyd Hallaway, Clerk

VIRGINIA ELECTRIC & POWER CO.
 MAGEUDEE DISTRIBUTION

PLAT TO ACCOMPANY RIGHT-OF-WAY AGREEMENT
 AS SHOWN

DISTRICT COUNTY STATE
 CITY OF WILLIAMSBURG YORK VA

SCALE: 1 INCH = 40 FT. DEC. 8, 1938.

DRAWN BY *CSG* NYMBG.1405

404

406

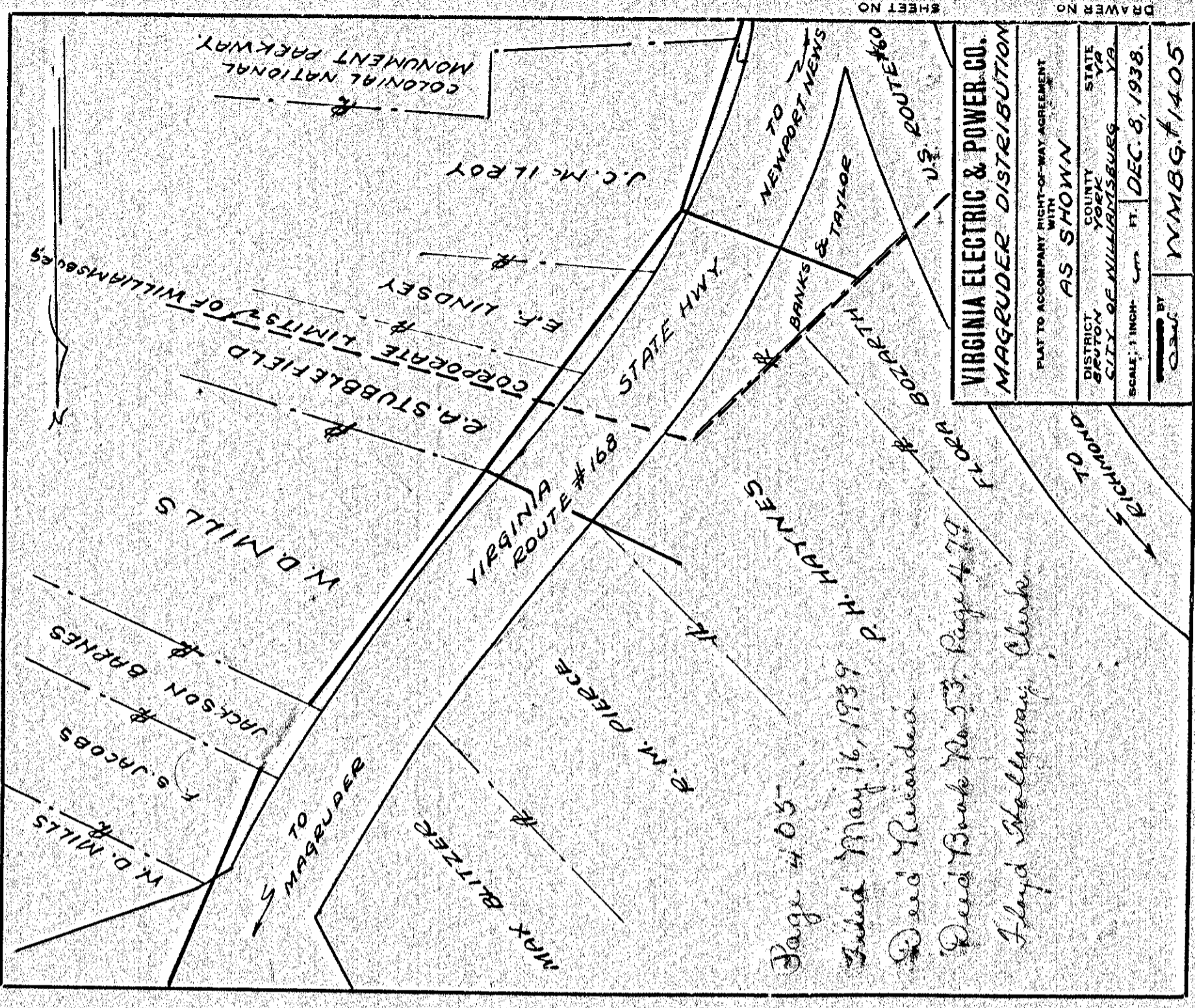

Page 405
 Filed May 16, 1938
 Deed Recorded
 Deed Book No. 53, Page 479
 Floyd Hallaway, Clerk

VIRGINIA ELECTRIC & POWER CO.
 MAGEUDEE DISTRIBUTION

PLAT TO ACCOMPANY RIGHT-OF-WAY AGREEMENT
 AS SHOWN

DISTRICT COUNTY STATE
 CITY OF WILLIAMSBURG YORK VA

SCALE: 1 INCH = 40 FT. DEC. 8, 1938.

DRAWN BY *CSG* NYMBG.1405

405

407

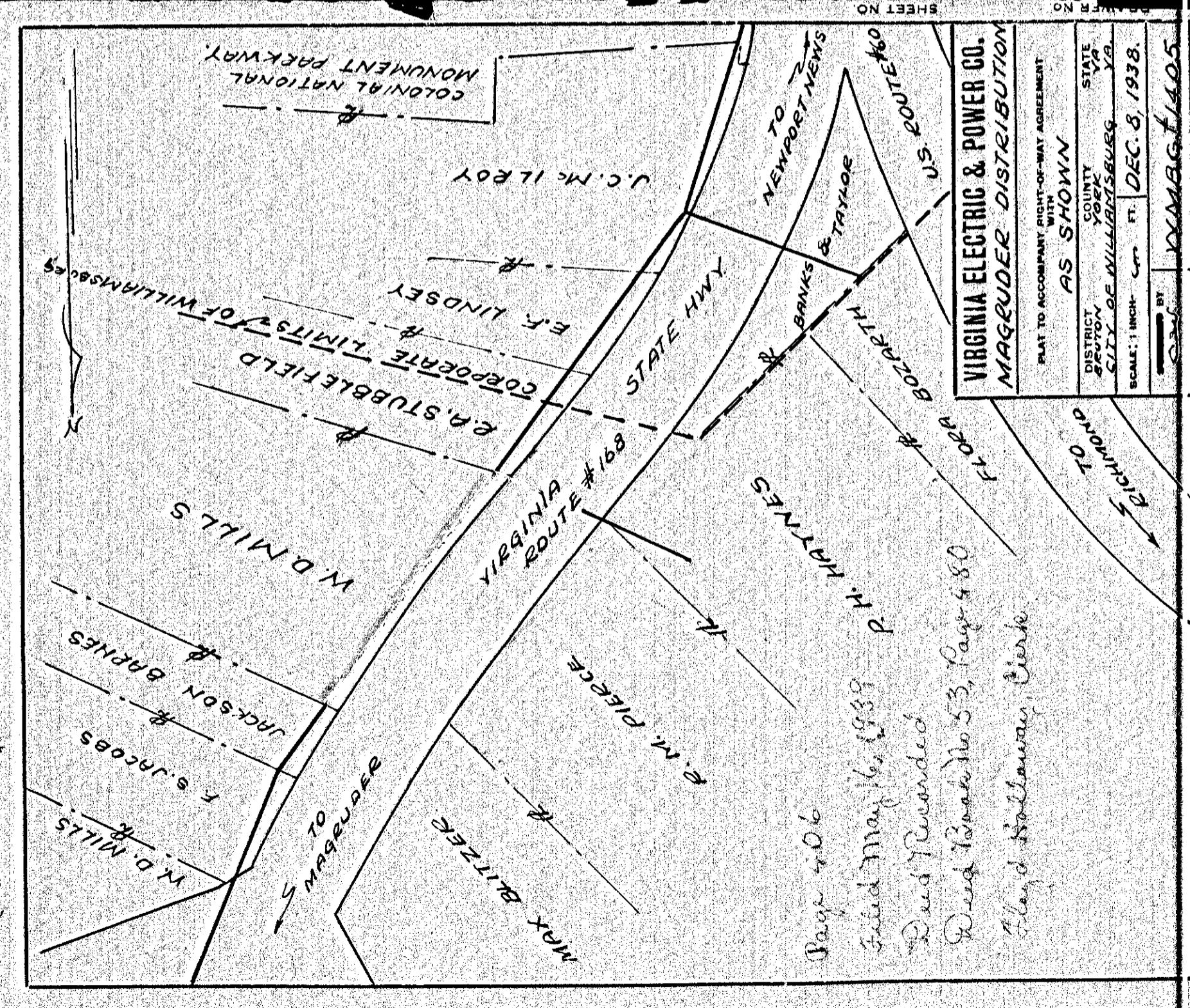

Page 406
 Filed May 16, 1938
 Deed Recorded
 Deed Book No. 53, Page 480
 Floyd Hallaway, Clerk

VIRGINIA ELECTRIC & POWER CO.
 MAGEUDEE DISTRIBUTION

PLAT TO ACCOMPANY RIGHT-OF-WAY AGREEMENT
 AS SHOWN

DISTRICT COUNTY STATE
 CITY OF WILLIAMSBURG YORK VA

SCALE: 1 INCH = 40 FT. DEC. 8, 1938.

DRAWN BY *CSG* NYMBG.1405

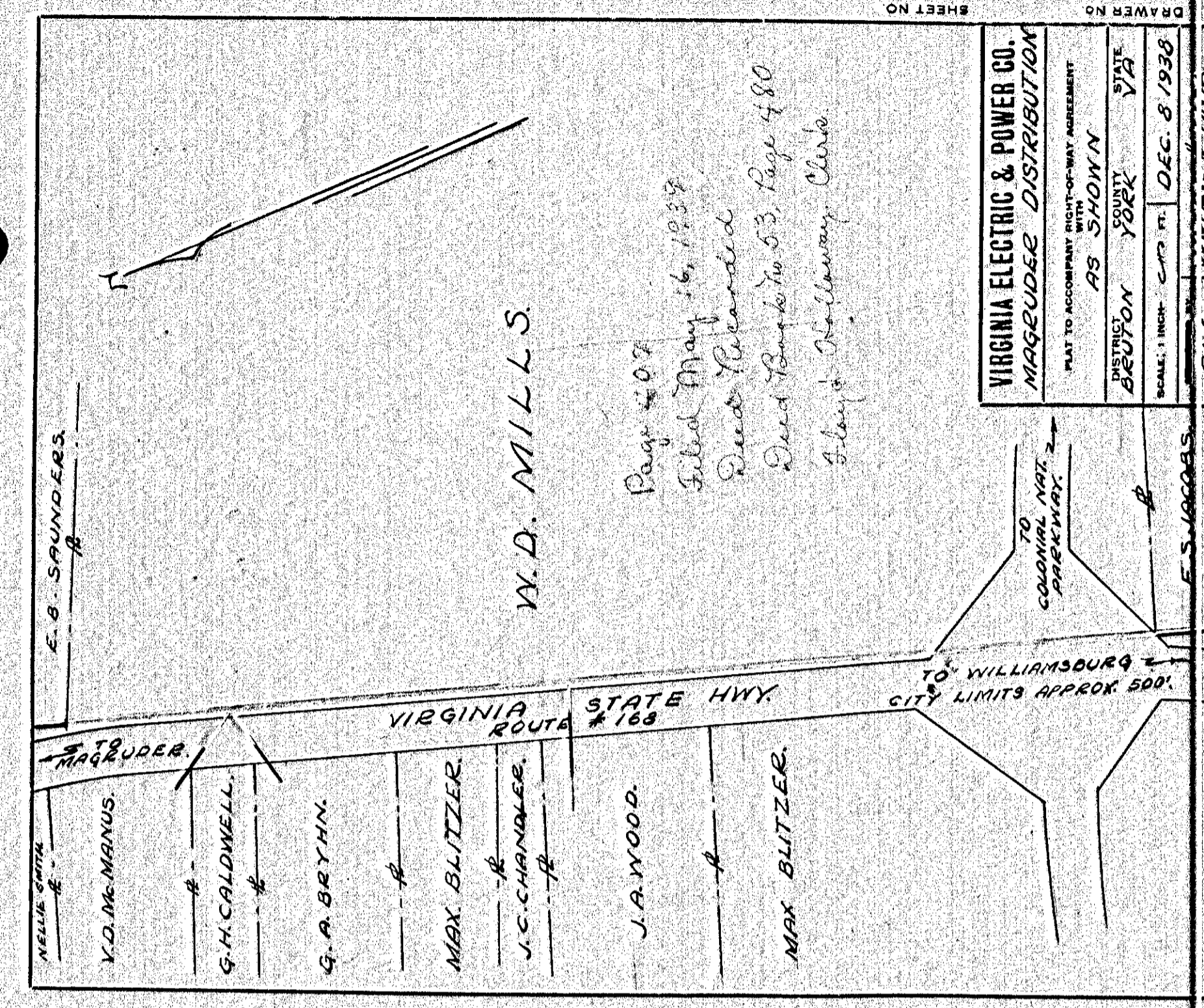

Page 407
 Filed May 16, 1938
 Deed Recorded
 Deed Book No. 53, Page 480
 Floyd Hallaway, Clerk

VIRGINIA ELECTRIC & POWER CO.
 MAGEUDEE DISTRIBUTION

PLAT TO ACCOMPANY RIGHT-OF-WAY AGREEMENT
 AS SHOWN

DISTRICT COUNTY STATE
 CITY OF WILLIAMSBURG YORK VA

SCALE: 1 INCH = 40 FT. DEC. 8, 1938.

DRAWN BY *CSG* NYMBG.1405

405

407