

VIRGINIA ELECTRIC & POWER CO.
 Magruder Extension
 TAVIS Extension
 PLAT TO ACCOMPANY RIGHT-OF-WAY AGREEMENT WITH
 DISTRICT W. H. Parker COUNTY York STATE Va.
 DISTRICT Burke COUNTY Burke STATE Va.
 SCALE: 1" = 100'
 DRAWN BY W. E. Pointer NMBG #1539

DRAWER NO. SHEET NO.

501

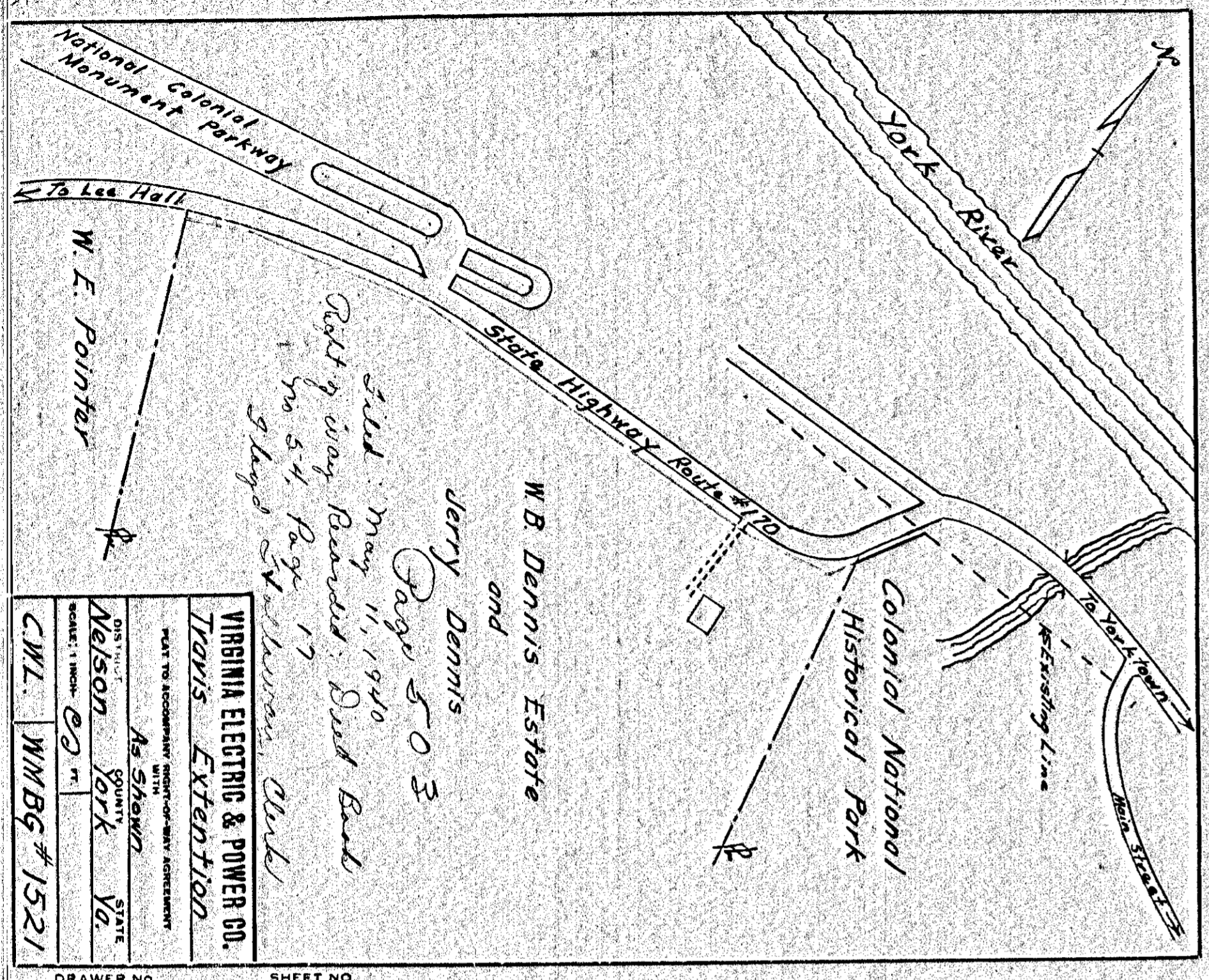

VIRGINIA ELECTRIC & POWER CO.
 Tavis Extension
 PLAT TO ACCOMPANY RIGHT-OF-WAY AGREEMENT WITH
 DISTRICT As Shown COUNTY York STATE Va.
 DISTRICT Nelson COUNTY York STATE Va.
 SCALE: 1" = 100'
 DRAWN BY C.W.L. NMBG #1521

DRAWER NO. SHEET NO.

503

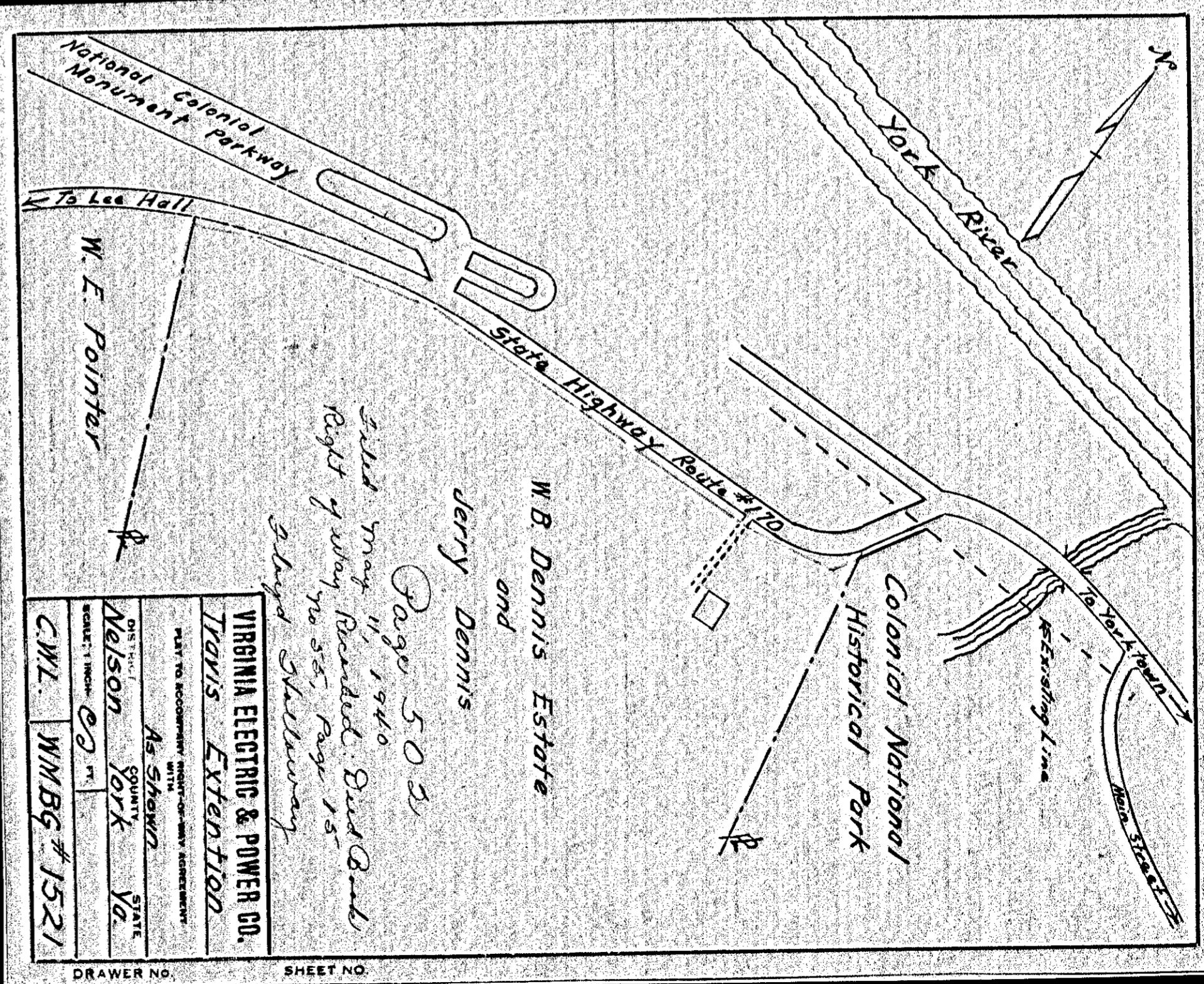

VIRGINIA ELECTRIC & POWER CO.
 TAVIS Extension
 PLAT TO ACCOMPANY RIGHT-OF-WAY AGREEMENT WITH
 DISTRICT As Shown COUNTY York STATE Virginia
 DISTRICT Nelson COUNTY York STATE Virginia
 SCALE: 1" = 100'
 DRAWN BY C.W.L. NMBG #1551

DRAWER NO. SHEET NO.

502

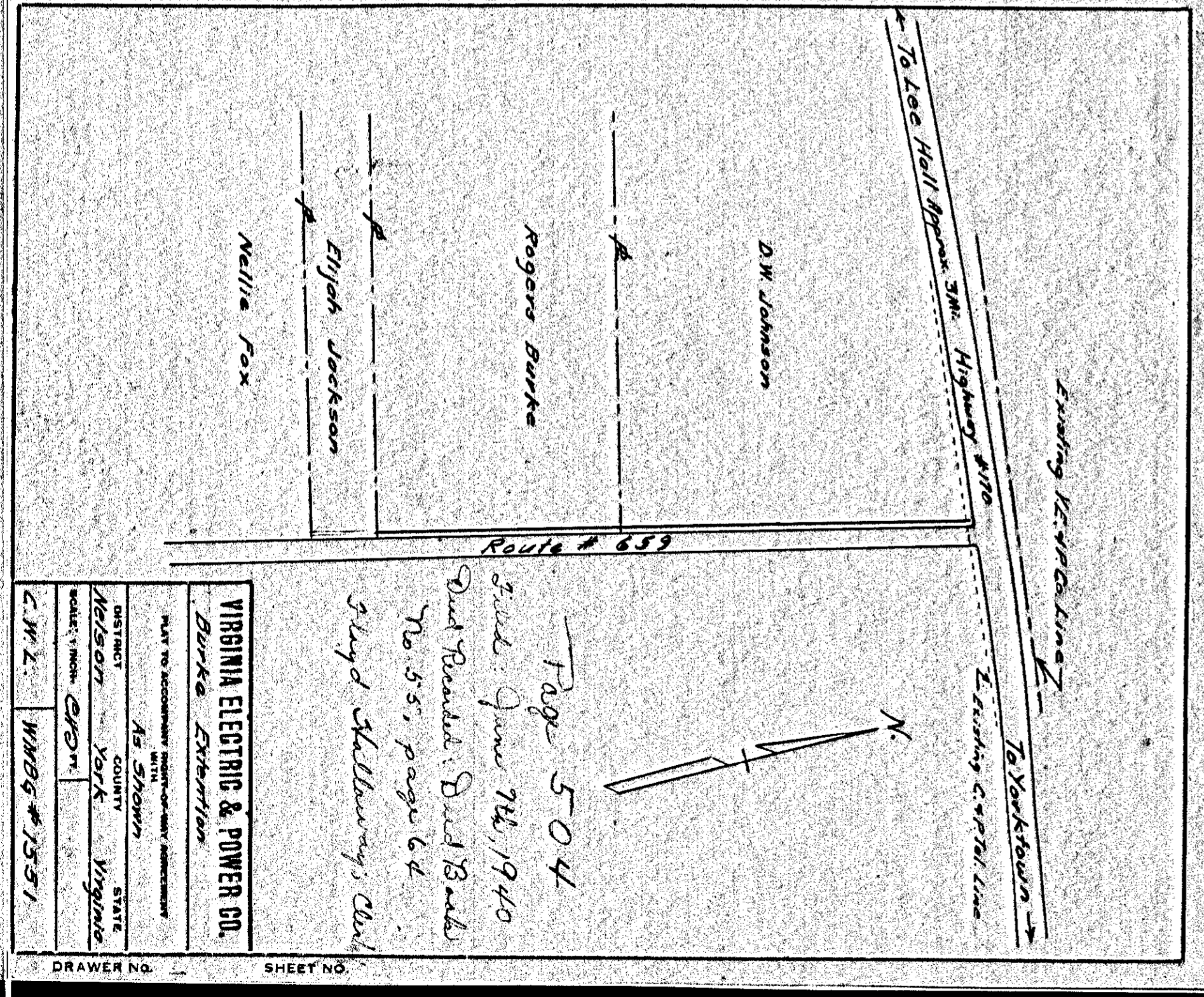

VIRGINIA ELECTRIC & POWER CO.
 Burke Extension
 PLAT TO ACCOMPANY RIGHT-OF-WAY AGREEMENT WITH
 DISTRICT As Shown COUNTY York STATE Virginia
 DISTRICT Nelson COUNTY York STATE Virginia
 SCALE: 1" = 100'
 DRAWN BY C.W.L. NMBG #1551

DRAWER NO. SHEET NO.

504