

PLAT TO ACCOMPANY RIGHT-OF-WAY AGREEMENT WITH  
**VIRGINIA ELECTRIC & POWER CO.**  
 Johnson Extension

DISTRICT **As Shown** COUNTY **York** STATE **Va**  
 DISTRICT **Bruton** COUNTY **York** STATE **Va**  
 SCALE: 1 INCH = 60 FT. CWL WMBG # 1512

DRAWER NO. SHEET NO.

Page 576  
 filed July 1, 1941  
 Recorded Deed Book  
 No. 56, page 449  
 Lloyd Shillingworth  
 Clerk

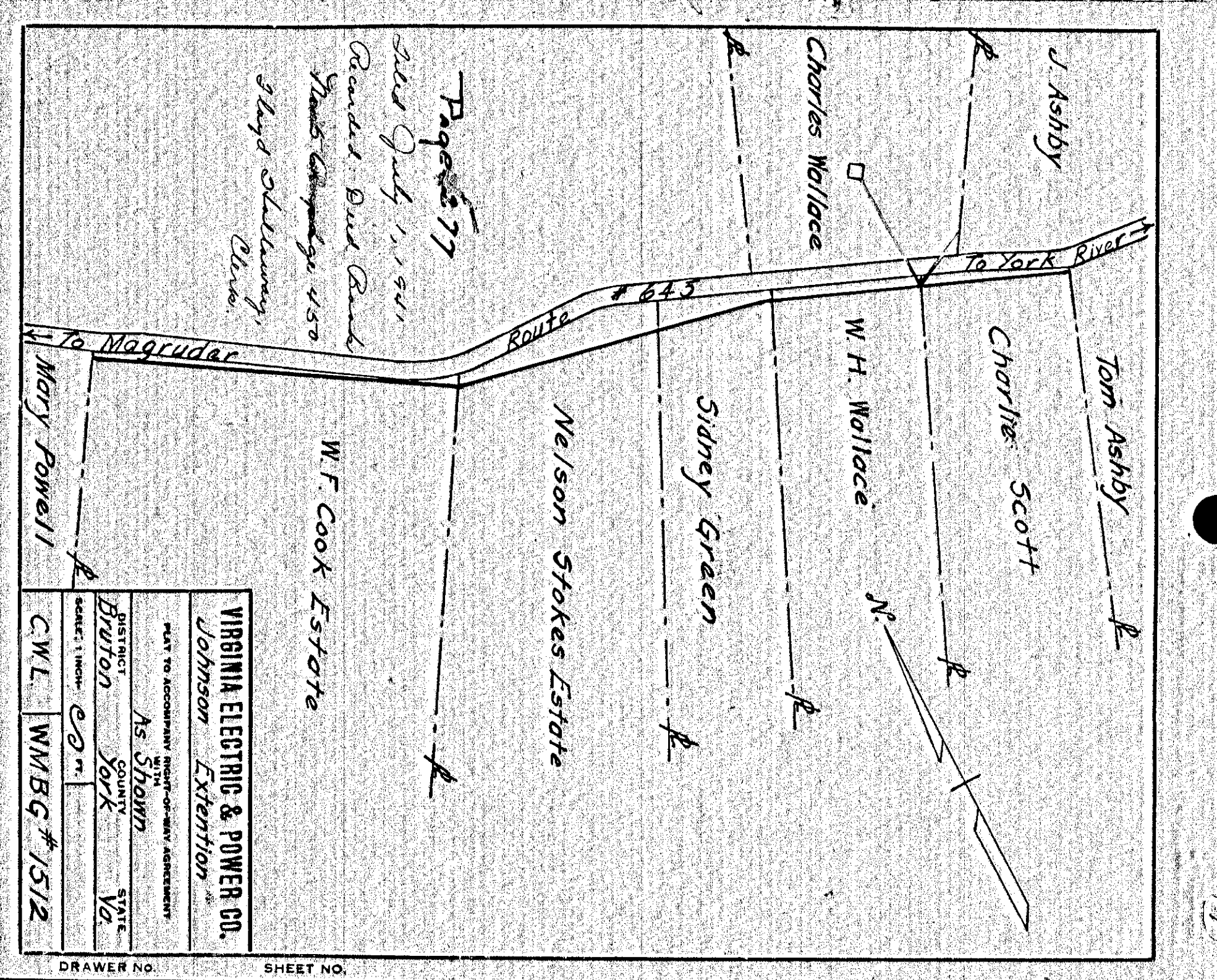

PLAT TO ACCOMPANY RIGHT-OF-WAY AGREEMENT WITH  
**VIRGINIA ELECTRIC & POWER CO.**  
 Johnson Extension

DISTRICT **As Shown** COUNTY **York** STATE **Va**  
 DISTRICT **Bruton** COUNTY **York** STATE **Va**  
 SCALE: 1 INCH = 60 FT. CWL WMBG # 1512

DRAWER NO. SHEET NO.

Page 577  
 filed July 1, 1941  
 Recorded Deed Book  
 No. 56, page 452  
 Lloyd Shillingworth  
 Clerk

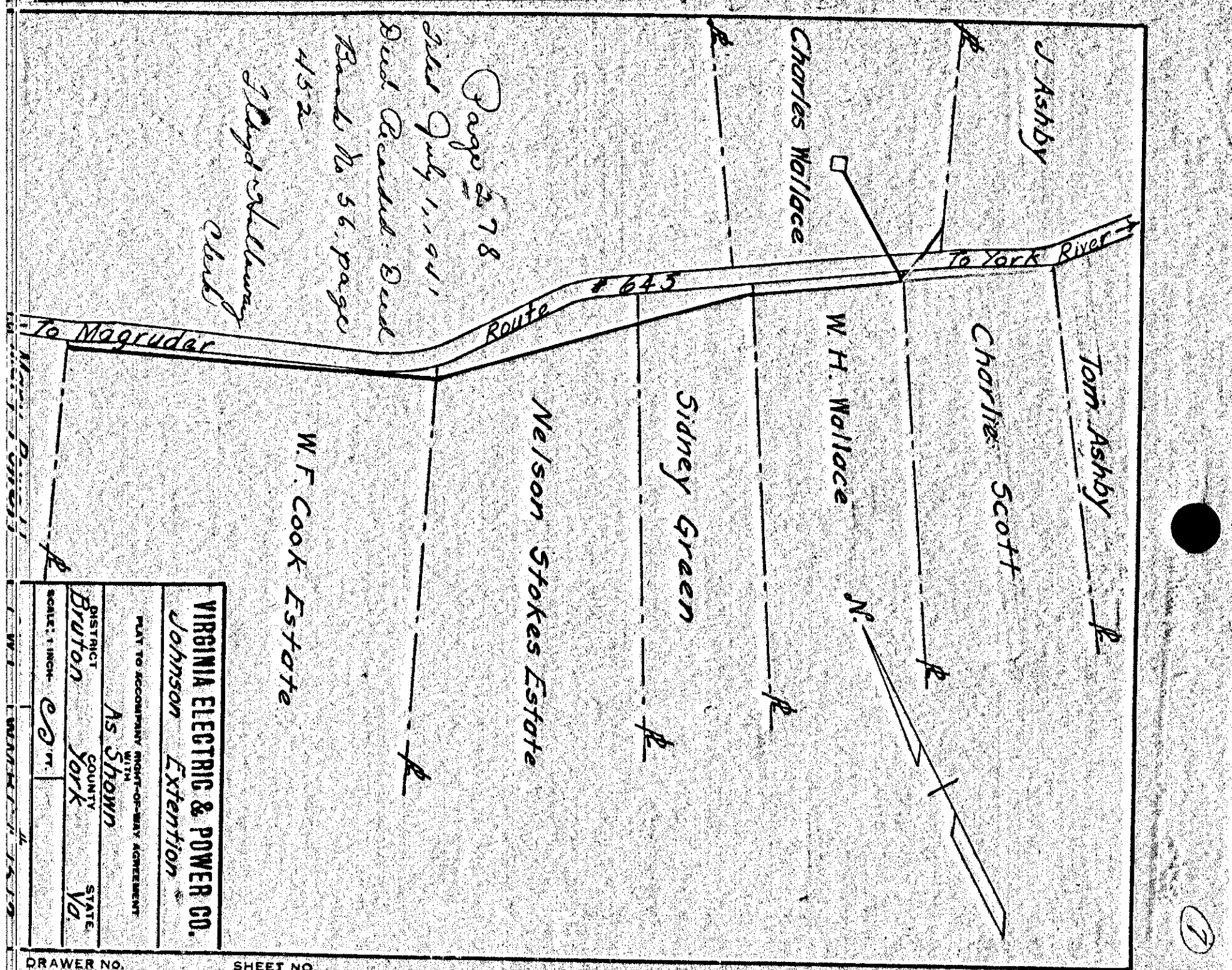

PLAT TO ACCOMPANY RIGHT-OF-WAY AGREEMENT WITH  
**VIRGINIA ELECTRIC & POWER CO.**  
 Johnson Extension

DISTRICT **As Shown** COUNTY **York** STATE **Va**  
 DISTRICT **Bruton** COUNTY **York** STATE **Va**  
 SCALE: 1 INCH = 60 FT. CWL WMBG # 1512

DRAWER NO. SHEET NO.

Page 578  
 filed July 1, 1941  
 Recorded Deed Book  
 No. 56, page 452  
 Lloyd Shillingworth  
 Clerk

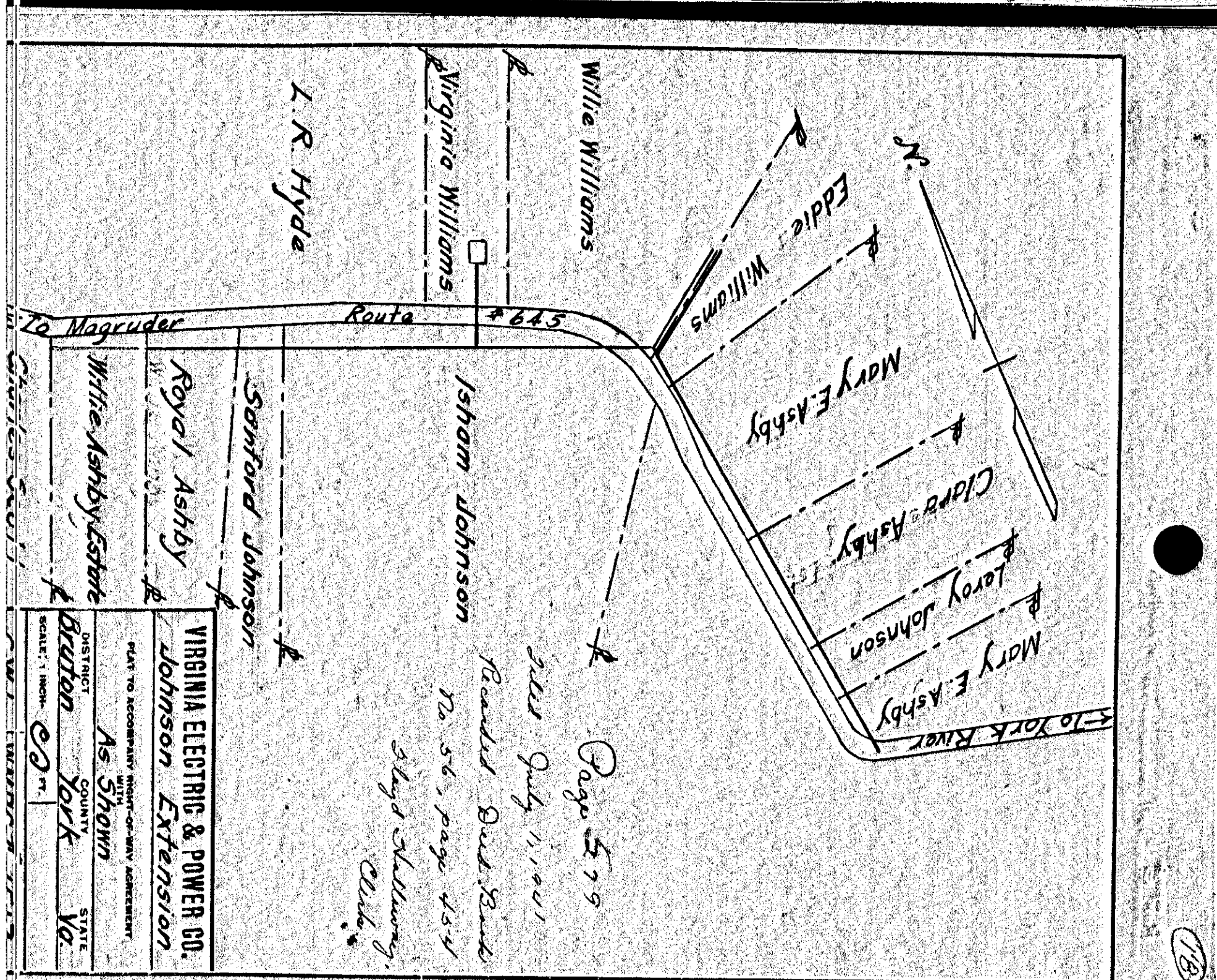

PLAT TO ACCOMPANY RIGHT-OF-WAY AGREEMENT WITH  
**VIRGINIA ELECTRIC & POWER CO.**  
 Johnson Extension

DISTRICT **As Shown** COUNTY **York** STATE **Va**  
 DISTRICT **Bruton** COUNTY **York** STATE **Va**  
 SCALE: 1 INCH = 60 FT. CWL WMBG # 1512

DRAWER NO. SHEET NO.

Page 579  
 filed July 1, 1941  
 Recorded Deed Book  
 No. 56, page 454  
 Lloyd Shillingworth  
 Clerk

578

579

576

577