

The Oyster Assignment of which this Plat is a part is recorded in Oyster Book no. 3, page 274.

DATE OF APPLICATION		COMMONWEALTH OF VIRGINIA COMMISSION OF FISHERIES	FOR OFFICE USE	
DATE OF ASSIGNMENT			PLAT NO.	
COUNTY RECORDED IN			MAP NO.	
BOOK	PAGE		FILE NO.	
No.	No.			

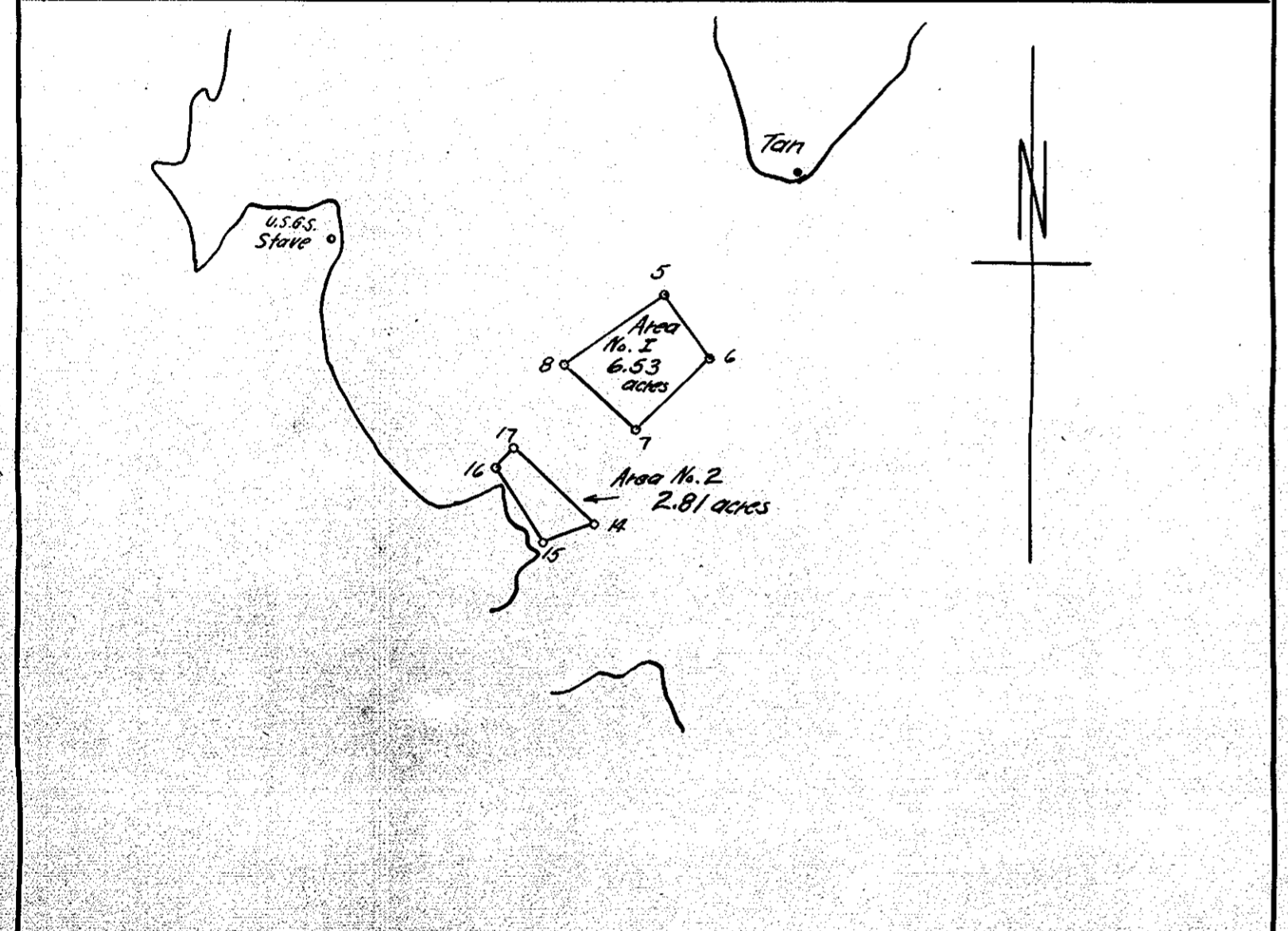

Tan		Stave	
123°04'	5	2°35'	
101°57'	6	11°00'	
108°01'	7	25°13'	
126°06'	8	21°31'	
105°59'	14	46°40'	
110°00'	15	48°12'	
121°12'	16	47°53'	
121°54'	17	42°17'	
360°00'	Stave	360°00'	
74°05'		21°09'	Round Water Tank, L. Field
61°06'			Langley's Pond
8°21'		11°13'	Fox Hill "
312°48'		333°55'	S. gable Amoy Wharf
		167°16'	Tall Stack L. Field

Tan - Stave - $STG^{\circ}09'E - 4475'$
 Stave - Tan - $N82^{\circ}11'E - 2591'$

OYSTER PLANTING GROUND

J.C. Carmines of
 Back River IN

District No. 17 York COUNTY
 Scale 10000 Sept. 29 1947

Surveyed by B.H. [Signature]
 SURVEYOR

Deed Book 64

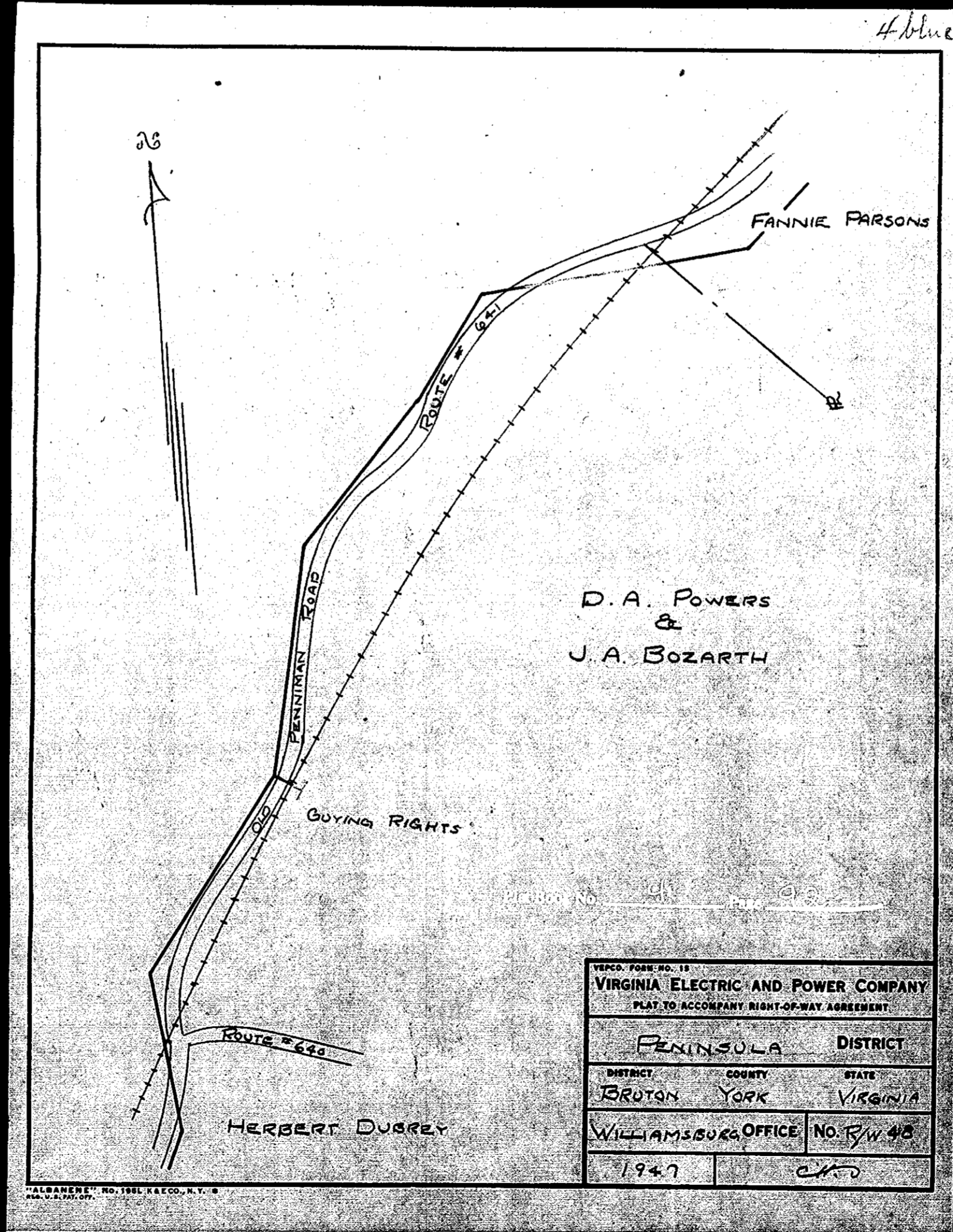

VERCO. FORM NO. 13
VIRGINIA ELECTRIC AND POWER COMPANY
 PLAT TO ACCOMPANY RIGHT-OF-WAY AGREEMENT

PENINSULA DISTRICT

DISTRICT COUNTY STATE
 BRUTON YORK VIRGINIA

WILLIAMSBURG OFFICE NO. RW 40
 1947 [Signature]

Deed Book 64

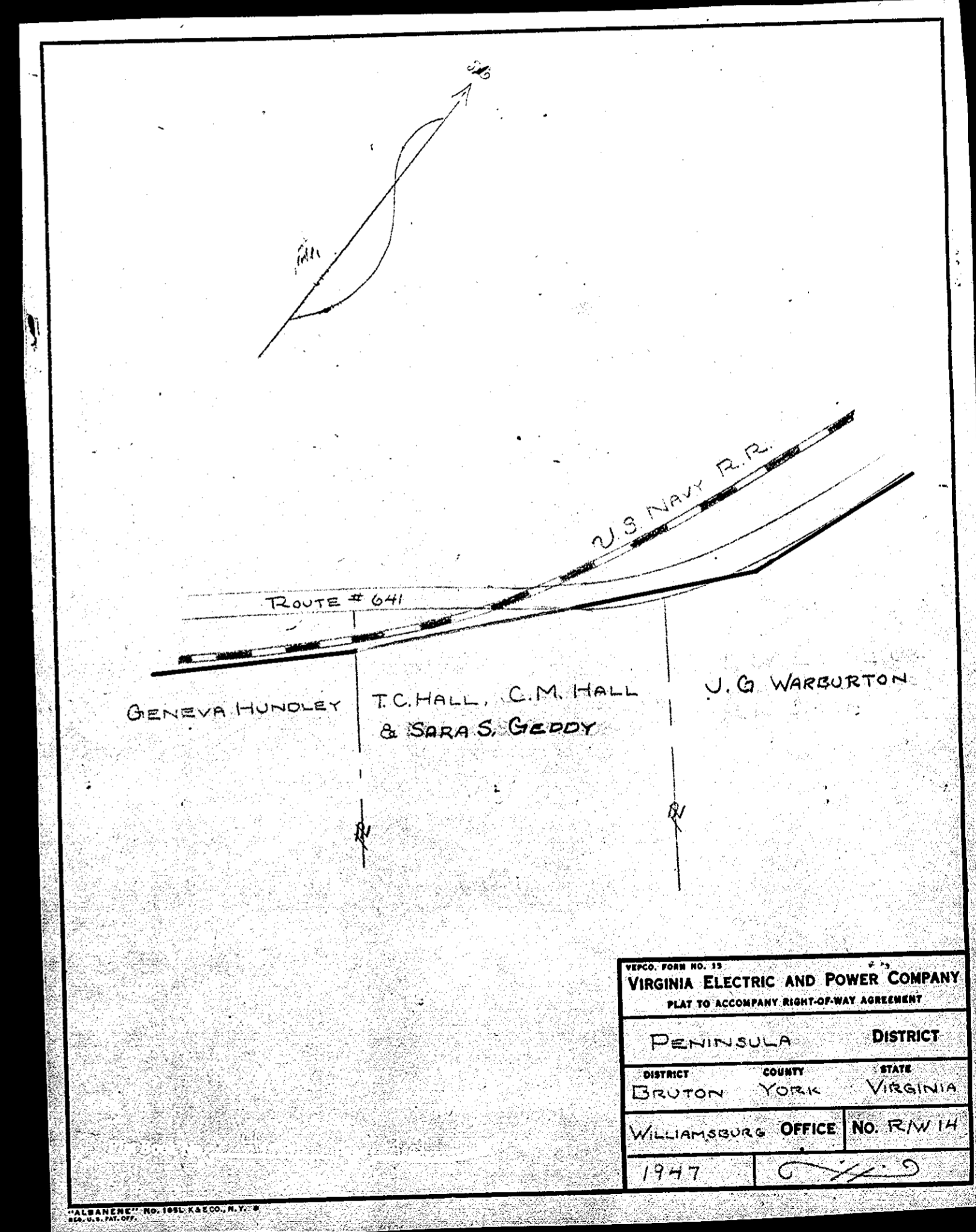

VERCO. FORM NO. 13
VIRGINIA ELECTRIC AND POWER COMPANY
 PLAT TO ACCOMPANY RIGHT-OF-WAY AGREEMENT

PENINSULA DISTRICT

DISTRICT COUNTY STATE
 BRUTON YORK VIRGINIA

WILLIAMSBURG OFFICE NO. RW 14
 1947 [Signature]