

THE UNDERSIGNED CERTIFIES THAT THIS PLAN IS ACCURATE AND COMPLIES WITH THE PROVISIONS OF THE CODE OF VIRGINIA SECTION 55-79.58 (b) AND ALL UNITS DEPICTED HEREON HAVE BEEN SUBSTANTIALLY COMPLETED.

NOTES

- 1. ALL BUILDING DIMENSIONS SHOWN HEREON ARE EXTERIOR DIMENSIONS AND ARE IN FEET.

SIGNED: Kenton B. Patrick DATE: 9/10/88
 KENTON B. PATRICK, P.E.



STATE OF VIRGINIA
 COUNTY OF YORK

IN THE CLERK'S OFFICE OF THE CIRCUIT COURT FOR THE COUNTY OF YORK THE 28th DAY OF October, 1988 THIS MAP WAS PRESENTED AND ADMITTED TO RECORD AS THE LAW DIRECTS IN PLAT BOOK 10, PAGE 601.

TESTE: EDITH M. ELLIOTT, CLERK
 CLERK

BY: Karen D. Kelly Watkins, DC

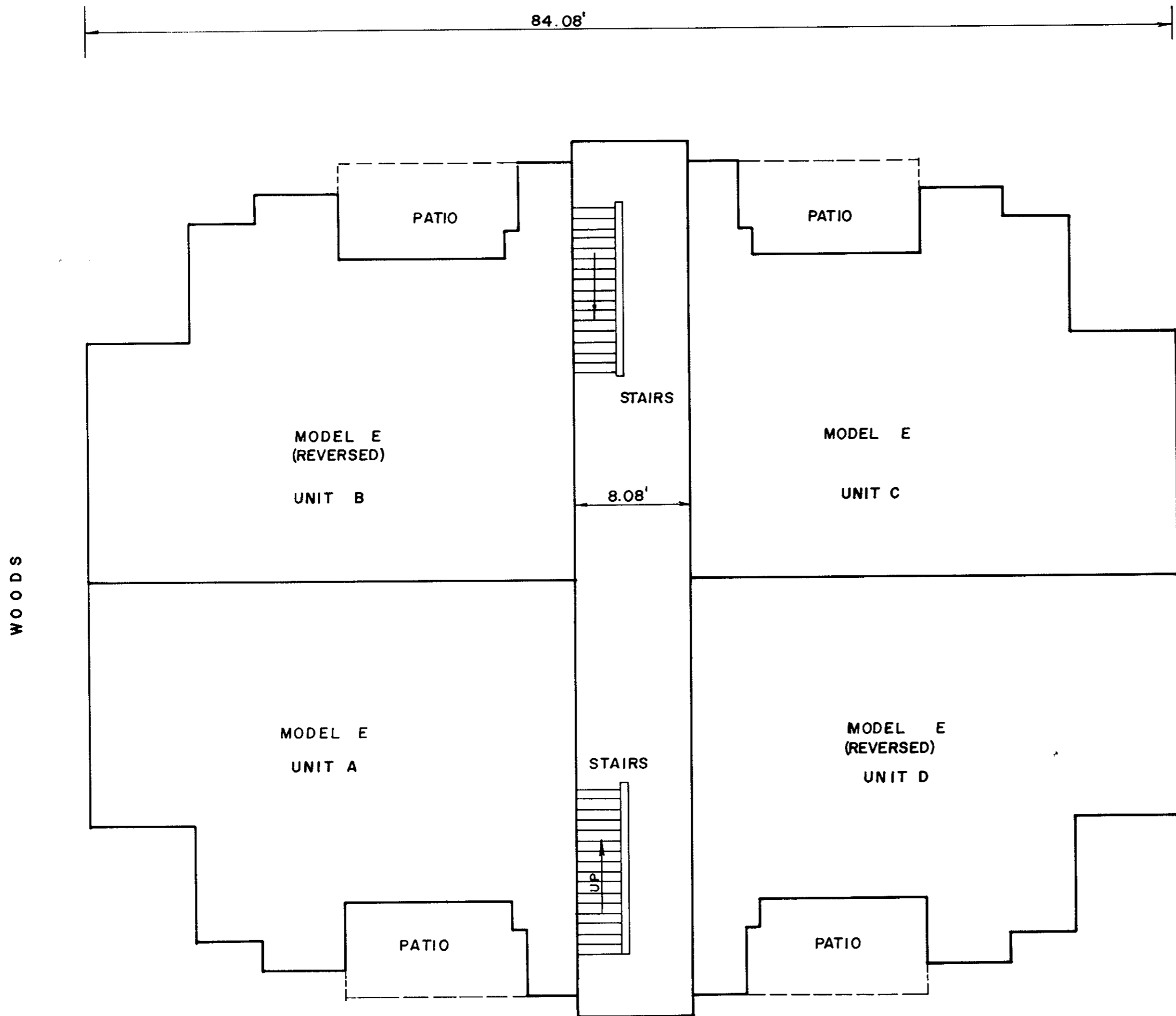
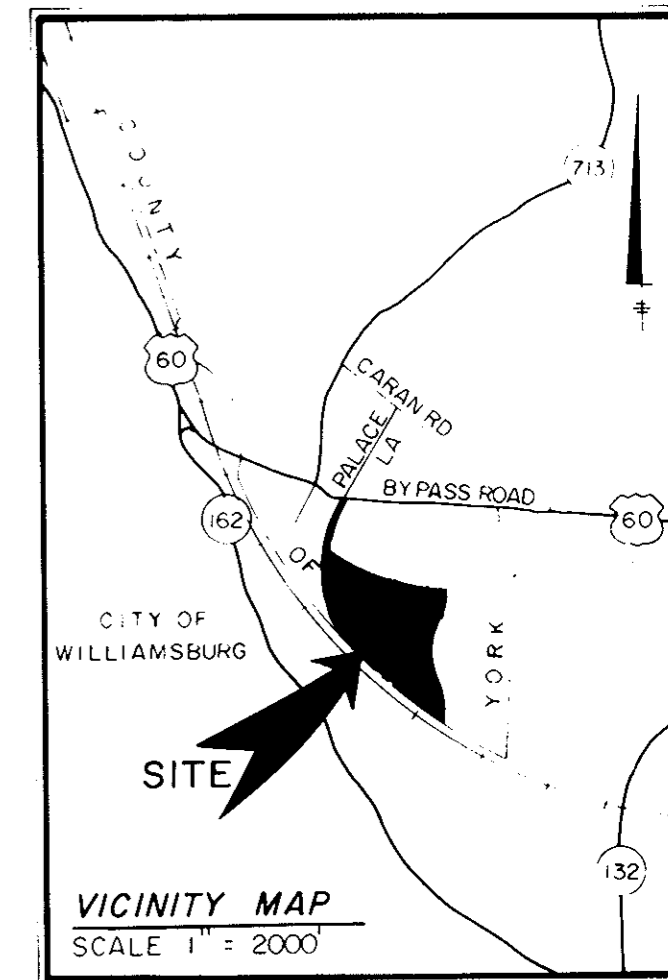

(FRONT)
 FIRST FLOOR
 BUILDING 16

64.17'
 PARKING LOT

Exhibit F
 PHASE V
 SHEET 3 OF 5
 PLAN OF
WILLIAMSBURG COMMONS CONDOMINIUMS
 FOR
WILLIAMSBURG COMMONS, INC.,
 A VIRGINIA CORPORATION
 BRUTON DISTRICT COUNTY OF YORK, VIRGINIA
 SCALE 1/8"=1'-0" JUNE 8, 1988

GRAPHIC SCALE
THE SIRINE GROUP, LTD.
 SURVEYORS • ENGINEERS • PLANNERS
 P O BOX 450, ROUTE 17
 WHITE MARSH, VIRGINIA
 23183