

Plat showing parcel of land situated near Ewell Station, Brydon District, York County, Virginia, by Amanda James, charged on Land book to Amanda James, Survey by Court Order Dated July 10, 1933. Scale 1" = 100'.

DB-48-89

5-31 : SEE UPDATE
 BY 5-33 DB 65-416

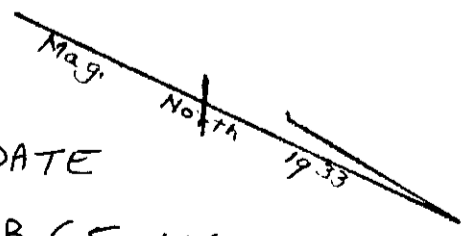

V. D. McManus
 Special Surveyor

5-33