

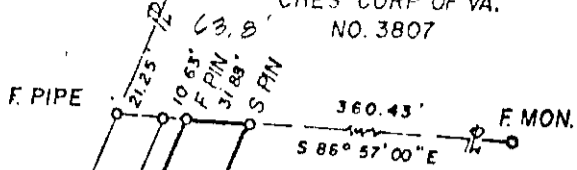

"DAVAULT"
CHES CORP OF VA.
NO. 3807



THE COLLEGE OF WILLIAM AND MARY

THE CHES. CORP OF VA.
N 22° 49' 38\"/>

EXISTING 20' R/W
10' R/W
1773.40' FROM
30' R/W
1770.34'

R. C. DAVALT

Handwritten calculations:
21.25
10.63
31.89

63.77

Tax Map 5 - 37

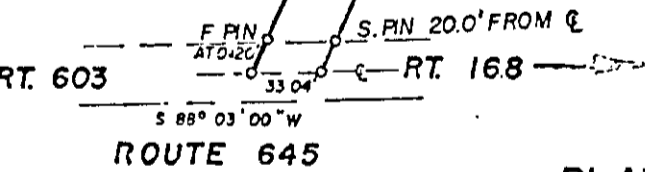
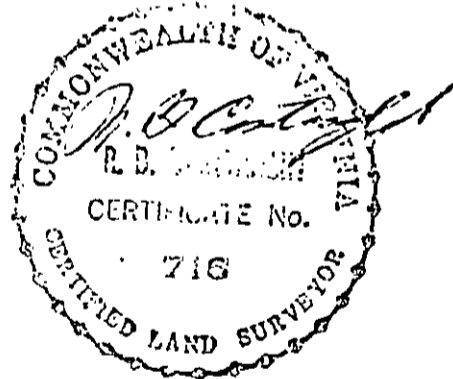

PLAT OF SURVEY
SHOWING A 30 FOOT RIGHT-OF-WAY
FOR CONVEYANCE BY
R. C. DAVALT

TO
THE CHESAPEAKE CORPORATION OF VIRGINIA
BRUTON DISTRICT
YORK COUNTY, VIRGINIA

SCALE: 1" = 100'
DECEMBER 11, 1975