

431-807

BOOK 431 PAGE 807

WORMLEY'S CREEK
MEAN LOW WATER IS PROPERTY LINE

2 pcs @
DB 00-107
ATTCHD
PARCEL A

N/F GEORGE E. MORSE

N.81 04'42"E. 192.53'

N.04 22'53"E. 20.02'

N.04 22'53"E. 110.24'

S.76 03'00"W. 189.90'

S.88 00'00"E. 50.00'

20' ROADWAY

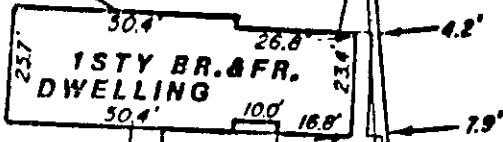

PARCEL B



**PLAT OF PROPERTY PREPARED FOR
THOMAS E. WILLIAMSON
& KATHERINE C. WILLIAMSON**

**PARCEL A
AS SHOWN ON
BOUNDARY LINE AGREEMENT PLAT
CHARLES H. RUTH C. HOGG
KENNETH C. & JUNE E. JAMESON
10000 COMMUNITY, VIRGINIA
40310 WORMLEY CREEK ROAD**

I, Robert C. Ackerman, hereby certify that the survey represented by this plat was made by me on this date and is correct to the best of my knowledge and belief.

Date: Dec. 4, 1985

1" = 40'

24-287