

SUFFOLK DISTRICT DESIGN UNIT

Power Poles Property of: Virginia Power 1800 Hamilton Ave. Portsmouth, VA 23707-3528

Telephone Poles Property of: Bell Atlantic - VA 5701 Cleveland Street, 5th Floor Virginia Beach, VA 23462

Water Lines Property of: Newport News Waterworks 2600 Washington Avenue 5th Floor Newport News, VA 23607

Gas Lines Property of: Virginia Natural Gas 3719 E. Virginia Beach Blvd. Norfolk, VA 23502

Sewer Lines Property of: HRSD P.O. Box 5000 Virginia Beach, VA 23455

TV Cable Lines Property of: Cox Communications 179 Louise Dr. Newport News, VA 23602

DESIGN FEATURES RELATING TO CONSTRUCTION OR TO REGULATION AND CONTROL OF TRAFFIC MAY BE SUBJECT TO CHANGE AS DEEMED NECESSARY BY THE DEPARTMENT.

REVISED	FILE	DATE	FEDERAL NO	ROUTE	STATE	SHEET
12-02-95						
12-20-95						
01-28-97						
03-26-97	3	VA		603	0603-099-127, M-501	3
04-28-97						
08-27-97						

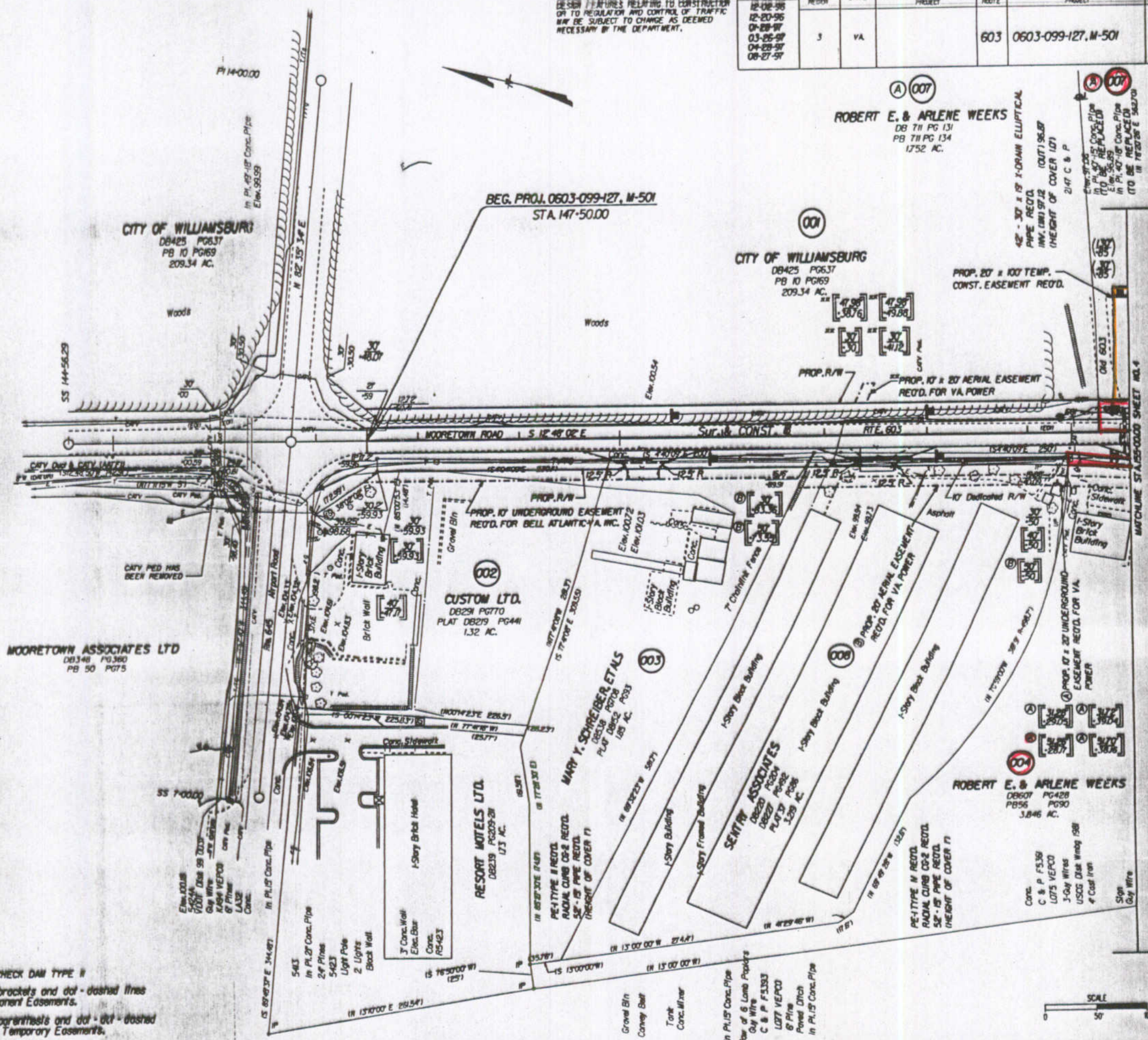

DESIGNED BY: E. B. HOLLOWELL  
CHECKED BY: J. G. WOODSON  
CADD OPERATOR: J. G. WOODSON  
REVISIONS BY:

NO.	DATE	DESCRIPTION

NOTE: CENTERLINE OF EXISTING ROUTE 603 IS YORK COUNTY AND JAMES CITY COUNTY LINE.

■ DENOTES ROCK CHECK DAM TYPE II  
Note: Figures in brackets and dot-dashed lines denote Permanent Easements.  
Note: Figures in parentheses and dot-dot-dashed lines denote Temporary Easements.

Bearings Based On Va. State Plane Coordinate System South Zone

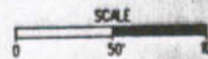

PLAN NO.	PROJECT	FILE NO.	SHEET NO.
A	0603-099-127		3