

PLAT INSTRUMENT # 030023805

REFERENCES:
DEED BOOK 300, PAGE 16
DEED BOOK 410, PAGE 720

VA. STATE GRID BASED ON
YORK COUNTY CONTROL MONUMENT #013

N 3,655,721.0188
E 11,996,011.4094

N/F
CLARICE MARIE L. SHERMAN
& ROBERT F. SHERMAN
T.M. #02-00-00-039
GPIN C20C-1236-0152
D.B. 219, PG. 763

NOTE:
THIS IS A PORTION OF THE PROPERTY
CONVEYED BY FRANCIS P. NORSWORTHY,
JR. ET UX TO THE COMMONWEALTH OF
VIRGINIA BY DEED DATED 12/29/1986
AND RECORDED IN DEED BOOK 465,
PAGE 279.

TOTAL AREA =
35,368 S.F.±
OR 0.812 AC.±

N/F
FRANCIS P. NORSWORTHY, JR.
& REBECCA M. NORSWORTHY
T.M. #02-00-00-036C
GPIN C20C-0586-0196
INSTR. #000022060
D.B. 829, PG. 799 (PLAT)
SHOWN AS PARCEL 1
ON SUBDIVISION PLAT PREPARED
BY AES CONSULTING ENGINEERS
DATED 10/16/2002

THE PROPERTY AS DEPICTED ON THIS PLAT
DOES NOT VIOLATE THE PROVISIONS OF THE
YORK COUNTY SUBDIVISION ORDINANCE

SIGNED: *[Signature]*
TITLE: Chief of Development & Compliance
DATE: 7/9/03

N/F
CLARICE MARIE L. SHERMAN
& ROBERT F. SHERMAN
T.M. #02-00-00-039
GPIN C20C-1236-0152
D.B. 219, PG. 763

COMMONWEALTH OF VA.
T.M. #02-00-00-037
GPIN: C20C-0873-0821
D.B. 465, PG. 279
HWY P.B. 5, PG. 157

COMMONWEALTH OF VA.
T.M. #02-00-00-038
GPIN: C20C-0897-0932
D.B. 465, PG. 279
HWY P.B. 5, PG. 157
HWY P.B. 6, PG. 73 (SHEET 29)

PROPERTY LINE PER
D.B. 410, PG. 718
& D.B. 430, PG. 822
N 3,655,793.4332
E 11,995,688.0939

THE FROM I.R.S.
R=3,644.72'
L=725.63'
TO I.R.F. @ P.C.
STA. 73+17.16

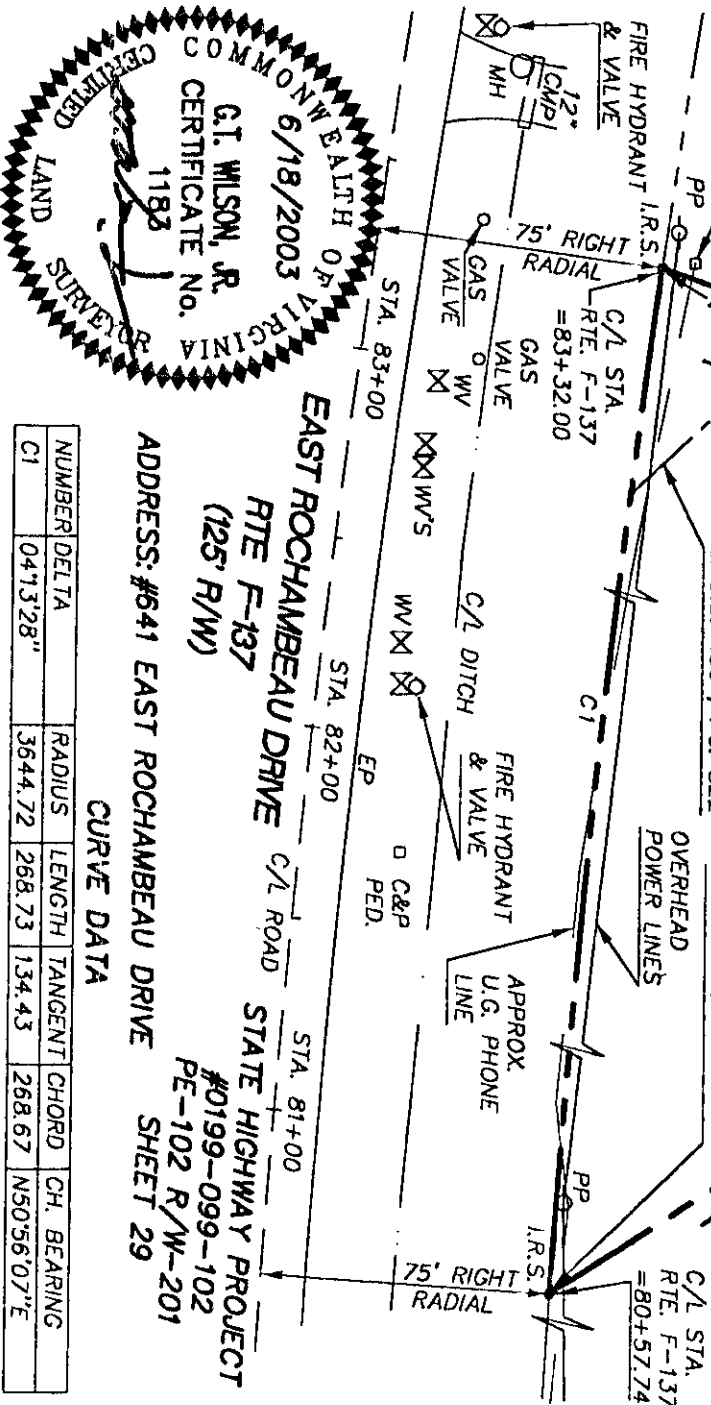

ADDRESS: #641 EAST ROCHAMBEAU DRIVE

CURVE DATA

NUMBER	DELTA	RADIUS	LENGTH	TANGENT	CHORD	CH. BEARING
C1	04°13'28"	3644.72	268.73	134.43	268.67	N50°56'07"E



Consulting Engineers
Engineers, Surveyors, Planners

5248 Olde Towne Road, Suite 1
Williamsburg, Virginia 23188
Ph. (757)-253-0040, Fax (757)-220-8994

PLAT OF SURVEY
A PARCEL CONTAINING 0.812 ACRES±
OWNED BY THE COMMONWEALTH OF VIRGINIA
FOR CONVEYANCE TO FRANCIS P. NORSWORTHY, JR. ET UX
YORK COUNTY VIRGINIA

Scale: 1"=50'

Ref: HYW. P.B. 5, PG. 157

Date: 6/18/2003

Job No: 9106-1

REVISED: 7/1/2003 PER V.D.O.T. COMMENTS

JKR

07.01.03-16:54 91061P02