

THESE PLANS ARE UNFINISHED AND ARE NOT TO BE USED FOR ANY TYPE OF CONSTRUCTION.

DESIGN FEATURES RELATING TO CONSTRUCTION OR TO REGULATION AND CONTROL OF TRAFFIC MAY BE SUBJECT TO CHANGE AS DEEMED NECESSARY BY THE DEPARTMENT

REVISION	FEDERAL AID PROJECT	ROUTE	STATE PROJECT	SHEET NO.
		620	0620-099-176, C-501	6

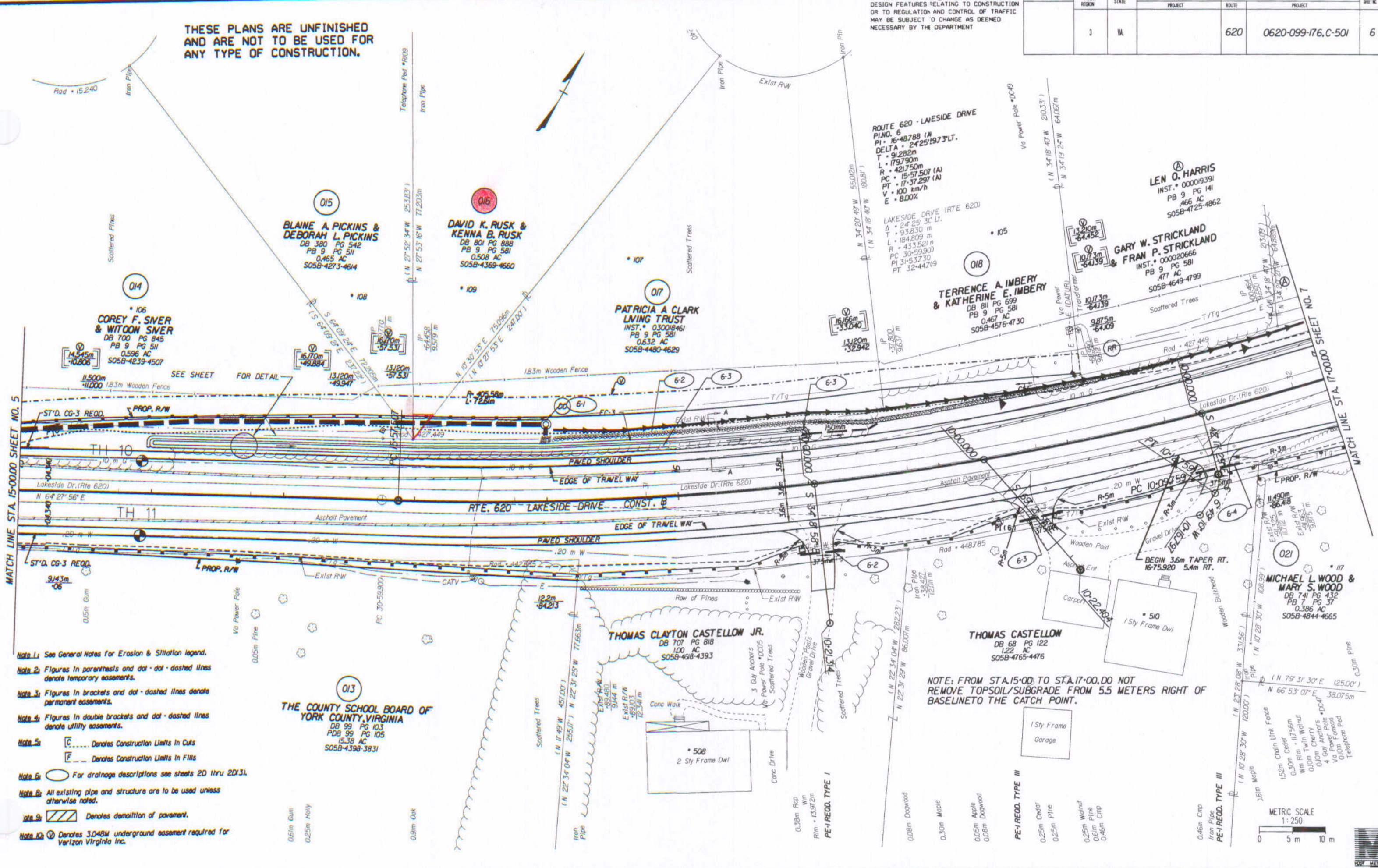

- Note 1: See General Notes for Erosion & Siltation legend.
- Note 2: Figures in parentheses and dot-dot-dashed lines denote temporary easements.
- Note 3: Figures in brackets and dot-dashed lines denote permanent easements.
- Note 4: Figures in double brackets and dot-dashed lines denote utility easements.
- Note 5: [C] Denotes Construction Units in Cuts; [F] Denotes Construction Units in Fills.
- Note 6: [O] For drainage descriptions see sheets 2D thru 2Dx31.
- Note 7: All existing pipe and structure are to be used unless otherwise noted.
- Note 8: [X] Denotes demolition of pavement.
- Note 9: [V] Denotes 3.048M underground easement required for Verizon Virginia Inc.

NOTE: FROM STA. 15+00 TO STA. 17+00, DO NOT REMOVE TOPSOIL/SUBGRADE FROM 5.5 METERS RIGHT OF BASELINE TO THE CATCH POINT.

