

EXHIBIT "C"

PLAT OF VILLAS ON SHADY BANKS A CONDOMINIUM PHASE V

(PROP. REF.: D.B. 54, P.107; D.B. 968, PGS.532-550) (INSTR. #050004843; INSTR. #030021817) SHEET 2 OF 4

BETHEL DISTRICT - COUNTY OF YORK, VIRGINIA

SCALE: 1" = 100' AUGUST 5, 2005

50 100 200 300 400 FEET

GRAPHIC SCALE

THE SIRINE GROUP, LTD.

SURVEYORS • ENGINEERS • PLANNERS 4794 GEORGE WASHINGTON MEMORIAL HIGHWAY P.O. BOX 450, U.S. ROUTE 17 WHITE MARSH, VIRGINIA 23183 (804) 693-9548

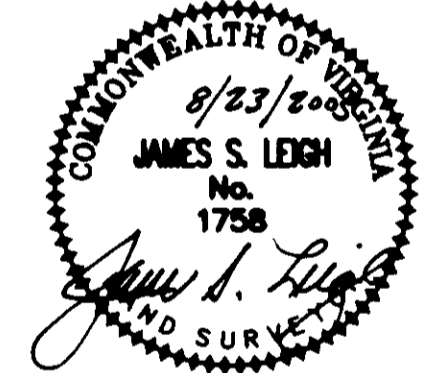
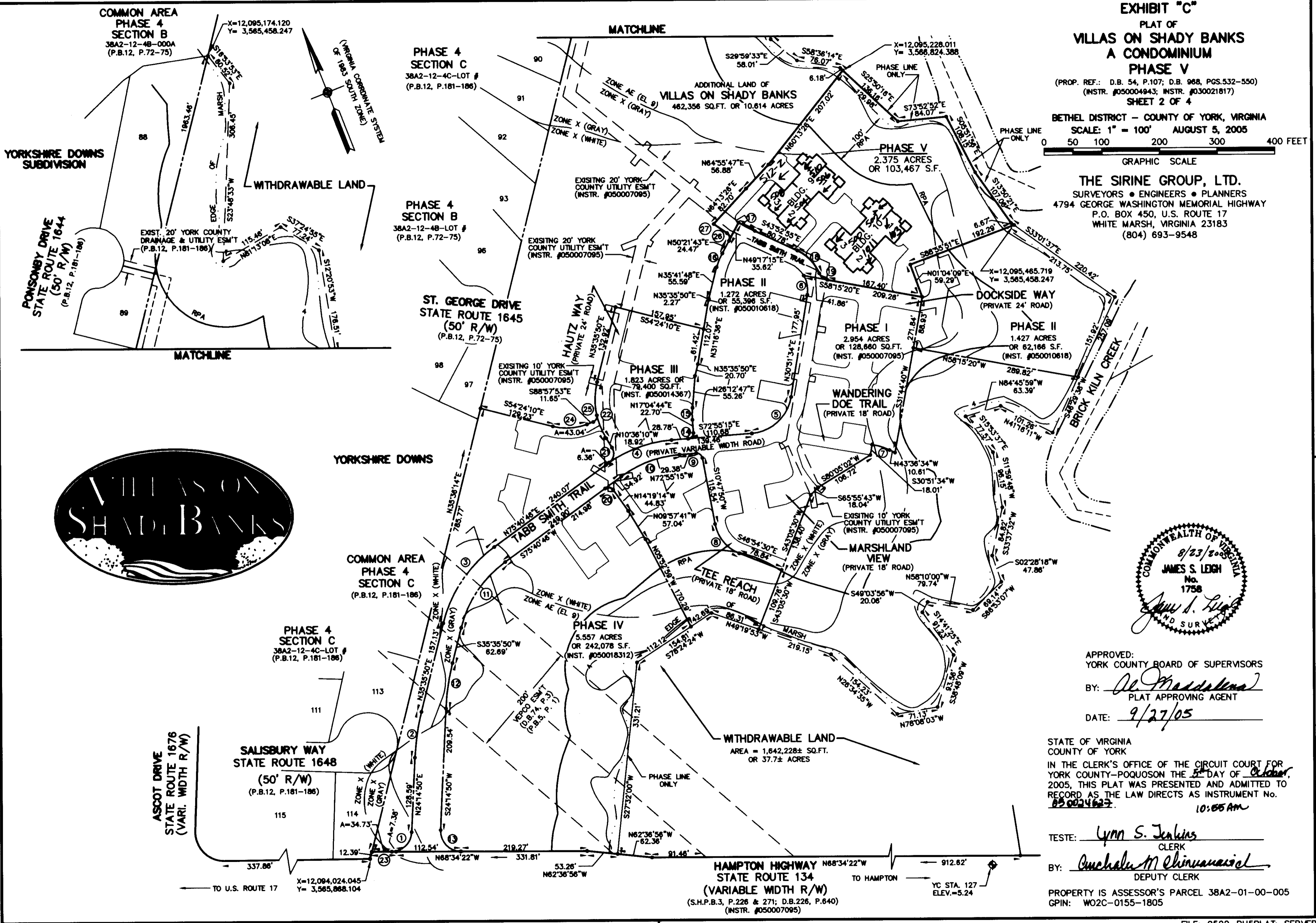

APPROVED: YORK COUNTY BOARD OF SUPERVISORS
BY: *De. Maddalena*
PLAT APPROVING AGENT
DATE: 9/27/05

STATE OF VIRGINIA
COUNTY OF YORK
IN THE CLERK'S OFFICE OF THE CIRCUIT COURT FOR YORK COUNTY-POQUOSON THE 5th DAY of October, 2005, THIS PLAT WAS PRESENTED AND ADMITTED TO RECORD AS THE LAW DIRECTS AS INSTRUMENT NO. 050004843 10:05 AM

TESTE: *Lynn S. Jenkins*
CLERK
BY: *Amelia M. Chirvanevic*
DEPUTY CLERK

PROPERTY IS ASSESSOR'S PARCEL 38A2-01-00-005
GPIN: WO2C-0155-1805