

HAMPTON ROADS DISTRICT DESIGN UNIT

- Note 1: See General Notes for Erosion & Siltation legend.
- Note 2: Figures in parenthesis and dot-dash lines denote temporary easements.
- Note 3: Figures in brackets and dot-dashed lines denote permanent easements.
- Note 4: Figures in double brackets and dot-dashed lines denote utility easements.
- Note 5: [C] Denotes Construction Limits In Cuts  
[E] Denotes Construction Limits In Fills
- Note 6: [O] For drainage descriptions see sheets 2D thru 2D(3).
- Note 7: All existing pipe and structure are to be used unless otherwise noted.
- Note 8: Pavement markings shown on this plan sheet are for schematic purposes only. See sheet [ ] for typical pavement markings for bicycle lanes.
- Note 9: [X] Denotes demolition of pavement.
- Note 10: Suitable transition to existing pavement to be provided if found necessary as directed by the engineer.

Note 11: [V] Denotes 3D48W easement required for Verizon Virginia Inc.

Note 12: [ ]

DESIGN FEATURES RELATING TO CONSTRUCTION OR TO REGULATION AND CONTROL OF TRAFFIC MAY BE SUBJECT TO CHANGE AS DEEMED NECESSARY BY THE DEPARTMENT

FEDERAL AID PROJECT	ROUTE	STATE PROJECT	STATE PROJECT	MILE
	620	0620-099-176, RW-201 C-501		5

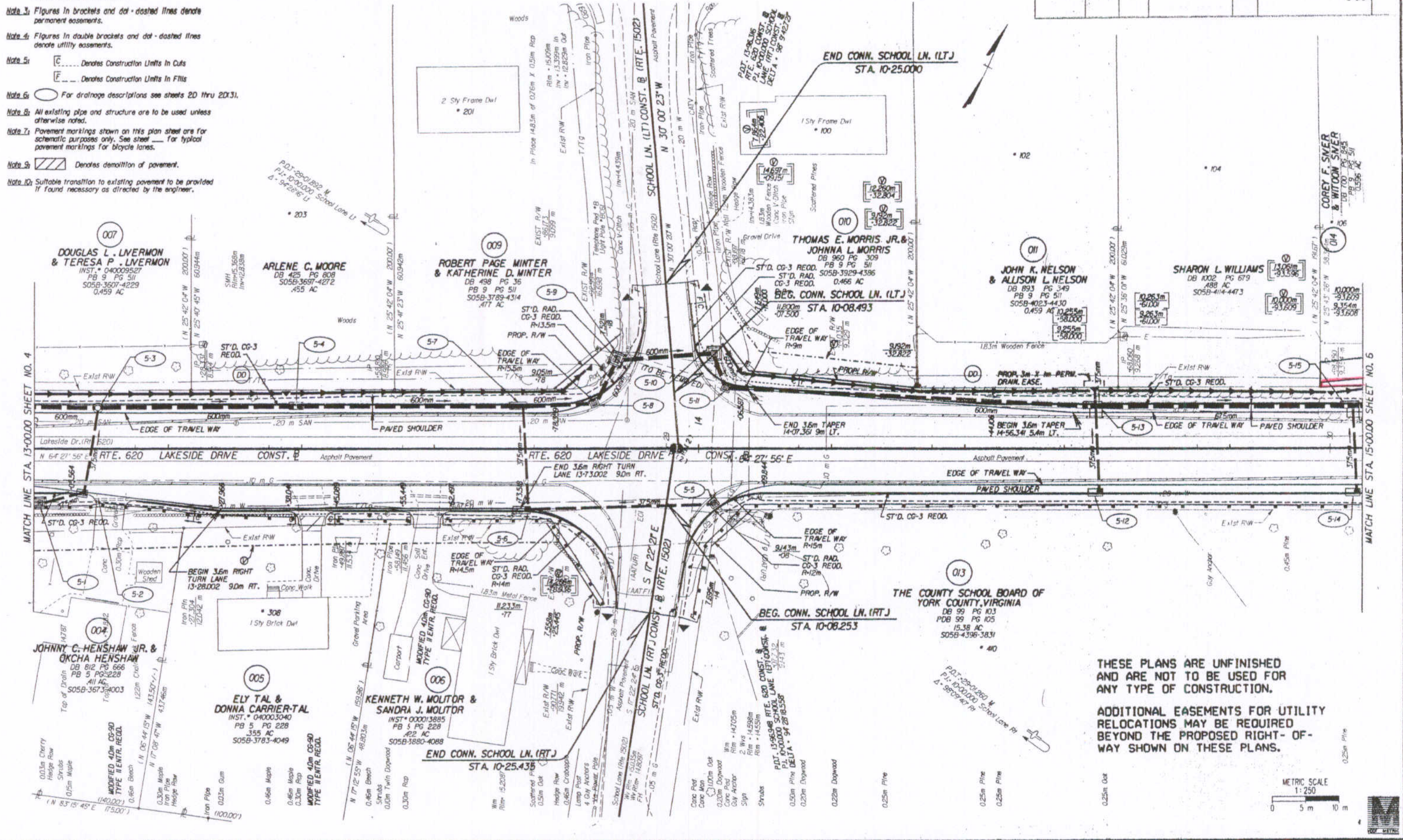

SURVEYED BY: D. B. MORRIS, 07/09/05 882Z  
 SUPERVISED BY: CHERYL STANWIS, 07/18/05 360B  
 DESIGNED BY: LEE CULBERTSON, 07/18/05 3500  
 CAD OPERATOR: CHERYL STANWIS, 07/18/05 3500  
 REVISIONS BY: [ ]

THESE PLANS ARE UNFINISHED AND ARE NOT TO BE USED FOR ANY TYPE OF CONSTRUCTION.

ADDITIONAL EASEMENTS FOR UTILITY RELOCATIONS MAY BE REQUIRED BEYOND THE PROPOSED RIGHT-OF-WAY SHOWN ON THESE PLANS.

