

HAMPTON ROADS DISTRICT SIGN UNIT

- Note 1:** See General Notes for Erosion & Siltation legend.
- Note 2:** Figures in parenthesis and dot-dot-dashed lines denote temporary easements.
- Note 3:** Figures in brackets and dot-dashed lines denote permanent easements.
- Note 4:** Figures in double brackets and dot-dashed lines denote utility easements.
- Note 5:** [C]..... Denotes Construction Limits In Cuts  
[F]..... Denotes Construction Limits In Fills
- Note 6:** [O] For drainage descriptions see sheets 2D thru 2D(3).
- Note 7:** All existing pipe and structure are to be used unless otherwise noted.
- Note 8:** Pavement markings shown on this plan sheet are for schematic purposes only. See sheet [ ] for typical pavement markings for bicycle lanes.
- Note 9:** [X] Denotes demolition of pavement.
- Note 10:** Suitable transition to existing pavement to be provided if found necessary as directed by the engineer.

**Note 11:** [V] Denotes 3.048M easement required for Verizon Virginia Inc.

**Note 12:** [ ]

DESIGN FEATURES RELATING TO CONSTRUCTION OR TO REGULATION AND CONTROL OF TRAFFIC MAY BE SUBJECT TO CHANGE AS DEEMED NECESSARY BY THE DEPARTMENT

ROUTE	STATE	FEDERAL AID PROJECT	ROUTE	STATE	PROJECT	SHEET NO.
620	VA		620	VA	0620-099-176, RW-201 C-501	5

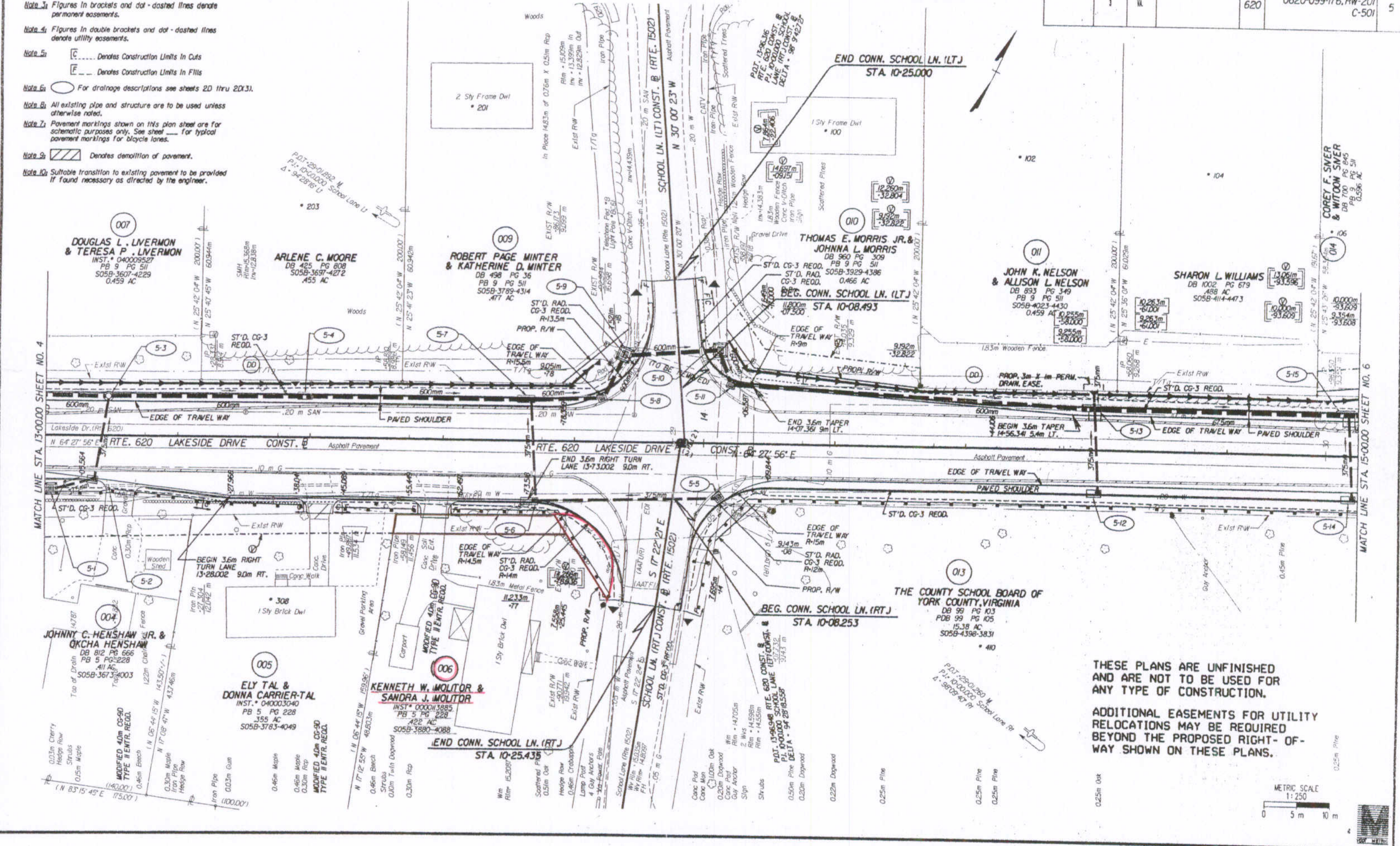

THESE PLANS ARE UNFINISHED AND ARE NOT TO BE USED FOR ANY TYPE OF CONSTRUCTION.

ADDITIONAL EASEMENTS FOR UTILITY RELOCATIONS MAY BE REQUIRED BEYOND THE PROPOSED RIGHT-OF-WAY SHOWN ON THESE PLANS.

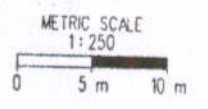

State Highway 620 Plat Book No. 9 Page 170

SURVEYED BY: D. B. HARRIS (07/28/05) 0857  
 SUPERVISED BY: GENERAL SURVEYORS (07/28/05) 3626  
 DESIGNED BY: J. LEE (09/08/05) 0598 (07/28/05) 3592  
 CAD OPERATOR: JASON W. HARRIS (07/28/05) 0598  
 REVISED BY: