

SURVEYED BY: BOB HARRISON (151/253-5137)  
 SUPERVISED BY: E.H. BYNUM (751/925-2557)  
 DESIGNED BY: J.D. WINSTEAD (751/925-2556)  
 HAMPTON ROADS DISTRICT DESIGN UNIT

State Highway 9  
 Plat Book No. 9 Page 873  
 Instr# LR060027910

REFERENCES  
 (PROFILES, DETAIL & DRAINAGE DESCRIPTION SHEETS, ETC.)

MAINLINE PROFILES	12A
ENTRANCE PROFILES	24D
DRAINAGE DESC.	2H11-2H71
CROSS-OVER DETAIL	2E

DESIGN FEATURES RELATING TO CONSTRUCTION OR TO REGULATION AND CONTROL OF TRAFFIC MAY BE SUBJECT TO CHANGE AS DEEMED NECESSARY BY THE DEPARTMENT

REVISED	STATE	FEDERAL AID PROJECT	ROUTE	STATE PROJECT	SHEET NO.
12/09/05 02/06/06 06/08/06 08/08/06	VA.		17	6017-099-129, RW-201, C-501	12

THESE PLANS ARE UNFINISHED AND ARE NOT TO BE USED FOR ANY TYPE OF CONSTRUCTION.

MATCHLINE STATION 68+00 SHEET NO. 11

MATCHLINE STATION 75+00 SHEET NO. 13

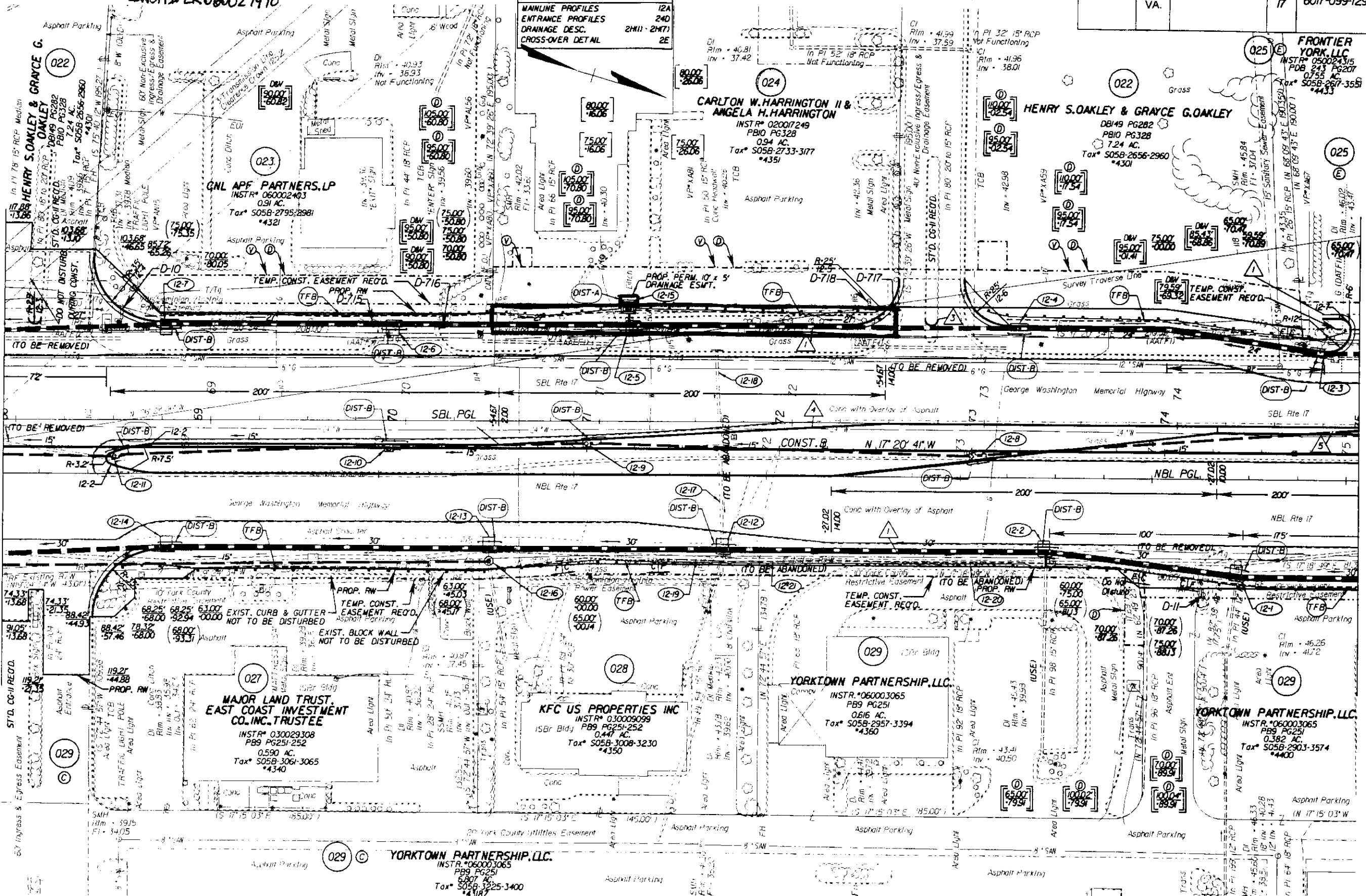

Note: Figures in brackets and dot-dashed lines denote Permanent Easements.  
 V Denotes variable easement required for Verizon Virginia  
 D Denotes variable easement required for Dominion Virginia Power

Note: Figures in parenthesis and dot-dot-dashed lines denote Temporary Easements.

- ⓐ Denotes Construction Limits in Cuts
- ⓑ Denotes Construction Limits in Fills
- Ⓐ ST'D. CG-7 REQ'D.
- ⓐ ST'D. MS-2 REQ'D.
- ⓓ ST'D. CG-2 REQ'D.
- ⓑ ST'D. MS-1A REQ'D.

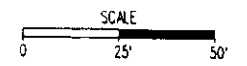

PLAN NO.	PROJECT	FILE NO.	SHEET NO.
	6017-099-129		12