

THESE PLANS ARE UNFINISHED AND ARE NOT TO BE USED FOR ANY TYPE OF CONSTRUCTION.

DESIGN FEATURES RELATING TO CONSTRUCTION OR TO REGULATION AND CONTROL OF TRAFFIC MAY BE SUBJECT TO CHANGE AS DEEMED NECESSARY BY THE DEPARTMENT

REVISED	STATE	FEDERAL AID PROJECT	ROUTE	STATE PROJECT	SHEET NO.
12/09/05 02/06/06 03/23/06 06/08/06	VA.		17	6017-099-129, RW-201, C-501	13

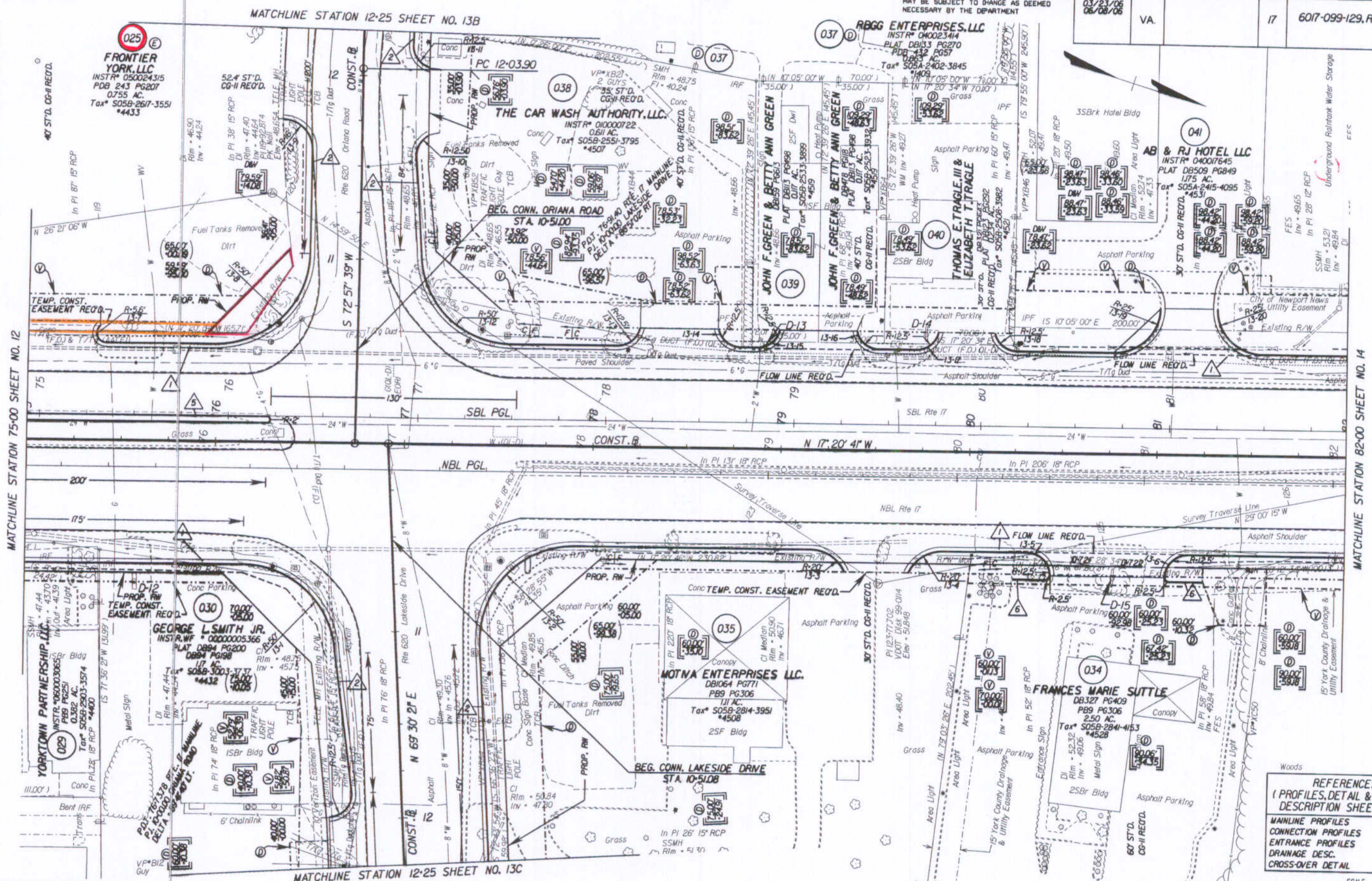

REFERENCES
 (PROFILES, DETAIL & DRAINAGE DESCRIPTION SHEETS, ETC.)

MAINLINE PROFILES	13A
CONNECTION PROFILES	13D
ENTRANCE PROFILES	24D, E, I, J
DRAINAGE DESC.	2H(1) - 2H(7)
CROSS-OVER DETAIL	2E

NOTE: PGL DENOTES PROFILE GRADE LINE
 NOTE: SEE GENERAL NOTES FOR E&S LEGEND
 ○ DENOTES DRAINAGE STRUCTURE NUMBER

Note: Figures in brackets and dot-dashed lines denote Permanent Easements.
 (V) Denotes variable easement required for Verizon Virginia
 (D) Denotes variable easement required for Dominion Virginia Power

Note: Figures in parenthesis and dot-dot-dashed lines denote Temporary Easements.

- C --- Denotes Construction Limits In Cuts
- F --- Denotes Construction Limits In Fills
- 1 ST'D. CG-7 REQ'D.
- 2 ST'D. CG-6 REQ'D.
- 5 ST'D. MS-1A REQ'D.
- 6 ST'D. CG-3 REQ'D.

State Highway Plat Book No. 9 Page 322
 CR070002894

PLAN NO.	PROJECT	FILE NO.	SHEET NO.
	6017-099-129		13