

SURVEYED BY: BOB HARMON (757) 253-5137
 SUPERVISED BY: P.J. BYRUM (757) 925-2557
 DESIGNED BY: M.D. WINSTEAD (757) 925-2556
 HAMPTON ROADS DISTRICT DESIGN UNIT

THESE PLANS ARE UNFINISHED AND ARE NOT TO BE USED FOR ANY TYPE OF CONSTRUCTION.

DESIGN FEATURES RELATING TO CONSTRUCTION OR TO REGULATION AND CONTROL OF TRAFFIC MAY BE SUBJECT TO CHANGE AS DEEMED NECESSARY BY THE DEPARTMENT

REVISED 12/09/05 02/06/06	STATE VA.	FEDERAL AID PROJECT	ROUTE 17	STATE PROJECT 6017-099-129, RW-201, C-501	SHEET NO. 8
---------------------------------	--------------	------------------------	-------------	---	----------------

REFERENCES
(PROFILES, DETAIL & DRAINAGE DESCRIPTION SHEETS, ETC.)

MAINLINE PROFILES	8A
CONNECTION PROFILES	8B
ENTRANCE PROFILES	24B
DRAINAGE DESC.	24(H) - 24(I)

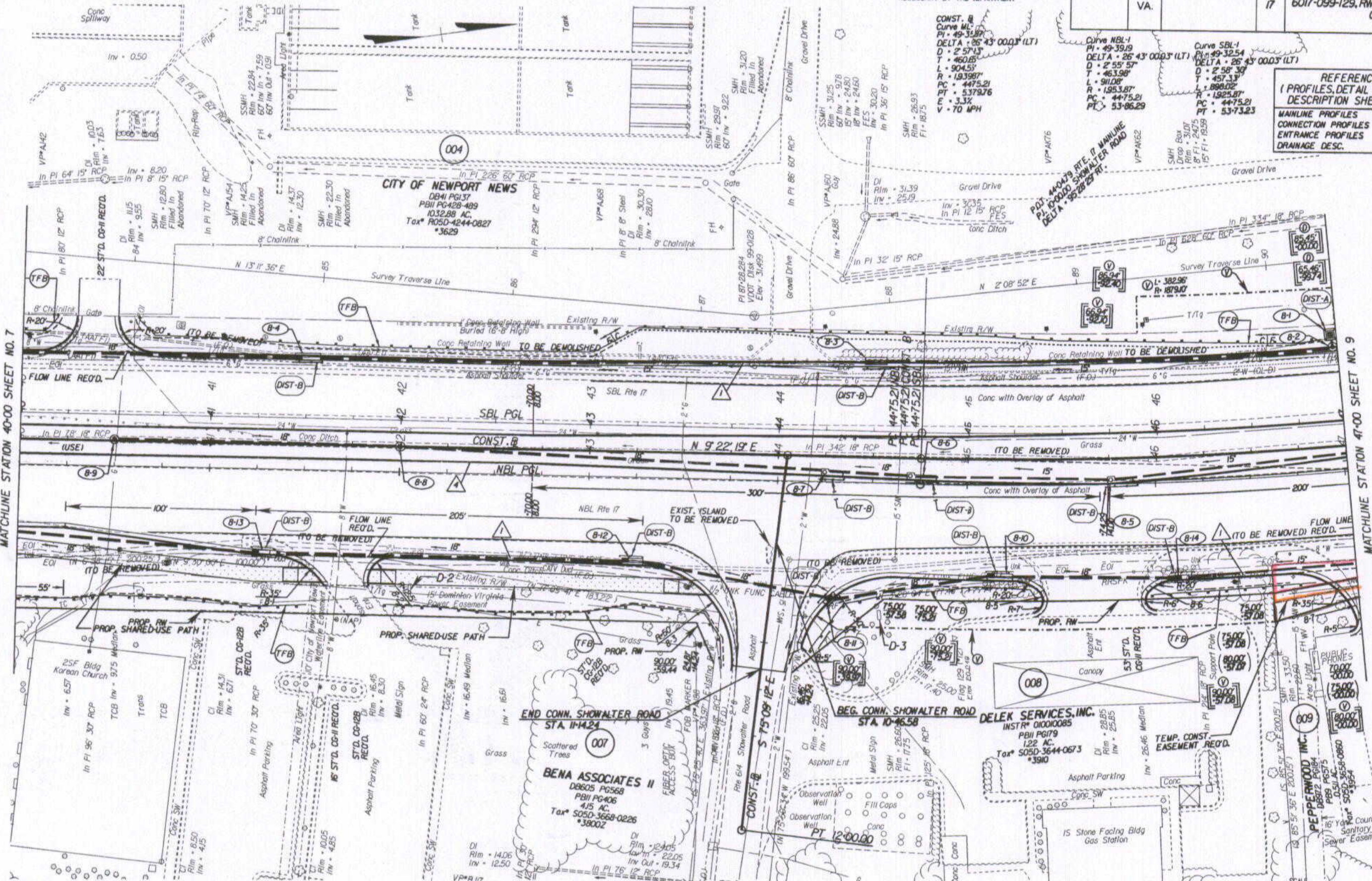

NOTE: PGL DENOTES PROFILE GRADE LINE
 NOTE: SEE GENERAL NOTES FOR E&S LEGEND
 Note: Figures in brackets and dot-dashed lines denote Permanent Easements.
 Note: Figures in parenthesis and dot-dashed lines denote Temporary Easements.
 Note: Figures in brackets and dot-dashed lines denote Permanent Easements.
 Note: Figures in parenthesis and dot-dashed lines denote Temporary Easements.

PLAN NO.	PROJECT	FILE NO.	SHEET NO.
	6017-099-129		8

State Highway Flat Book No. 10 Page 16 doc # 070004609