

SURVEYED BY: BOB HARMON (757) 253-5137
 SUPERVISED BY: P.H. BYNUM (757) 925-2557
 DESIGNED BY: M.D. WINSTEAD (757) 925-2556
 HAMPTON ROADS DISTRICT DESIGN UNIT

DESIGN FEATURES RELATING TO CONSTRUCTION OR TO REGULATION AND CONTROL OF TRAFFIC MAY BE SUBJECT TO CHANGE AS DEEMED NECESSARY BY THE DEPARTMENT

REVISED 03/23/06	STATE VA	FEDERAL AID PROJECT	ROUTE 17	STATE PROJECT 6017-099-129, RW-201, C-501	SHEET NO. 21
---------------------	-------------	------------------------	-------------	--	-----------------

THESE PLANS ARE UNFINISHED AND ARE NOT TO BE USED FOR ANY TYPE OF CONSTRUCTION.

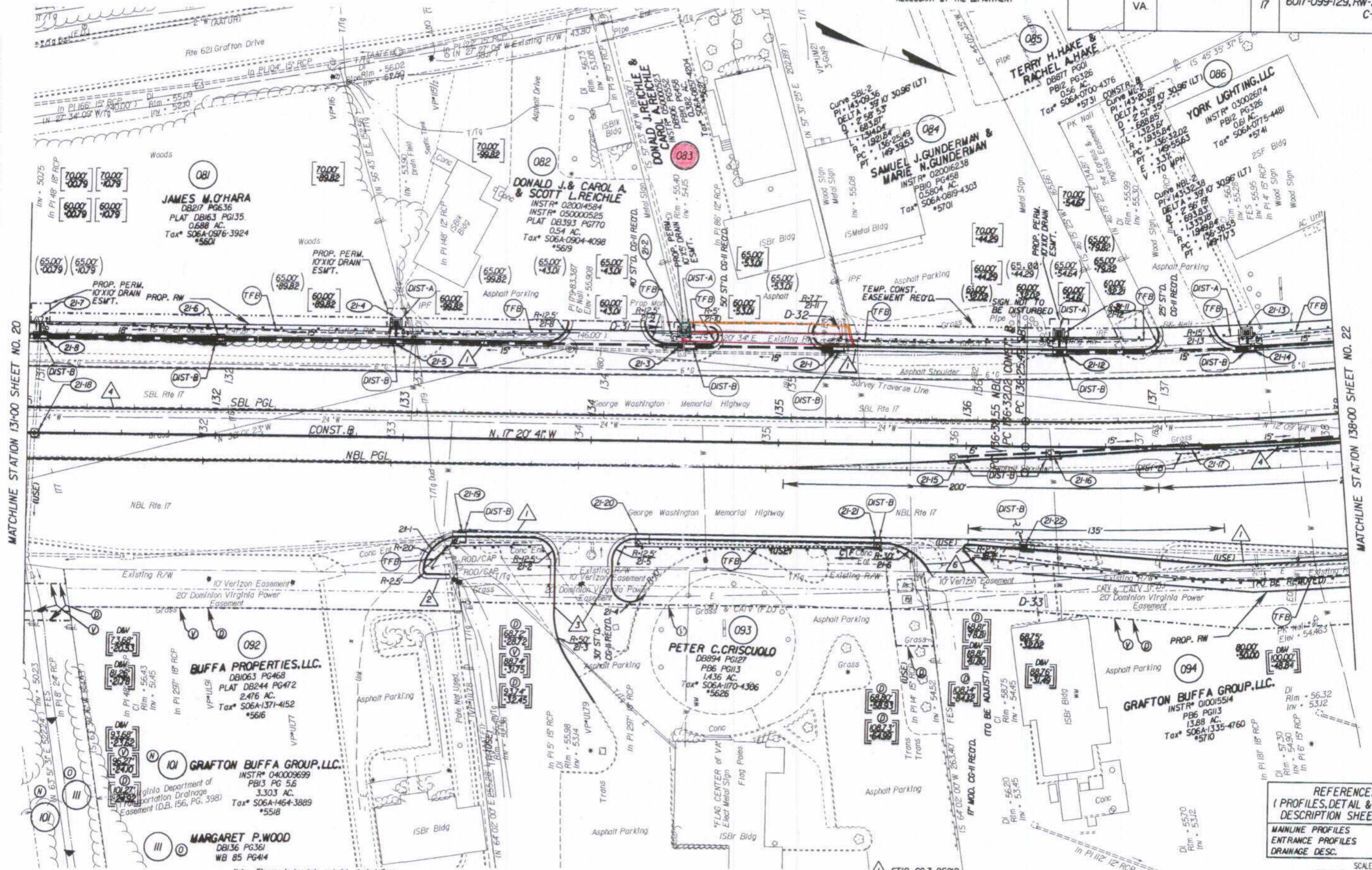

MATCHLINE STATION 13+00 SHEET NO. 20

MATCHLINE STATION 138+00 SHEET NO. 22

State Hwy Plat Book No. 10
 LR070012434
 93

NOTE: PGL DENOTES PROFILE GRADE LINE
 NOTE: SEE GENERAL NOTES FOR E&S LEGEND
 ○ DENOTES DRAINAGE STRUCTURE NUMBER

Note: Figures in brackets and dot-dashed lines denote Permanent Easements.
 V Denotes variable easement required for Verizon-Virginia
 D Denotes variable easement required for Dominion Virginia Power

Note: Figures in parenthesis and dot-dashed lines denote Temporary Easements.

E Denotes Construction Limits In Cuts
 F Denotes Construction Limits In Fills

1 ST'D. CG-7 REQ'D.
 2 ST'D. CG-6 REQ'D.
 3 ST'D. CG-2 REQ'D.
 4 ST'D. WS-2 REQ'D.
 6 ST'D. CG-3 REQ'D.

REFERENCES
 (PROFILES, DETAIL & DRAINAGE DESCRIPTION SHEETS, ETC.)

MAINLINE PROFILES	21A
ENTRANCE PROFILES	24H
DRAINAGE DESC.	2H(1) - 2H(7)

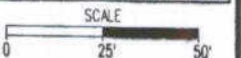

PLAN NO.	PROJECT 6017-099-129	FILE NO.	SHEET NO. 21
----------	-------------------------	----------	-----------------