

SURVEYED BY: BOB HASKIN (757) 253-5137  
 SUPERVISED BY: P.H. BYNUM (757) 925-2557  
 DESIGNED BY: J.D. WINSTEAD (757) 925-2556  
 HAMPTON ROADS DISTRICT DESIGN UNIT

**PAGE 2**

THESE PLANS ARE ISSUED FOR CONSTRUCTION AND ARE NOT TO BE USED FOR ANY TYPE OF CONSTRUCTION.

DESIGN FEATURES RELATING TO CONSTRUCTION OR TO REGULATION AND CONTROL OF TRAFFIC MAY BE SUBJECT TO CHANGE AS DEEMED NECESSARY BY THE DEPARTMENT

REVISED	STATE	FEDERAL AID PROJECT	ROUTE	STATE PROJECT	SHEET NO.
12/09/05 02/06/06 03/23/06	VA.		17	6017-099-129, RW-201, C-501	9

REFERENCES (PROFILES, DETAIL & DRAINAGE DESCRIPTION SHEETS, ETC.)

MAINLINE PROFILES	9A
CONNECTION PROFILES	9C
ENTRANCE PROFILES	24B, C, I
DRAINAGE DESC.	24H, I, 24K
CROSS-OVER DETAIL	2E

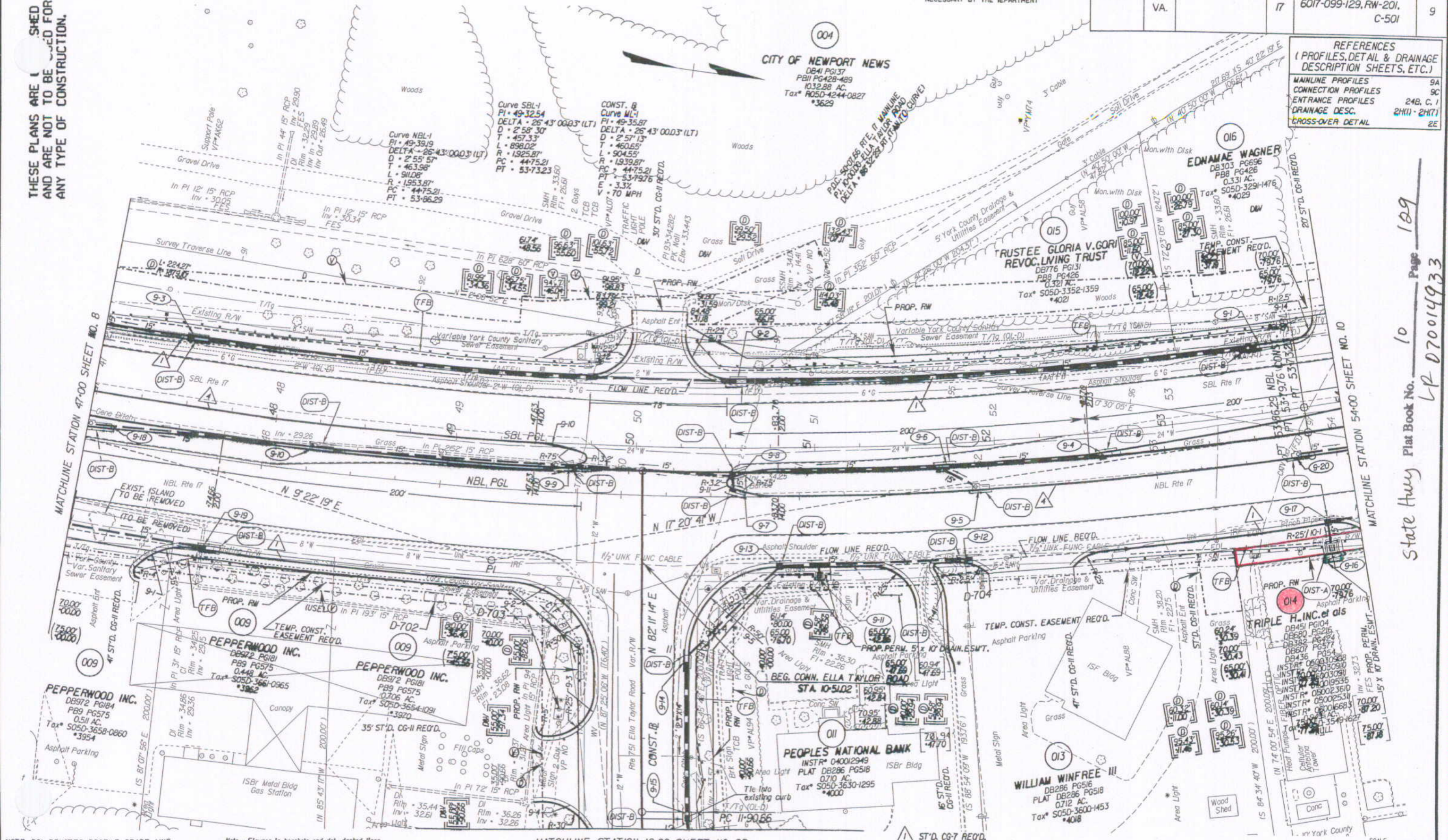

NOTE: PGL DENOTES PROFILE GRADE LINE  
 NOTE: SEE GENERAL NOTES FOR E&S LEGEND  
 ○ DENOTES DRAINAGE STRUCTURE NUMBER

Note: Figures in brackets and dot-dashed lines denote Permanent Easements.  
 V Denotes variable easement required for Verizon Virginia  
 D Denotes variable easement required for Dominion Virginia Power

Note: Figures in parenthesis and dot-dot-dashed lines denote Temporary Easements.

Legend:  
 [ ] Denotes Construction Limits In Cuts  
 [ ] Denotes Construction Limits In Fills

Legend:  
 1 ST'D. CG-7 REQ'D.  
 4 ST'D. MS-2 REQ'D.  
 6 ST'D. CG-3 REQ'D.

PLAN NO.	PROJECT	FILE NO.	SHEET NO.
	6017-099-129		9

State Hwy Plat Book No. 10 Page 189  
 LP 070014933