

|   |              |                        |             |   |                 |
|---|--------------|------------------------|-------------|---|-----------------|
| REVISED<br>12/09/05<br>02/05/06<br>05/23/07 | STATE<br>VA. | FEDERAL AID<br>PROJECT | ROUTE<br>17 | STATE<br>PROJECT<br>6017-099-129, RW-201, C-501 | SHEET NO.<br>14 |
|---|--------------|------------------------|-------------|---|-----------------|

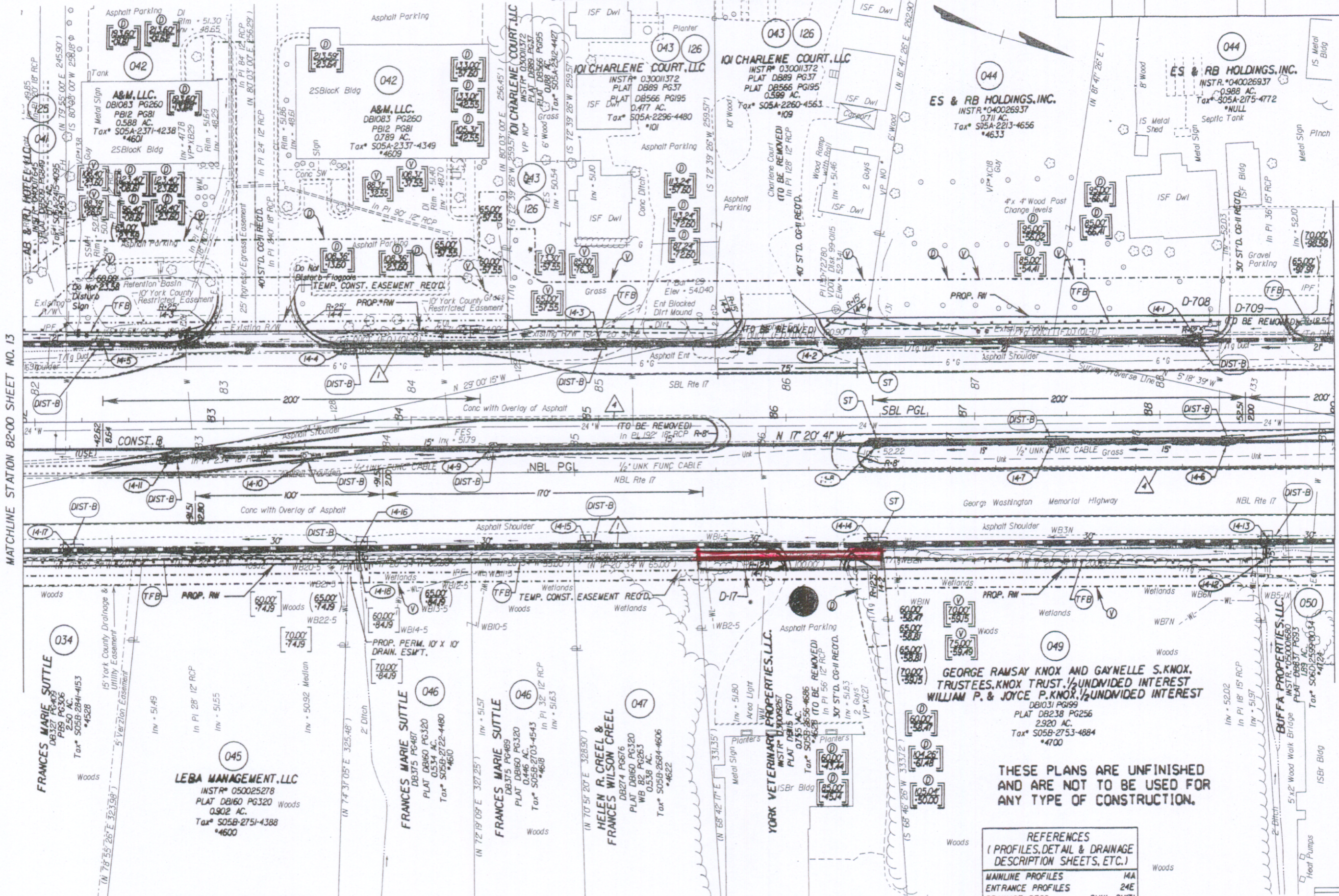

MATCHLINE STATION 82+00 SHEET NO. 13

MATCHLINE STATION 89+00 SHEET NO. 15

THESE PLANS ARE UNFINISHED AND ARE NOT TO BE USED FOR ANY TYPE OF CONSTRUCTION.

| REFERENCES<br>(PROFILES, DETAIL & DRAINAGE DESCRIPTION SHEETS, ETC.) |               |
|--|---------------|
| MAINLINE PROFILES  | 14A           |
| ENTRANCE PROFILES  | 24E           |
| DRAINAGE DESC.   | 2(H1) - 2(H7) |
| CROSS-OVER DETAIL  | 2E            |

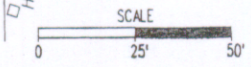

TE: PGL DENOTES PROFILE GRADE LINE  
TE: SEE GENERAL NOTES FOR E&S LEGEND  
DENOTES DRAINAGE STRUCTURE NUMBER

Note: Figures in brackets and dot-dashed lines denote Permanent Easements.  
V Denotes variable easement required for Verizon Virginia  
D Denotes variable easement required for Dominion Virginia Power

Note: Figures in parenthesis and dot-dashed lines denote Temporary Easements.

C Denotes Construction Limits In Cuts  
E Denotes Construction Limits In Fills

I ST'D. CG-7 REQ'D.  
A ST'D. MS-2 REQ'D.

|          |              |          |           |
|----------|--------------|----------|-----------|
| PLAN NO. | PROJECT      | FILE NO. | SHEET NO. |
|          | 6017-099-129 |          | 14        |