

SURVEYED BY: BOB HARRISON 12/5/1253-507
 SUPERVISED BY: P.H. BYRUM 1750-925-2557
 DESIGNED BY: M.D. WINSTEAD 1750-925-2556
 HAMPTON ROADS DISTRICT DESIGN UNIT

DESIGN FEATURES RELATING TO CONSTRUCTION OR TO REGULATION AND CONTROL OF TRAFFIC MAY BE SUBJECT TO CHANGE AS DEEMED NECESSARY BY THE DEPARTMENT

REVISED	STATE	FEDERAL AID	ROUTE	PROJECT	SHEET NO.
12/09/05 02/06/06 06/08/06 08/10/05	VA.		17	6017-099-129, RW-201, C-501	12

THESE PLANS ARE UNFINISHED AND ARE NOT TO BE USED FOR ANY TYPE OF CONSTRUCTION.

REFERENCES
(PROFILES, DETAIL & DRAINAGE DESCRIPTION SHEETS, ETC.)

MANLINE PROFILES	12A
ENTRANCE PROFILES	24D
DRAINAGE DESC.	2H11-2H71
CROSS-VER DETAIL	2E

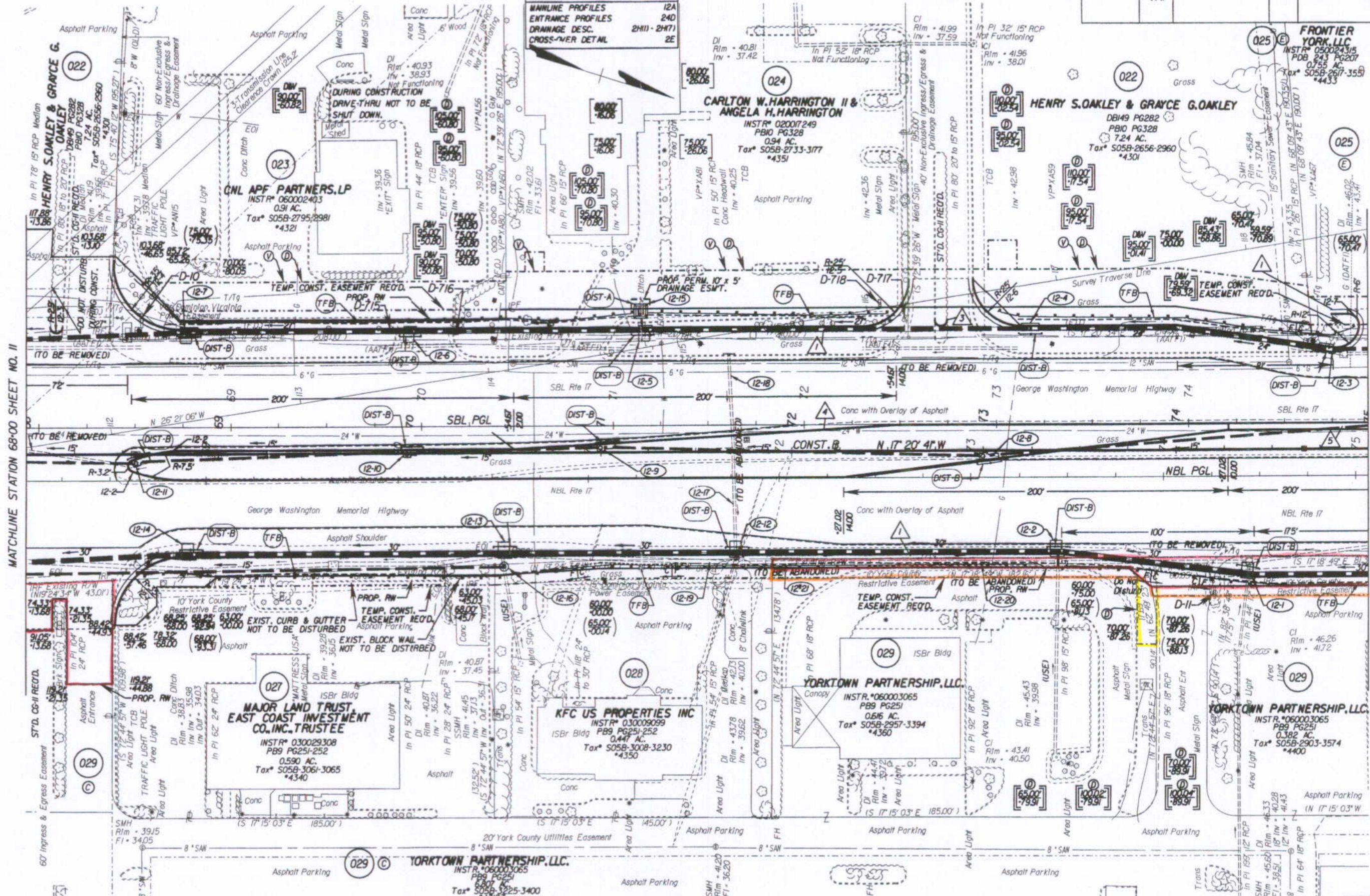

MATCHLINE STATION 68+00 SHEET NO. 11

MATCHLINE STATION 75+00 SHEET NO. 13

NOTE: PGL DENOTES PROFILE GRADE LINE
 NOTE: SEE GENERAL NOTES FOR E&S LEGEND
 ○ DENOTES DRAINAGE STRUCTURE NUMBER

Note: Figures in brackets and dot-dashed lines denote Permanent Easements.
 V Denotes variable easement required for Verizon Virginia
 D Denotes variable easement required for Dominion Virginia Power

Note: Figures in parentheses and dot-dot-dashed lines denote Temporary Easements.

⌈ Denotes Construction Limits In Cuts
 ⌋ Denotes Construction Limits In Fills

⚠ ST'D. CG-7 REO'D. ⚠ ST'D. MS-2 REO'D.
 ⚠ ST'D. CG-2 REO'D. ⚠ ST'D. MS-1A REO'D.



PLAN NO.	PROJECT	FILE NO.	SHEET NO.
	6017-099-129		12

State Highway Plat Book No. 10 Page 153

2/20/2007 10:56:33 AM \\HR-SERVER-FILES\PLANT\DC\Fva_3\off Lou.Rousse \\hr-server-1\file5\state\10\F10894312.d