

SURVEYED BY: JEB HARRIS, U.S. 1153-300
 SUPERVISED BY: Pat. B. BUN, U.S. 925-2557
 DESIGNED BY: M.L. WINSTEAD, U.S. 988-8556
 HAMPTON ROADS DISTRICT DESIGN UNIT

DESIGN FEATURES RELATING TO CONSTRUCTION OR TO REGULATION AND CONTROL OF TRAFFIC MAY BE SUBJECT TO CHANGE AS DEEMED NECESSARY BY THE DEPARTMENT

REVISION	DATE	STATE	FEDERAL AID	ROUTE	PROJECT	SHEET NO.
03/21/06	06/28/06	VA.		17	6017-099-129, RW-201, C-501	23

THESE PLANS ARE UNFINISHED AND ARE NOT TO BE USED FOR ANY TYPE OF CONSTRUCTION.

REFERENCES
(PROFILES, DETAIL & DRAINAGE DESCRIPTION SHEETS, ETC.)

MAINLINE PROFILES	23A
CONNECTION PROFILES	23C
ENTRANCE PROFILES	24 I
DRAINAGE DESC.	24(I) - 24(T)
CROSS-OVER DETAIL	2E

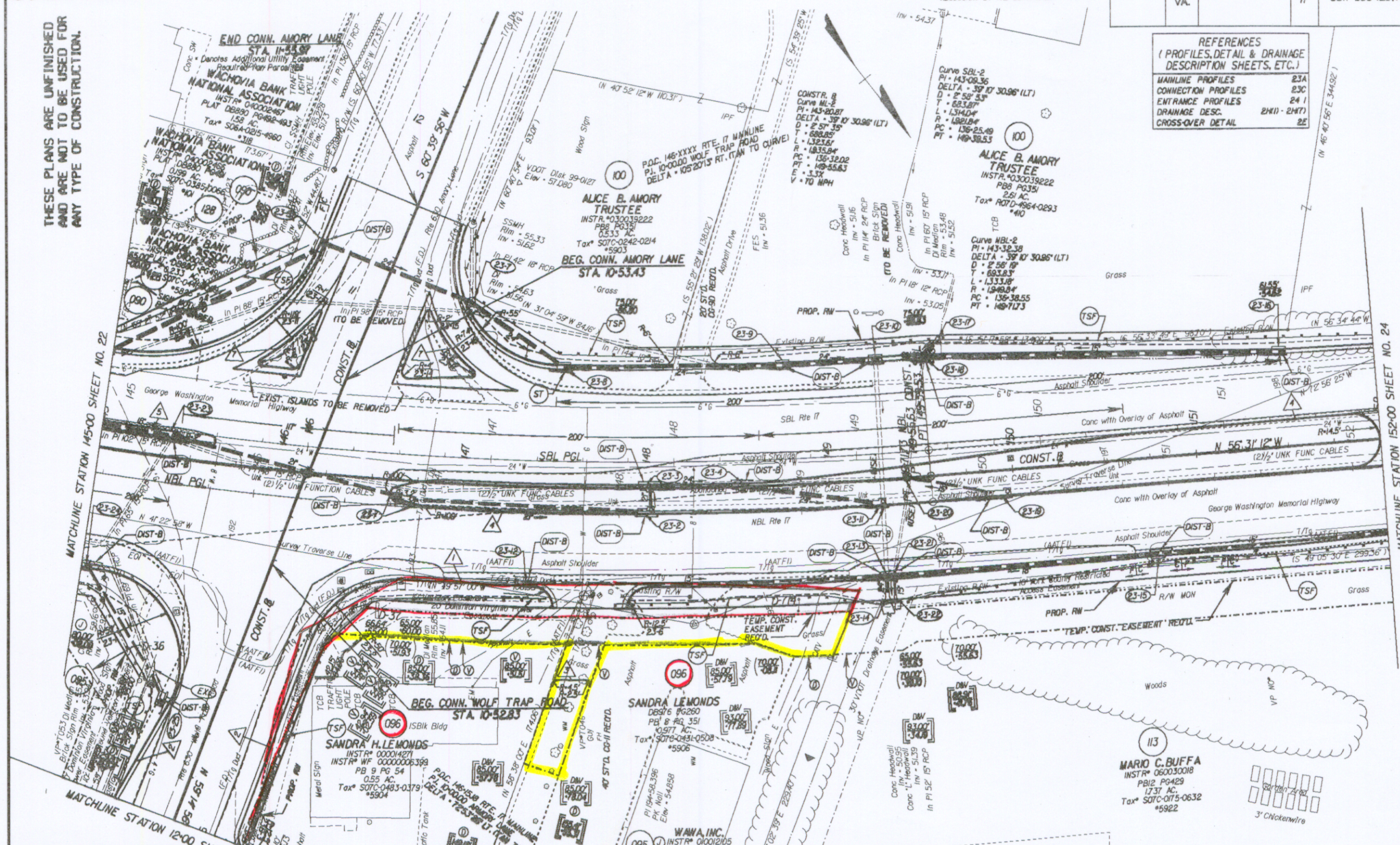

Note: Figures in brackets and dot-dashed lines denote Permanent Easements.
 (V) Denotes variable easement required for Verizon Virginia
 (D) Denotes variable easement required for Dominion Virginia Power
 NOTE: PGL DENOTES PROFILE GRADE LINE
 NOTE: SEE GENERAL NOTES FOR EBS LEGEND
 (O) DENOTES DRAINAGE STRUCTURE NUMBER

Note: Figures in parenthesis and dot-dashed lines denote Temporary Easements.

- 1 ST'D. CG-7 REQ'D.
- 2 ST'D. CG-6 REQ'D.
- 3 ST'D. CG-2 REQ'D.
- 4 ST'D. MS-2 REQ'D.
- 5 ST'D. MS-1A REQ'D.
- 7 ST'D. SI-2 REQ'D.

- C Denotes Construction Limits In Cuts
- F Denotes Construction Limits In Fills

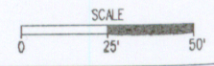

PLAN NO.	PROJECT	FILE NO.	SHEET NO.
	6017-099-129		23