

SURVEYED BY: J.B. HARMON (1/5/12) 125353
SUPERVISED BY: J. K. HARMON, P.E. (7/1/25) 2406
DESIGNED BY: K.D. MCKINNA, P.E. (12/1/25) 3622
HAMPTON ROADS DISTRICT DESIGN UNIT

DESIGN FEATURES RELATING TO CONSTRUCTION OR TO REGULATION AND CONTROL OF TRAFFIC MAY BE SUBJECT TO CHANGE AS DEEMED NECESSARY BY THE DEPARTMENT

REVISED	STATE	FEDERAL NO	ROUTE	STATE	SHEET NO.
12/08/05 02/06/06 05/28/07	VA.		17	6017-099-129, RW-201, C-501	14

UTILITY OWNERS:
SEE SHEET 3 FOR DETAILS.

MATCHLINE STATION 82+00 SHEET NO. 13

MATCHLINE STATION 89+00 SHEET NO. 15

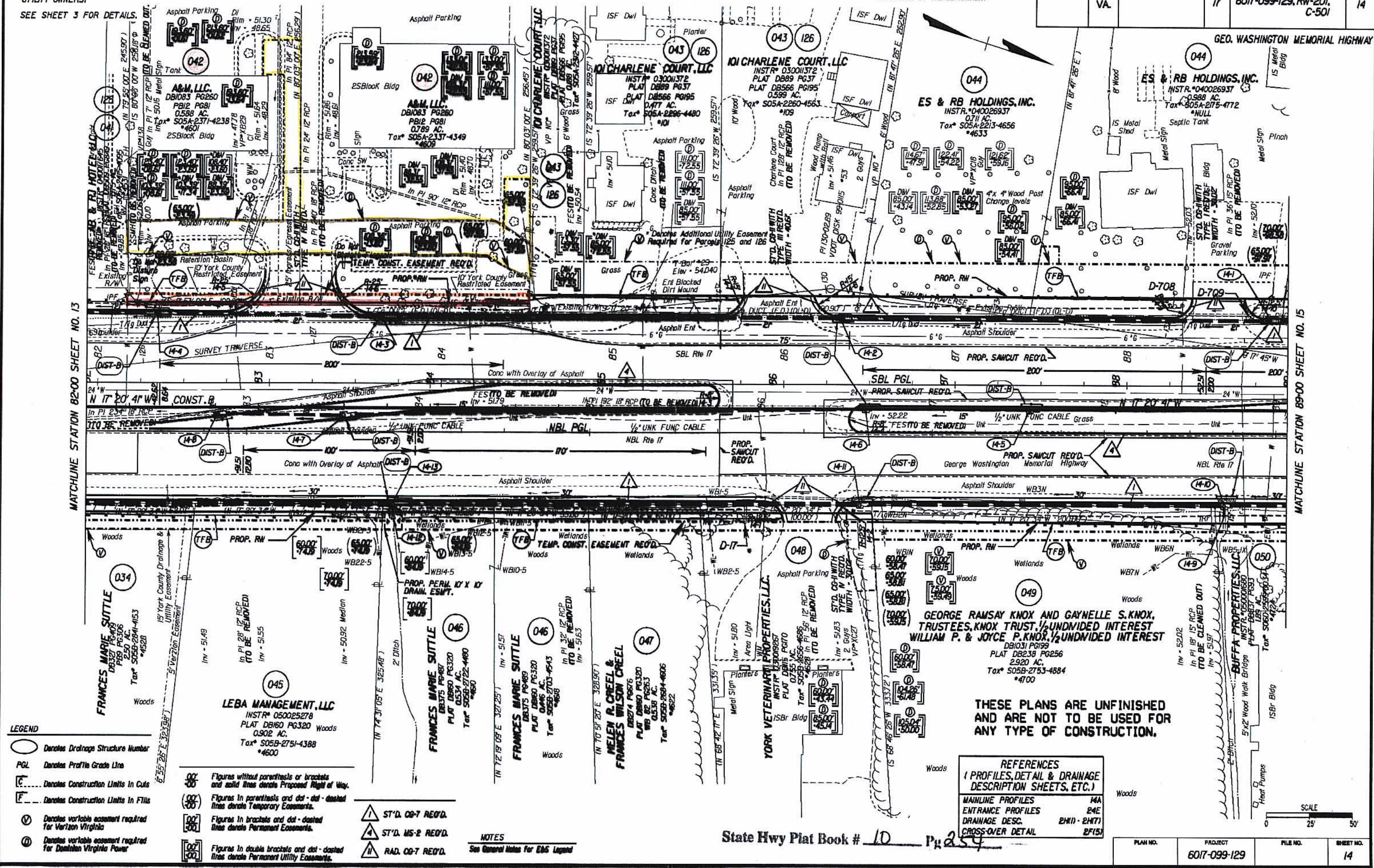

THESE PLANS ARE UNFINISHED AND ARE NOT TO BE USED FOR ANY TYPE OF CONSTRUCTION.

REFERENCES (PROFILES, DETAIL & DRAINAGE DESCRIPTION SHEETS, ETC.)	
MAINLINE PROFILES	14A
ENTRANCE PROFILES	24E
DRAINAGE DESC.	2H(1) - 2H(7)
CROSS-OVER DETAIL	2F(5)

- LEGEND**
- Denotes Drainage Structure Number
 - PGL Denotes Profile Grade Line
 - Denotes Construction Limits In Cuts
 - - - Denotes Construction Limits In Fills
 - ⊙ Denotes variable easement required for Verizon Virginia
 - ⊕ Denotes variable easement required for Dominion Virginia Power

- 00' Figures without parenthesis or brackets and solid lines denote Proposed Right of Way.
- 00' Figures in parenthesis and dot-dash lines denote Temporary Easements.
- 00' Figures in brackets and dot-dashed lines denote Permanent Easements.
- 00' Figures in double brackets and dot-dashed lines denote Permanent Utility Easements.

- ▲ ST'D. CO-7 REQ'D.
- ▲ ST'D. MS-2 REQ'D.
- ▲ RAD. CO-7 REQ'D.

NOTES
See General Notes For E&S Legend

State Hwy Plat Book # 10 p. 254

Inst# 080025360

PLAN NO.	PROJECT	FILE NO.	SHEET NO.
	6017-099-129		14

