

UTILITY OWNERS:
 SEE SHEET 3 FOR DETAILS.

PAGE 2

THESE PLANS ARE UNFINISHED
 AND ARE NOT TO BE USED FOR
 ANY TYPE OF CONSTRUCTION.

DESIGN FEATURES RELATING TO CONSTRUCTION
 OR TO REGULATION AND CONTROL OF TRAFFIC
 MAY BE SUBJECT TO CHANGE AS DEEMED
 NECESSARY BY THE DEPARTMENT

| REVISED | STATE | FEDERAL AID PROJECT | ROUTE | STATE PROJECT | SHEET NO. |
|----------|-------|---------------------|-------|-----------------------------|-----------|
| 03/23/06 | VA. | | 17 | 6017-099-129, RW-201, C-501 | 21 |

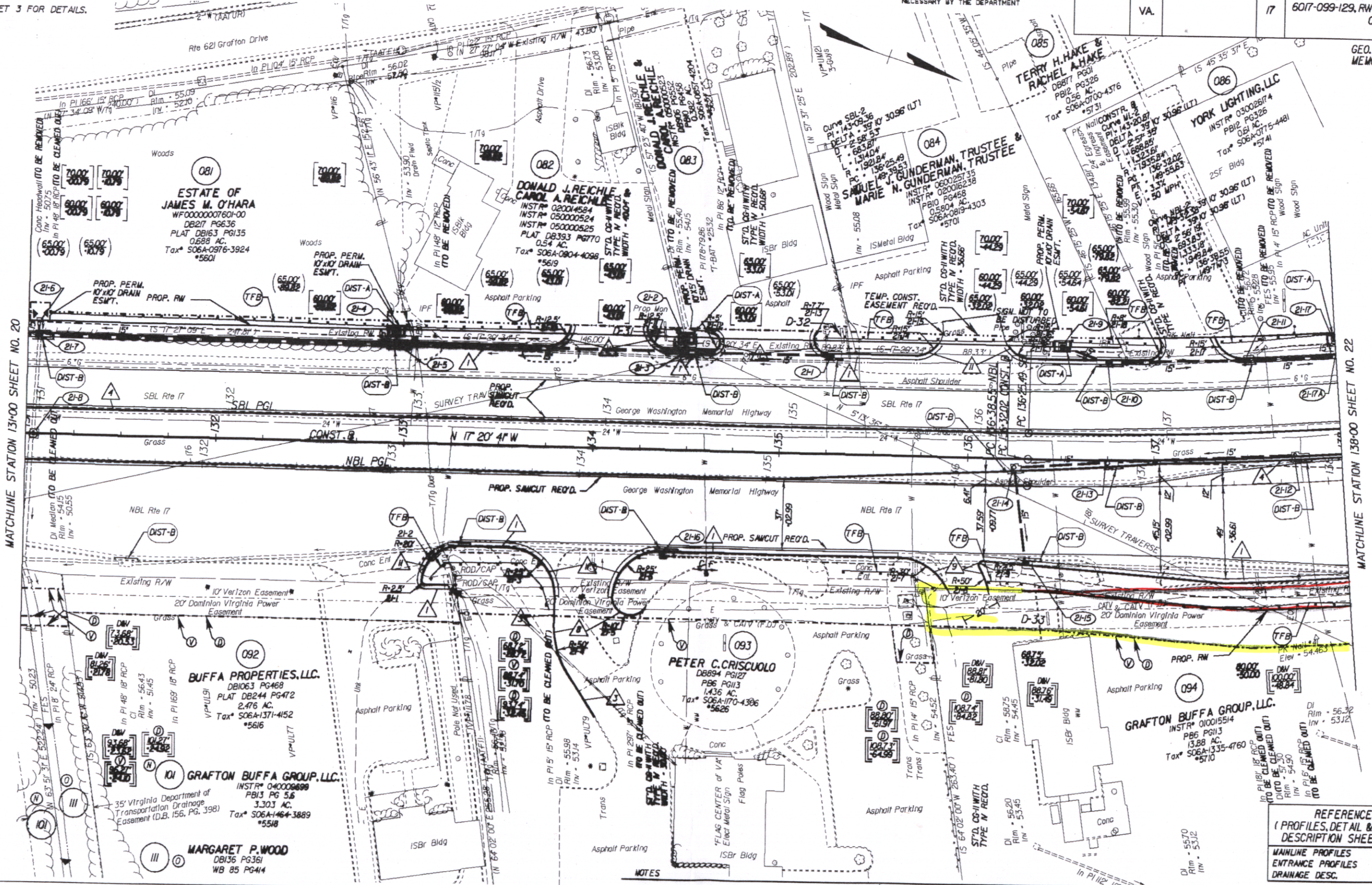

MATCHLINE STATION 13+00 SHEET NO. 20

MATCHLINE STATION 138+00 SHEET NO. 22

REFERENCES
 (PROFILES, DETAIL & DRAINAGE DESCRIPTION SHEETS, ETC.)

| | |
|-------------------|---------------|
| MAINLINE PROFILES | 2/A |
| ENTRANCE PROFILES | 24H, 24K |
| DRAINAGE DESC. | 2H(1) - 2H(7) |

- NOTES
- ① Denotes Drainage Structure Number
 - ② Denotes Profile Grade Line
 - ③ Denotes Construction Limits In Cuts
 - ④ Denotes Construction Limits In Fills
 - ⑤ Denotes variable easement required for Verizon Virginia
 - ⑥ Denotes variable easement required for Dominion Virginia Power
 - ⑦ Figures without parenthesis or brackets and solid lines denote Proposed Right of Way.
 - ⑧ Figures in parenthesis and dot-dot-dashed lines denote Temporary Easements.
 - ⑨ Figures in brackets and dot-dashed lines denote Permanent Easements.
 - ⑩ Figures in double brackets and dot-dashed lines denote Permanent Utility Easements.
 - ⑪ ST'D. CG-7 REQ'D.
 - ⑫ ST'D. CG-2 REQ'D.
 - ⑬ ST'D. MS-2 REQ'D.
 - ⑭ RAD. CG-2 REQ'D.
 - ⑮ RAD. CG-3 REQ'D.
 - ⑯ RAD. CG-7 REQ'D.
- NOTES
 See General Notes For E&S Legend
- SCALE
 0 25' 50'
- | PLAN NO. | PROJECT | FILE NO. | SHEET NO. |
|----------|--------------|----------|-----------|
| | 6017-099-129 | | 21 |