

UTILITY OWNERS:  
 SEE SHEET 3 FOR DETAILS.

DESIGN FEATURES RELATING TO CONSTRUCTION OR TO REGULATION AND CONTROL OF TRAFFIC MAY BE SUBJECT TO CHANGE AS DEEMED NECESSARY BY THE DEPARTMENT

REVISION	STATE	FEDERAL AID	ROUTE	STATE	PROJECT	SHEET NO.
12/08/05 02/06/06 05/29/07 07/30/08	VA.		17		6017-099-129, RW-201, C-501	15

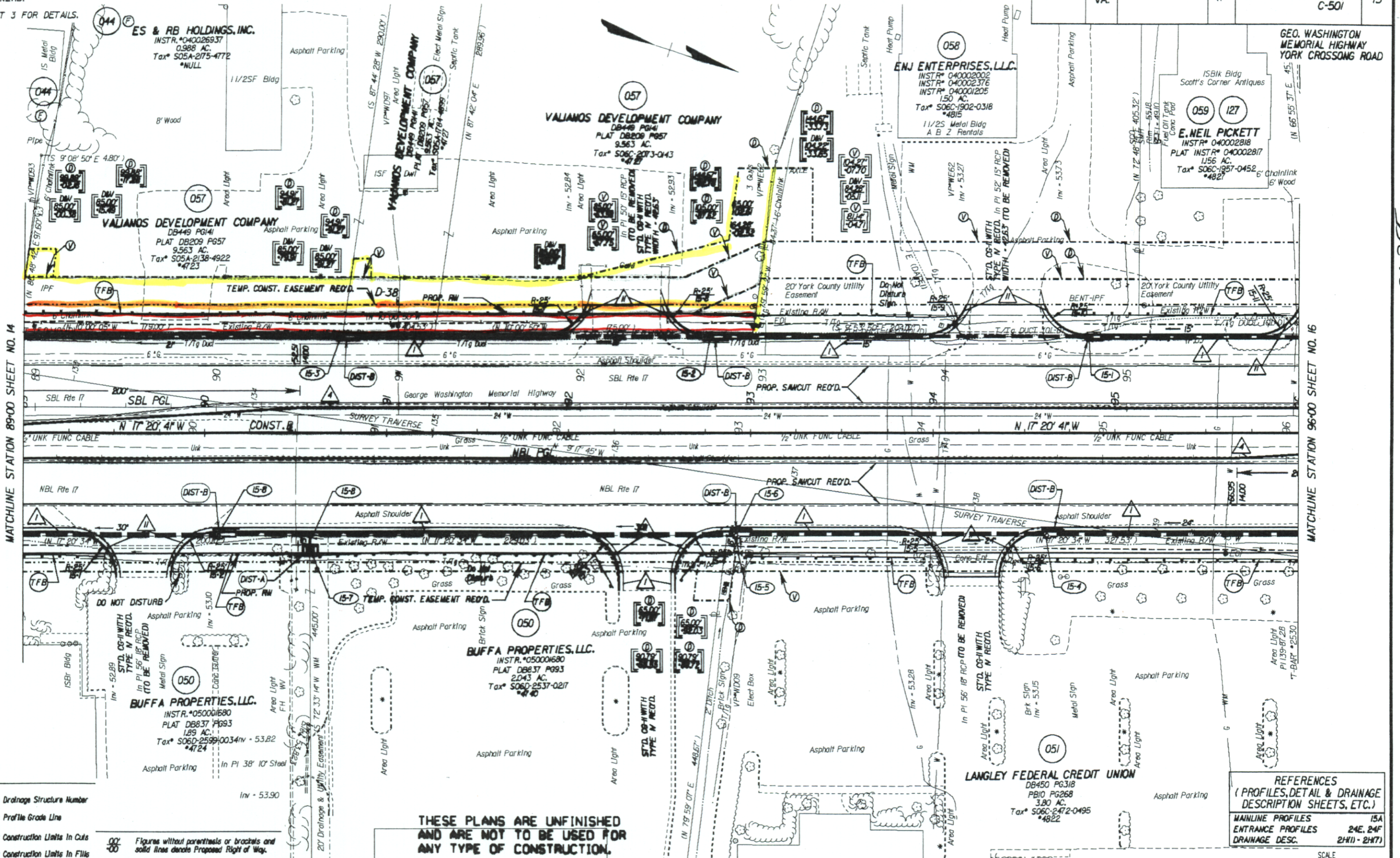

- SEND
- Denotes Drainage Structure Number
  - Denotes Profile Grade Line
  - Denotes Construction Units In Cuts
  - - - Denotes Construction Units In Fills
  - ) Denotes variable easement required for Verizon Virginia
  - ) Denotes variable easement required for Dominion Virginia Power

- Figures without parenthesis or brackets and solid lines denote Proposed Right of Way.
- Figures in parenthesis and dot-dot-dashed lines denote Temporary Easements.
- Figures in double brackets and dot-dot-dashed lines denote Permanent Utility Easements.

- x Denotes Additional Utility Easement Required For Parcel 127
- △ ST'D. MS-2 REQ'D.
- △ RAD. CG-7 REQ'D.

THESE PLANS ARE UNFINISHED AND ARE NOT TO BE USED FOR ANY TYPE OF CONSTRUCTION.

REFERENCES  
 (PROFILES, DETAIL & DRAINAGE DESCRIPTION SHEETS, ETC.)

MAINLINE PROFILES	15A
ENTRANCE PROFILES	24E, 24F
DRAINAGE DESC.	2H(1) - 2H(7)

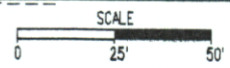

PLAN NO.	PROJECT	FILE NO.	SHEET NO.
	6017-099-129		15

MATCHLINE STATION 89+00 SHEET NO. 14

MATCHLINE STATION 96+00 SHEET NO. 16

DOC # 080026366

State Hwy Plat Book # 10 Pg 311