

DESIGNED BY: BOB HARMON (757) 253-5171  
 SUPERVISED BY: J. K. HANCOCK, P.E. (757) 925-2406  
 SIGNED BY: K. D. MCKINNA, P.E. (757) 925-3622  
 WYOMING DISTRICT DESIGN UNIT

UTILITY OWNERS:

SEE SHEET 3 FOR DETAILS.

DESIGN FEATURES RELATING TO CONSTRUCTION OR TO REGULATION AND CONTROL OF TRAFFIC MAY BE SUBJECT TO CHANGE AS DEEMED NECESSARY BY THE DEPARTMENT

REVISION	DATE	FEDERAL AID PROJECT	ROUTE	STATE PROJECT	SHEET NO.
12/08/05	02/06/06	VA.	17	6017-099-129, RW-201, C-501	14

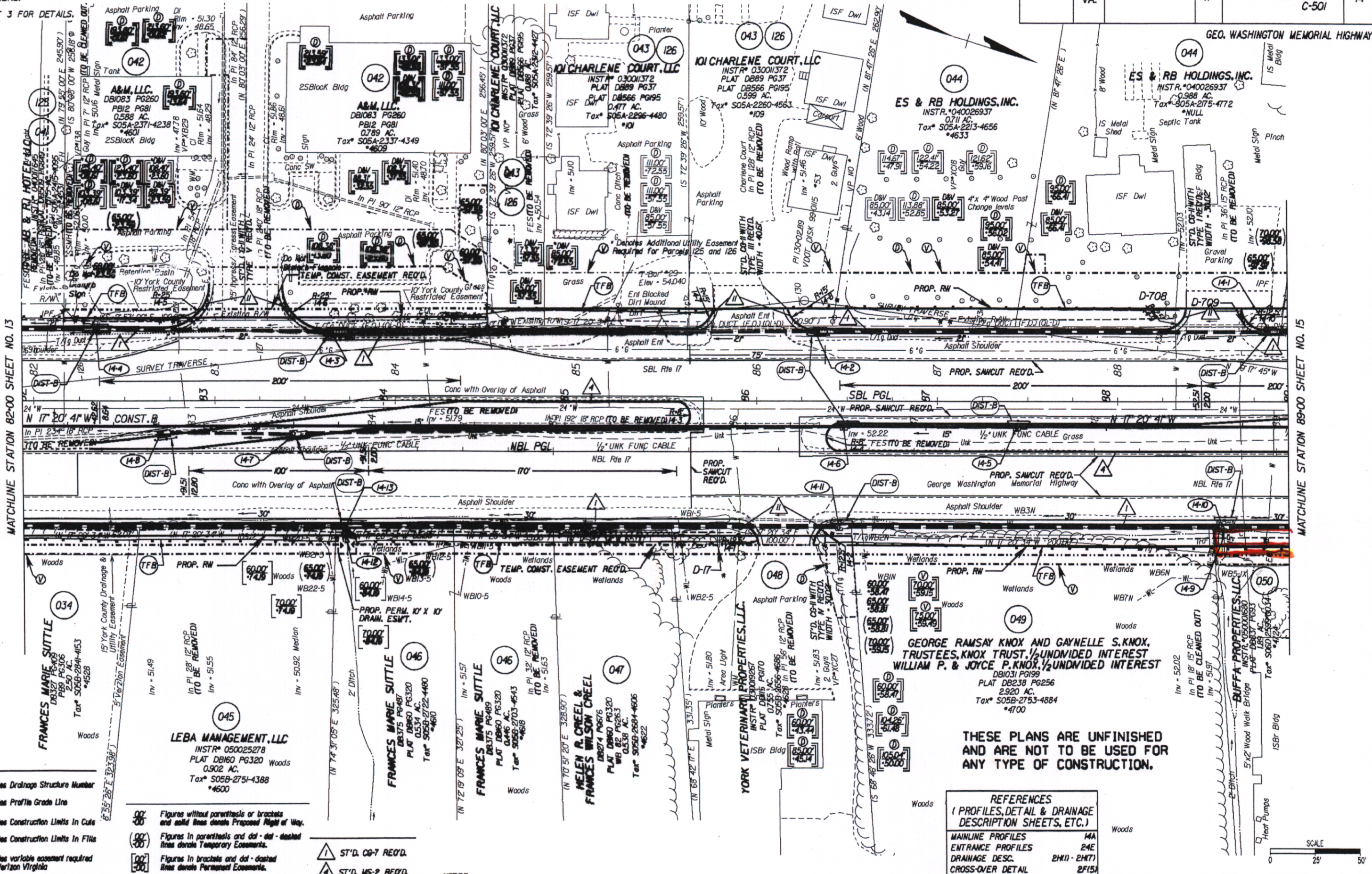

MATCHLINE STATION 82+00 SHEET NO. 13

MATCHLINE STATION 89+00 SHEET NO. 15

- ND
- Denotes Drainage Structure Number
- Denotes Profile Grade Line
- Denotes Construction Limits In Cuts
- Denotes Construction Limits In Fills
- ⌋ Denotes variable easement required for Verizon Virginia
- ⌋ Denotes variable easement required for Dominion Virginia Power

- ① Figures without parenthesis or brackets and solid lines denote Proposed Right of Way.
- ② Figures in parenthesis and dot-dashed lines denote Temporary Easements.
- ③ Figures in brackets and dot-dashed lines denote Permanent Easements.
- ④ Figures in double brackets and dot-dashed lines denote Permanent Utility Easements.

- △ ST'D. CG-7 REQ'D.
- △ ST'D. MS-2 REQ'D.
- △ RAD. CG-7 REQ'D.

NOTES  
 See General Notes For E&S Legend

THESE PLANS ARE UNFINISHED AND ARE NOT TO BE USED FOR ANY TYPE OF CONSTRUCTION.

REFERENCES (PROFILES, DETAIL & DRAINAGE DESCRIPTION SHEETS, ETC.)	
MAINLINE PROFILES	14A
ENTRANCE PROFILES	24E
DRAINAGE DESC.	2H(1) - 2H(7)
CROSS-OVER DETAIL	2F(15)

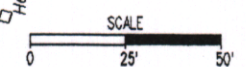

PLAN NO.	PROJECT	FILE NO.	SHEET NO.
	6017-099-129		14

DOC # 08-26357

State Hwy Plat Book # 10 P# 329