

DESIGNED BY BOB BARNUM 1/50/2003
 REVISED BY T. K. HANNA, P.E. (757) 925-2406
 DRAWN BY K.D. MCKINNA, P.E. (757) 925-3622
 TOWN ROADS DISTRICT DESIGN UNIT

UTILITY OWNERS:
 SEE SHEET 3 FOR DETAILS.

DESIGN FEATURES RELATING TO CONSTRUCTION OR TO REGULATION AND CONTROL OF TRAFFIC MAY BE SUBJECT TO CHANGE AS DEEMED NECESSARY BY THE DEPARTMENT

REVISION	DATE	FEDERAL AID	ROUTE	STATE	PROJECT	SHEET NO.
12/08/05	02/06/06	VA.	17	6017-099-129, RW-201, C-501		15

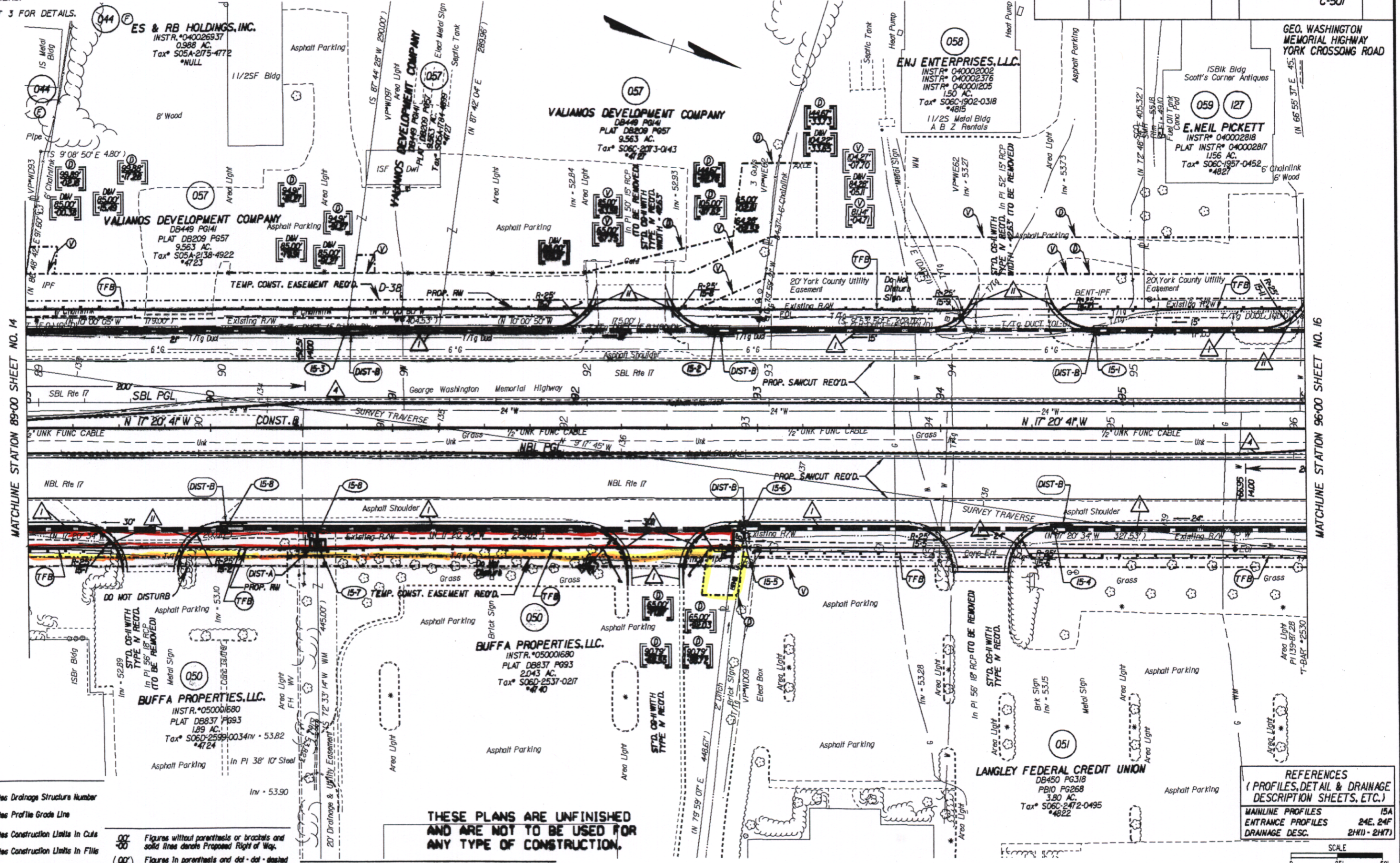

THESE PLANS ARE UNFINISHED AND ARE NOT TO BE USED FOR ANY TYPE OF CONSTRUCTION.

- ND
- Denotes Drainage Structure Number
- Denotes Profile Grade Line
- Denotes Construction Units in Cuts
- Denotes Construction Units in Fills
- Denotes variable easement required for Verizon Virginia
- Denotes variable easement required for Dominion Virginia Power

- 00 Figures without parenthesis or brackets and solid lines denote Proposed Right of Way.
- 00 Figures in parenthesis and dot-dot-dashed lines denote Temporary Easements.
- 00 Figures in double brackets and dot-dashed lines denote Permanent Utility Easements.

- x Denotes Additional Utility Easement Required for Parcel 127
- 1 ST'D. CG-7 REQ'D.
- 4 ST'D. MS-2 REQ'D.
- 11 RAD. CG-7 REQ'D.

REFERENCES
 (PROFILES, DETAIL & DRAINAGE DESCRIPTION SHEETS, ETC.)

MAINLINE PROFILES	15A
ENTRANCE PROFILES	24E, 24F
DRAINAGE DESC.	24H1 - 24H7

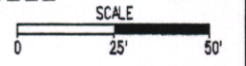

PLAN NO.	PROJECT	FILE NO.	SHEET NO.
	6017-099-129		15

MATCHLINE STATION 89+00 SHEET NO. 14

MATCHLINE STATION 96+00 SHEET NO. 16

Doc # 08-26357

State Hwy Plat Book # 10 Pg 328