

UTILITY OWNERS:  
 SEE SHEET 3 FOR DETAILS.

THESE PLANS ARE UNFINISHED FOR AND ARE NOT TO BE USED FOR ANY TYPE OF CONSTRUCTION.

DESIGN FEATURES RELATING TO CONSTRUCTION OR TO REGULATION AND CONTROL OF TRAFFIC MAY BE SUBJECT TO CHANGE AS DEEMED NECESSARY BY THE DEPARTMENT

REVISION	STATE	FEDERAL AID	ROUTE	STATE	SHEET NO.
12/08/05	VA.		17	6017-099-129, RW-201, C-501	16
02/06/06					
05/23/07					
07/30/08					

REFERENCES	
(PROFILES, DETAIL & DRAINAGE DESCRIPTION SHEETS, ETC.)	
MAINLINE PROFILES	16A
ENTRANCE PROFILES	24F, 24G
DRAINAGE DESC.	24(I) - 24(J)
CROSS-OVER DETAIL	2F(5)

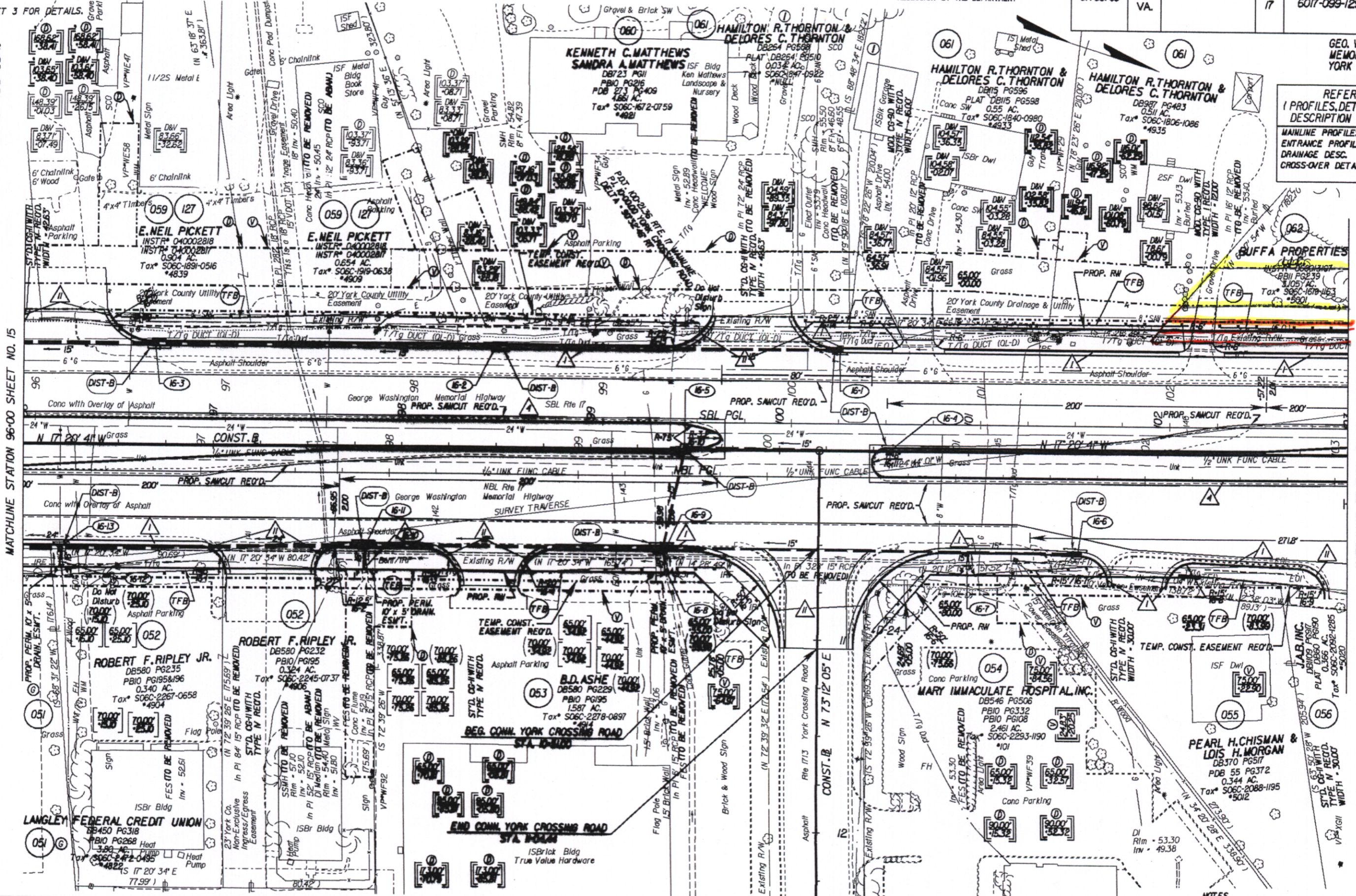

MATCHLINE STATION 96+00 SHEET NO. 15

MATCHLINE STATION 103+00 SHEET NO. 17

CLOC# 08-26367

State Hwy Plat Book # 16 Pt 324

END

Denotes Drainage Structure Number	Denotes Construction Limits In Cuts	Denotes variable assessment required for Virginia	Denotes additional Utility Easement required for Parcel 127	Figures without parentheses or brackets and solid lines denote Proposed Right of Way.	Figures in brackets and dot - dashed lines denote Permanent Easements.	ST'D. MS-2 REQ'D.
Denotes Profile Grade Line	Denotes Construction Limits In Fills	Denotes variable assessment required for Dominion Virginia Power	Figures in double brackets and dot - dashed lines denote Temporary Easements.	Figures in parentheses and dot - dot - dashed lines denote Temporary Easements.	Figures in brackets and dot - dashed lines denote Permanent Easements.	ST'D. CG-7 REQ'D.

NOTES: See General Notes For E&S Legend

PLAN NO.	PROJECT	FILE NO.	SHEET NO.
	6017-099-129		16