

Design File - c:\documents of ms_jocai\60843\d6084307.dgn Ref. File - c:\documents of ms_jocai\ref\d60843des.dgn Ref. File - c:\documents of ms_jocai\ref\d60843pat.dgn Ref. File - c:\documents of ms_jocai\ref\d60843new.dgn Ref. File - c:\documents of ms_jocai\ref\d60843.dgn Ref. File - c:\documents of ms_jocai\ref\d60843.dgn

SURVEYED BY BOB PATTEN (750) 253-5317
SUPERVISED BY T. K. HAYNAM, P.E. (757) 925-2402
DESIGNED BY K. J. MCKENNA, P.E. (757) 925-3622
HAMPTON ROADS DISTRICT DESIGN UNIT

DESIGN FEATURES RELATING TO CONSTRUCTION OR TO REGULATION AND CONTROL OF TRAFFIC MAY BE SUBJECT TO CHANGE AS DEEMED NECESSARY BY THE DEPARTMENT

REVISED	STATE	FEDERAL AID PROJECT	ROUTE	STATE PROJECT	SHEET NO.
12/09/05 02/06/06	VA.		17	6017-099-129, RW-201 B-604, C-501	7

UTILITY OWNERS:
SEE SHEET 3 FOR DETAILS.

THESE PLANS ARE UNFINISHED AND ARE NOT TO BE USED FOR ANY TYPE OF CONSTRUCTION.

REFERENCES
(PROFILES, DETAIL & DRAINAGE DESCRIPTION SHEETS, ETC.)

MAINLINE PROFILES	7A
HYDRO. DATA SHEET	2/
DRAINAGE DESC.	2(HI) - 2(HI)
BRIDGE PLANS	?

GEO. WASHINGTON MEMORIAL HIGHWAY

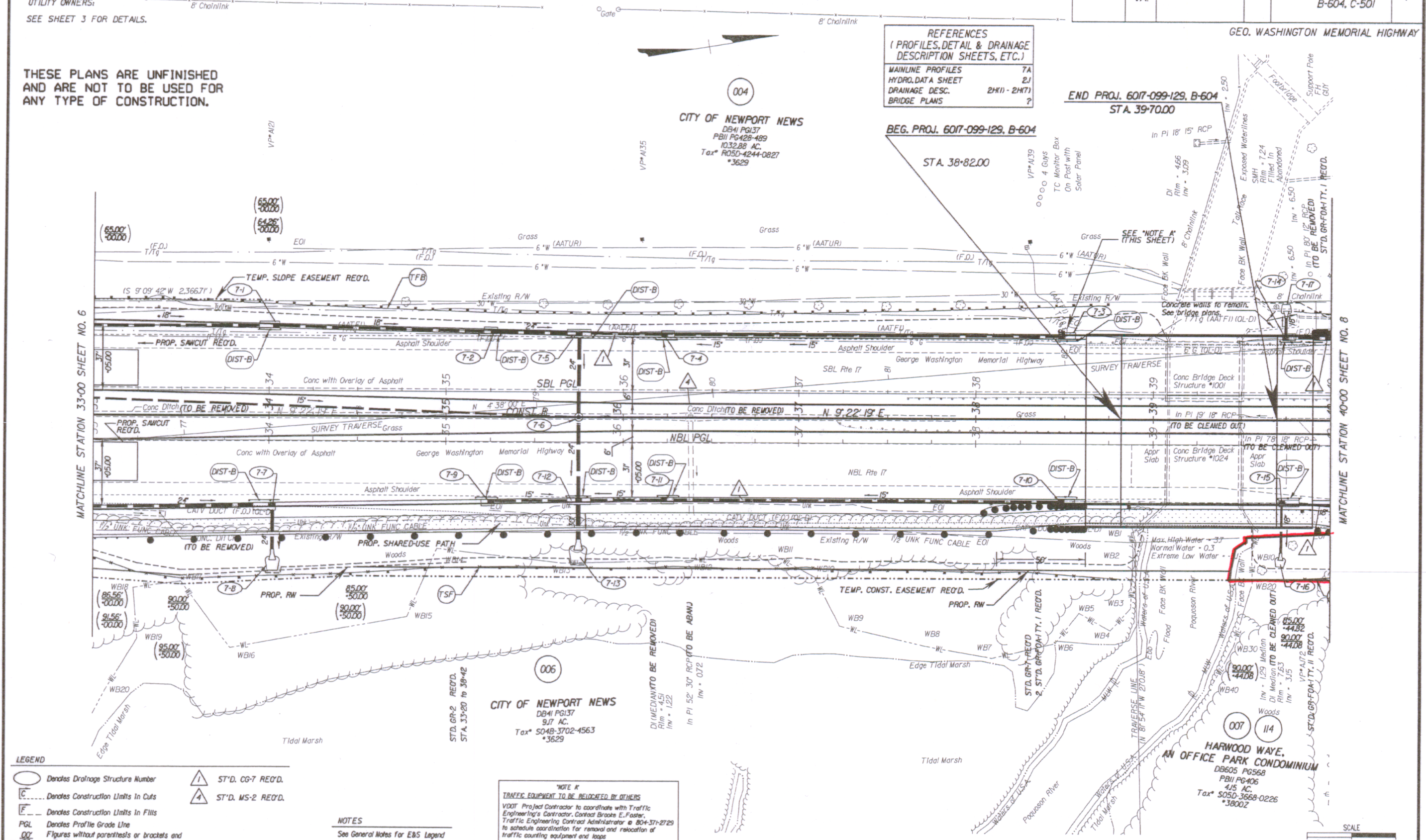

MATCHLINE STATION 33+00 SHEET NO. 6

MATCHLINE STATION 40+00 SHEET NO. 8

CITY OF NEWPORT NEWS
DB41 PG137
9J7 AC.
Tax* 504B-3702-4563
*3629

HARWOOD WYE,
AN OFFICE PARK CONDOMINIUM
DB605 PG568
PB11 PG406
4J5 AC.
Tax* S05D-3668-0226
*3800Z

- LEGEND
- Denotes Drainage Structure Number
 - △ ST'D. CG-7 RECD.
 - Denotes Construction Limits in Cuts
 - △ ST'D. MS-2 RECD.
 - ▭ Denotes Construction Limits in Fills
 - PGL Denotes Profile Grade Line
 - Figures without parenthesis or brackets and solid lines denote Proposed Right of Way.
 - () Figures in parenthesis and dot-dot-dashed lines denote Temporary Easements.

NOTES
See General Notes For E&S Legend

NOTE K
TRAFFIC EQUIPMENT TO BE RELOCATED BY OTHERS
VDOT Project Contractor to coordinate with Traffic Engineering's Contractor. Contact Brooks E. Foster, Traffic Engineering Contract Administrator @ 804-371-2729 to schedule coordination for removal and relocation of traffic counting equipment and loops

CLOC INSTR # 090005095

12/17/2008 13:56:55

PLAN NO.	PROJECT	FILE NO.	SHEET NO.
	6017-099-129		7