

# PLAT INSTRUMENT # LR100017713

The vacation of the property line as shown hereon is with the free consent of the undersigned owners:

B. Lee Whalen, Jr. 10-21-2010  
B. Lee Whalen, Jr. Date

Glynda W. Whalen 10-21-2010  
Glynda W. Whalen Date

COMMONWEALTH OF VIRGINIA,  
County of York, to wit:

This instrument was acknowledged before me this 21st day of October, 2010.

Spencer Mettler 7066277  
Notary Public Registration No.  
My commission expires 11/30/2010

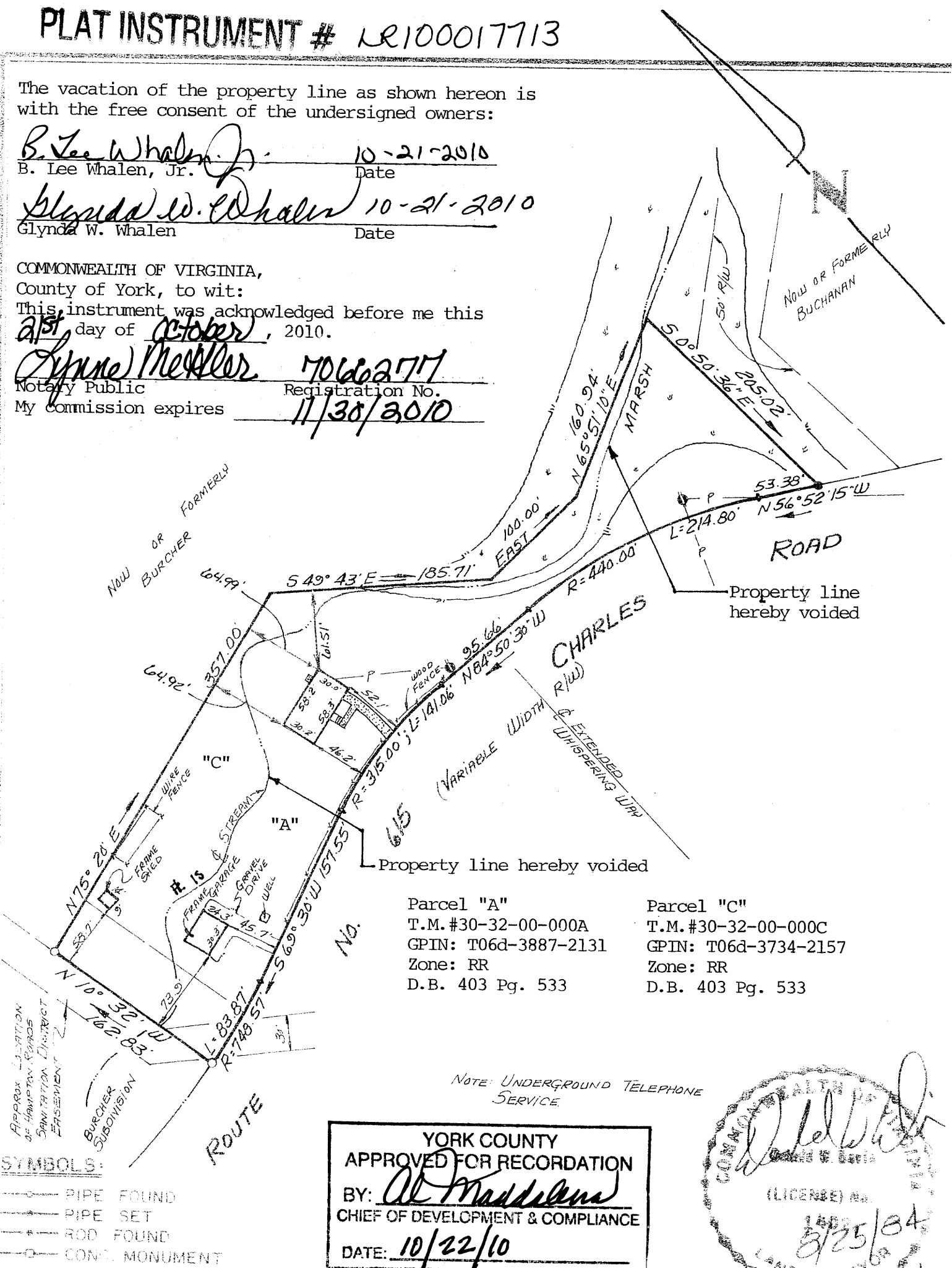

Parcel "A"  
T.M. #30-32-00-000A  
GPIN: T06d-3887-2131  
Zone: RR  
D.B. 403 Pg. 533

Parcel "C"  
T.M. #30-32-00-000C  
GPIN: T06d-3734-2157  
Zone: RR  
D.B. 403 Pg. 533

- SYMBOLS:**
- PIPE FOUND
  - PIPE SET
  - \*— ROD FOUND
  - CONC. MONUMENT

**YORK COUNTY**  
**APPROVED FOR RECORDATION**  
BY: Al Maddalena  
CHIEF OF DEVELOPMENT & COMPLIANCE  
DATE: 10/22/10

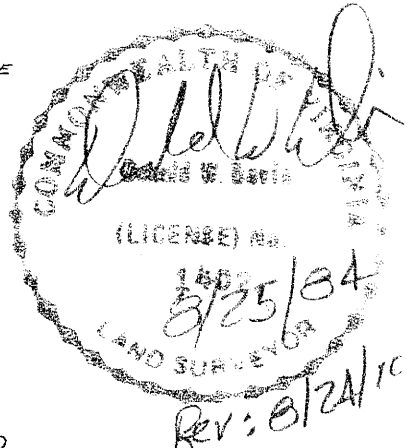

Donald W. Davis  
HEREBY CERTIFY THAT THE SURVEY REPRESENTED BY THIS PLAT WAS MADE BY ME ON THIS DATE AND IS CORRECT TO THE BEST OF MY KNOWLEDGE AND BELIEF. THERE ARE NO ENCROACHMENTS OF BUILDINGS UNLESS SHOWN HEREON.  
DAVIS & ASSOCIATES  
SURVEYORS & PLANNERS  
YORK COUNTY, VIRGINIA

JOB LOCATION # ~~XXXXX~~ 513 CHARLES ROAD  
PLAT OF THE PROPERTY OF:  
LEE WHALEN & GLYNDA W. PORTER

**PARCEL OF LAND**  
**CONTAINING - 2± ACRES**  
**(BEING PARCELS A & C AS**  
**RECORDED IN PB#9, PG.#194)**  
**GRAFTON DISTRICT**  
**YORK COUNTY, VA.**