

VICINITY MAP
1"=2000'

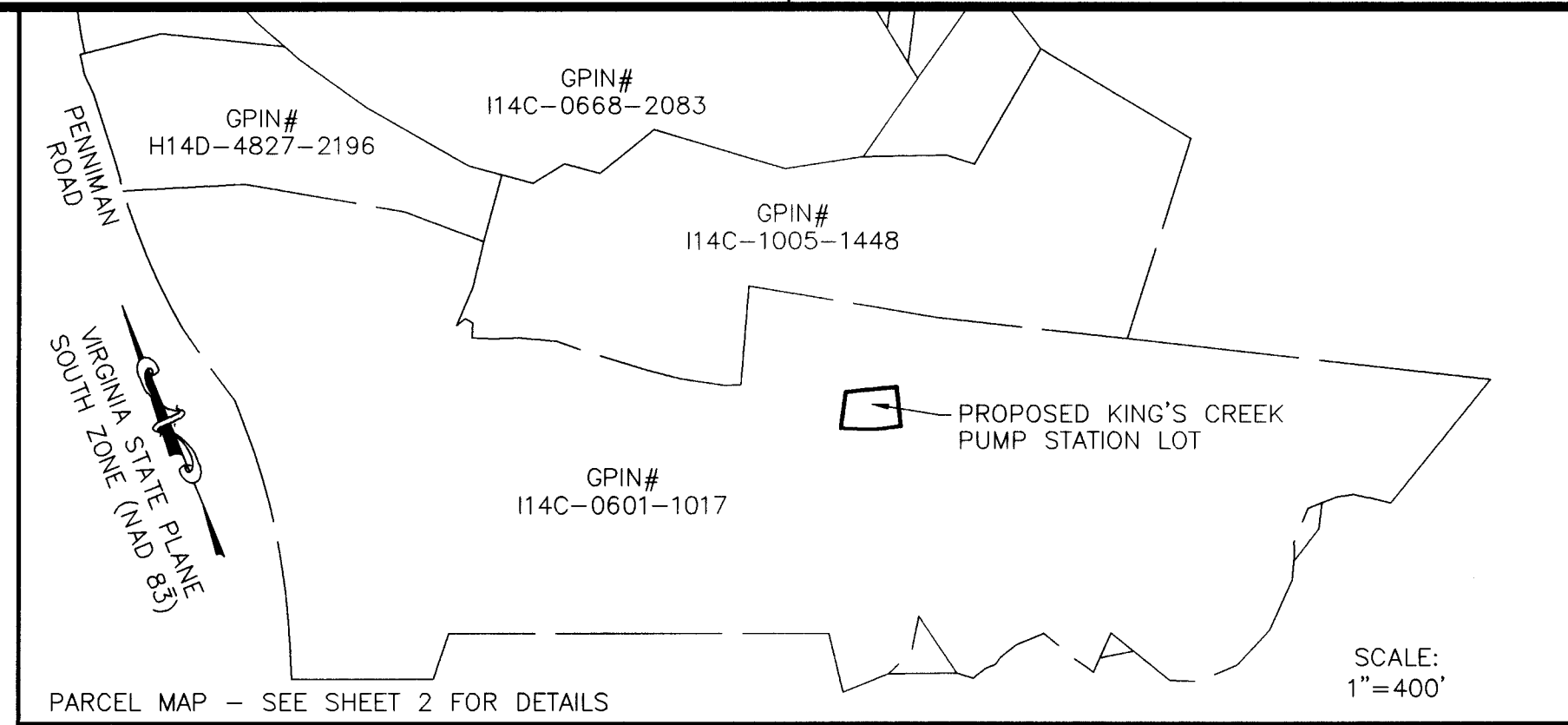

**SUBDIVISION OF
THE PROPERTY OF
KING'S CREEK PLANTATION, L.L.C.
(KING'S CREEK PUMP STATION LOT)**
BRUTON DISTRICT, YORK COUNTY, VIRGINIA
DATE: 12/7/11
REVISED: 11/15/12
SHEET 1 OF 2

SURVEYOR'S CERTIFICATE

I HEREBY CERTIFY THAT TO THE BEST OF MY KNOWLEDGE AND BELIEF, ALL THE REQUIREMENTS AS SET FORTH IN THE ORDINANCE FOR APPROVING PLATS OF SUBDIVISION IN THE COUNTY OF YORK, VIRGINIA HAVE BEEN COMPLIED WITH, INCLUDING A CLOSURE OF NOT LESS THAN 1'/20,000'. THIS IS TO CERTIFY THAT THE LAND EMBRACED IN THIS SUBDIVISION IS AS FOLLOWS:

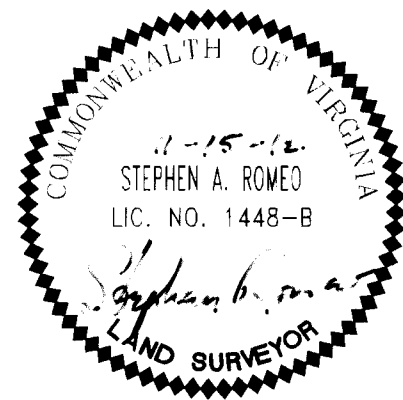

TAX MAP NO. 11-27-00-000B

IS IN THE NAME OF KING'S CREEK PLANTATION, L.L.C., A VIRGINIA LIMITED LIABILITY COMPANY, AND WAS ACQUIRED FROM EVERETTE H. NEWMAN, III, MARRIED, AND JOHN L. GIBSON, II, MARRIED, BY DEED DATED MARCH 31, 1998, AND DULY RECORDED IN THE CLERK'S OFFICE OF THE CIRCUIT COURT OF THE COUNTY OF YORK-POQUOSON, VIRGINIA IN DEED BOOK 1007 PAGE 494.

IS IN THE NAME OF KING'S CREEK PLANTATION, L.L.C., A VIRGINIA LIMITED LIABILITY COMPANY, AND WAS ACQUIRED FROM SUE WARBURTON REDD AND MARTHA WARBURTON McMURRAN, BY DEED DATED MARCH 25, 1998, AND DULY RECORDED IN THE CLERK'S OFFICE OF THE CIRCUIT COURT OF THE COUNTY OF YORK-POQUOSON, VIRGINIA IN DEED BOOK 1004 PAGE 747.

IS IN THE NAME OF KING'S CREEK PLANTATION, L.L.C., A VIRGINIA LIMITED LIABILITY COMPANY, AND WAS ACQUIRED FROM ROGER D. HOWELL AND LINDA P. HOWELL, TRUSTEES UNDER THE DECLARATION OF TRUST DATED JANUARY 29, 1997, IDENTIFIED AS THE HOWELL TRUST, BY DEED DATED MARCH 18, 1998, AND DULY RECORDED IN THE CLERK'S OFFICE OF THE CIRCUIT COURT OF THE COUNTY OF YORK-POQUOSON, VIRGINIA IN DEED BOOK 1004 PAGE 744.

IS IN THE NAME OF KING'S CREEK PLANTATION, L.L.C., A VIRGINIA LIMITED LIABILITY COMPANY, AND WAS ACQUIRED FROM BUSCH PROPERTIES, INC., A DELAWARE CORPORATION, BY DEED DATED JUNE 17, 2002, AND DULY RECORDED IN THE CLERK'S OFFICE OF THE CIRCUIT COURT OF THE COUNTY OF YORK-POQUOSON, VIRGINIA AS INSTRUMENT NO. 020011940.

IS IN THE NAME OF KING'S CREEK PLANTATION, L.L.C., A VIRGINIA LIMITED LIABILITY COMPANY, AND WAS ACQUIRED FROM DOUGLAS JACKSON AND ELVIA D. JACKSON, HUSBAND AND WIFE, BY DEED DATED JULY 10, 1998, AND DULY RECORDED IN THE CLERK'S OFFICE OF THE CIRCUIT COURT OF THE COUNTY OF YORK-POQUOSON, VIRGINIA IN DEED BOOK 1027 PAGE 948.

I CERTIFY THAT IRON RODS AS SHOWN ON THIS PLAT WILL BE SET ON OR BEFORE FEBRUARY, 2013.

Stephen A. Romeo 11-15-12
STEPHEN A. ROMEO DATE

IS IN THE NAME OF KING'S CREEK PLANTATION, L.L.C., A VIRGINIA LIMITED LIABILITY COMPANY, AND WAS ACQUIRED FROM GLADYS MAY PARSON (SOMETIMES PARSONS) PATTON, UNMARRIED, BY DEED DATED JULY 10, 1998, AND DULY RECORDED IN THE CLERK'S OFFICE OF THE CIRCUIT COURT OF THE COUNTY OF YORK-POQUOSON, VIRGINIA IN DEED BOOK 1027 PAGE 954.

IS IN THE NAME OF KING'S CREEK PLANTATION, L.L.C., A VIRGINIA LIMITED LIABILITY COMPANY, AND WAS ACQUIRED FROM QUEEN PARSON PIGGOTT AND MERVIN PIGGOTT, HUSBAND AND WIFE, BY DEED DATED JULY 10, 1998, AND DULY RECORDED IN THE CLERK'S OFFICE OF THE CIRCUIT COURT OF THE COUNTY OF YORK-POQUOSON, VIRGINIA IN DEED BOOK 1027 PAGE 951.

IS IN THE NAME OF KING'S CREEK PLANTATION, L.L.C., A VIRGINIA LIMITED LIABILITY COMPANY, AND WAS ACQUIRED FROM COMMONWEALTH OF VIRGINIA, BY DEED DATED JANUARY 25, 1999, AND DULY RECORDED IN THE CLERK'S OFFICE OF THE CIRCUIT COURT OF THE COUNTY OF YORK-POQUOSON, VIRGINIA IN DEED BOOK 1091 PAGE 823.

IS IN THE NAME OF KING'S CREEK PLANTATION, L.L.C., A VIRGINIA LIMITED LIABILITY COMPANY, AND WAS ACQUIRED FROM BUSCH PROPERTIES, INC., A DELAWARE CORPORATION, BY DEED DATED JULY 12, 1999, AND DULY RECORDED IN THE CLERK'S OFFICE OF THE CIRCUIT COURT OF THE COUNTY OF YORK-POQUOSON, VIRGINIA IN DEED BOOK 1108 PAGE 301.

NOTES:

- THESE PROPERTIES ARE ZONED EO (ECONOMIC OPPORTUNITY) ACCORDING TO YORK COUNTY ZONING MAP.
- MERIDIAN IS BASED UPON YORK COUNTY DATUM REFERENCE MONUMENT NO. 037-RESET COORDINATES FOR MON. 037-RESET IN U.S. SURVEY FEET:
(NORTHING) 3626414.349
(EASTING) 12024453.965
ELEV. =84.00
- BUILDING SETBACKS:
a. MIN. FRONT YARD - 45'
b. MIN. SIDE YARD - 10'
c. MIN. REAR YARD - 10'
- WATER & SEWER: EACH LOT WITHIN THIS SUBDIVISION WILL BE SERVED BY PUBLIC WATER & PUBLIC SEWER. SEWER PROVIDED BY YORK COUNTY. WATER PROVIDED BY NEWPORT NEWS WATERWORKS.
- WETLANDS SHOWN WERE FIELD DELINEATED BY LANDMARK DESIGN GROUP, INC. IN 1998 AND 2004.
- THE LIMITS OF NATURAL RESOURCES EXCEPT AS NOTED ON THESE PROPERTIES HAVE NOT BEEN INVENTORIED OR FIELD VERIFIED. ALL FUTURE CONSTRUCTION OR LAND DEVELOPMENT SHALL BE SUBJECT TO THE REQUIREMENTS OF THE CHESAPEAKE BAY PRESERVATION AREA DESIGNATION AND MANAGEMENT REGULATIONS (9 VAC-10-20-10) AND CHAPTER 23.2 OF THE YORK COUNTY CODE AS WELL AS SECTION 24.1-376 (WATERSHED MANAGEMENT AND PROTECTION AREA OVERLAY DISTRICT) OF THE YORK COUNTY ZONING ORDINANCE.
- THE PROPERTY EMBRACED WITHIN THE LIMITS OF THIS SURVEY APPEARS TO LIE WITHIN ZONE X, ZONE X500, AND ZONE AE ACCORDING TO FEDERAL EMERGENCY MANAGEMENT AGENCY - NATIONAL FLOOD INSURANCE PROGRAM COMMUNITY PANEL NUMBER 51199C0070C DATED 6-16-09.
- THIS PLAT WAS PREPARED WITHOUT THE BENEFIT OF A CURRENT TITLE REPORT AND THEREFORE MAY NOT DEPICT ALL TITLE MATTERS AFFECTING THE PROPERTY SHOWN HEREON.
- TAX MAP NO. 11-27-00-000B
GPIN: 114C-0601-1017

OWNER'S CONSENT - KING'S CREEK PLANTATION, L.L.C., A VIRGINIA LIMITED LIABILITY COMPANY
FOR:
GPIN NO. 114C-0601-1017

THE PLATTING OF THE LAND AS SHOWN HEREON IS WITH THE FREE CONSENT AND IN ACCORDANCE WITH THE DESIRES OF THE UNDERSIGNED OWNER(S), PROPRIETOR(S) AND TRUSTEES.

Thomas J. Ruhf 12/13/12
SIGNATURE DATE

THOMAS J. RUHF
NAME PRINTED TITLE

CERTIFICATE OF NOTARIZATION FOR KING'S CREEK PLANTATION, L.L.C.

STATE OF: Virginia
CITY/COUNTY OF: York County
I, (PRINT) Thomas J. Ruhf A NOTARY PUBLIC IN AND FOR THE CITY/COUNTY AND STATE AFORESAID, DO HEREBY CERTIFY THAT THE PERSON(S) WHOSE NAME IS SIGNED TO THE FOREGOING WRITING HAS ACKNOWLEDGED THE SAME BEFORE ME IN THE JURISDICTION AFORESAID. GIVEN UNDER MY NAME THIS 13th DAY OF December, 2012. MY COMMISSION EXPIRES 12-30-10.

Thomas J. Ruhf 7146583
(SIGNATURE) (REGISTRATION NO.)



Vanasse Hangen Brustlin, Inc.
Transportation Land Development Environmental Services
351 McLaws Circle, Suite 3
Williamsburg, Virginia 23185
(757) 220-0500 • FAX (757) 220-8544

APPROVED:
YORK COUNTY BOARD OF SUPERVISORS
BY: C. Daddario
PLAT APPROVING AGENT
DATE: 3/20/13

STATE OF VIRGINIA, COUNTY OF YORK
IN THE CLERK'S OFFICE OF THE CIRCUIT COURT FOR THE COUNTY OF YORK-POQUOSON THE 20th DAY OF March, 2013, THIS MAP WAS PRESENTED AND ADMITTED TO RECORD AS THE LAW DIRECTS AS at 2:04pm
INSTRUMENT NO. 130205289
TESTE: Stephan S. A. Verbitzer
CLERK
BY: Christina H. Quitt D.C.

2013 MAR 22 PM 2:04