

000014593

NOTE:
1. SEE NOTE ON SHEET 1 OF 4.

MATCHLINE (SEE SHEET 1)

EXISTING 5' YORK COUNTY LANDSCAPE PRESERVATION EASEMENT (INST 040014597)

GENERALS WAY
50' R/W
(STATE ROUTE 1379)
A=234.09
R=250.00'

EXISTING RIGHT OF WAY LINE

EXISTING 20' YORK COUNTY UTILITY EASEMENT (INST 040014597)

EXISTING 15' VA POWER UTILITY EASEMENT (INST 050031157)

51.17' N 13°04'11" E
END GENERAL'S WAY
RIGHT-OF-WAY
L=19.25'
R=25.00'
L=10.07'
R=300.00'

L=24.70'
R=25.00'

L=252.71'
R=52.00'

VIRGINIA STATE PLANE COORDINATE SYSTEM SOUTH ZONE (NAD 1983)

EXISTING TURNAROUND EASEMENT (SHADED) TO BE VACATED UPON EXTENSION OF GENERALS WAY (INSTRUMENT NO 040014597)

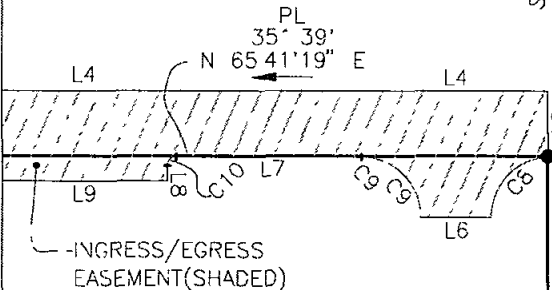

N 3598416 854
E 12068840 724

PARCEL A
(105,239 SQ FT)
(9.303 AC)

PARCEL B
(90,857 SQ FT)
(2.086 AC)

353.40' S 24°18'06" E

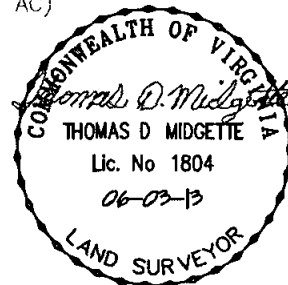

EXHIBIT SHOWING
INGRESS AND EGRESS EASEMENTS OVER
PARCELS A AND B FOR THE BENEFIT OF PARCELS A AND B

YORK COUNTY, VIRGINIA

SCALE: 1" = 50'

JUNE 3, 2013

NDI ENGINEERING COMPANY
BASGIER AND ASSOCIATES DIVISION

ENGINEERS-SURVEYORS-PLANNERS
572 CENTRAL DRIVE, SUITE 103, VIRGINIA BEACH, VA 23454
PHONE (757) 431-2177 FAX (757) 431-2175

SHEET 2 OF 4