

000428

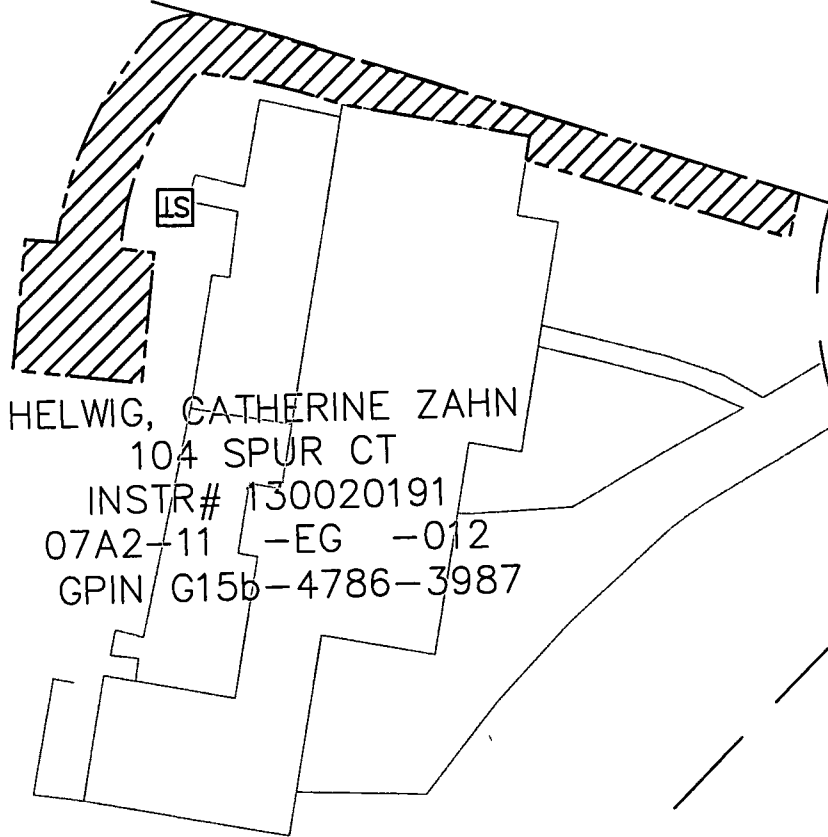

HELWIG, CATHERINE ZAHN  
 104 SPUR CT  
 INSTR# 130020191  
 07A2-11 -EG -012  
 GPIN G15b-4786-3987



**LEGEND**

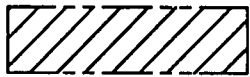

DENOTES APPROXIMATE LOCATION OF PERMANENT UTILITY EASEMENT HEREBY CONVEYED TO YORK COUNTY



PROPERTY LINE

**NOTES:**

1. THE YORK COUNTY UTILITY EASEMENT CONSISTS OF 10 FT WIDTH, CENTERED ON THE 1.5" FORCE MAIN, AND A 15 FT SQUARE EASEMENT CENTERED AROUND THE GRINDER PUMP.
2. THIS PLAT IS FOR EASEMENT PURPOSES ONLY AND DOES NOT CONSTITUTE A PHYSICAL OR BOUNDARY SURVEY.
3. TOPOGRAPHIC INFORMATION, IF SHOWN, WAS PROVIDED BY URS, INC.

**PLAT OF EASEMENT**

PROPERTY OF CATHERINE ZAHN HELWIG, 104 SPUR COURT  
 TO: COUNTY OF YORK  
 PROJECT: QUEEN'S LAKE SANITARY SEWER PROJECT - CONTRACT #4

**YORK COUNTY ENVIRONMENTAL & DEVELOPMENT SERVICES**

105 SERVICE DRIVE  
 YORK COUNTY, VA 23692  
 757.890.3752

DRAWN BY: KCC	SCALE: 1"=30'	DATE: 6/10/2014
------------------	------------------	--------------------