

TAXMAP: 30P-03-02-020
 GPIN: U05a-0693-3641
 101 CHERRY POINT DR.
 HARNESS, MICHAEL A. & KERI C.
 INST.# 160089934
 P.B.6, PG.73
 ZONING: RR

LOT 20
 P.B.6, PG.73

TAXMAP: 30P-03-02-019
 GPIN: U05a-0829-3507
 103 CHERRY POINT DR.
 DEWITT, KENNETH J. &
 ELIZABETH W.
 INST.# 120014210
 P.B.6, PG.73, ZONING: RR

NOTES:

- OWNERS
 KEVIN L. VANDEVENDER &
 NICOLA M. VANDEVENDER &
- EASTERLY PART OF LOT 8
 TAXMAP: 30P-01-00-008
 GPIN: U05a-0572-3479
- WESTERLY PART OF LOT 9
 TAXMAP: 30P-01-00-009A
 GPIN: U05a-0652-3483
- REF: D.B.839, PG.297
 D.B.348, PG.28
 D.B.203, PG.102
 P.B.6, PG.36
- SURVEY PREPARED WITHOUT
 A TITLE REPORT, ALL EASE-
 MENTS MAY NOT BE SHOWN
- ZONED: RR
- FLOOD INSURANCE RATE MAP
 ZONE: X & X500
 MAP NO. 51199C0143D
 PANEL DATE: 1-18-15
- THIS PROPERTY IS IN THE
 RESOURCE PROTECTION AREA
 (RPA) AND
 RESOURCE MANAGEMENT AREA
 (RMA)

THIS PROPERTY LINE VACATION IS WITH THE FREE
 CONSENT AND IN ACCORDANCE WITH THE DESIRE
 OF THE UNDERSIGNED OWNERS

Kevin L. VanDevender 7-18-18 KLV
 KEVIN L. VANDEVENDER DATE
Nicola M. VanDevender 7/19/18
 NICOLA M. VANDEVENDER DATE

STATE OF VIRGINIA York TO WIT:

I Adrienne Armand NOTARY PUBLIC IN AND FOR THE
 CITY/COUNTY AND STATE AFORESAID, DO HEREBY
 CERTIFY THAT THE PERSONS WHOSE NAMES ARE
 SIGNED TO THE FOREGOING WRITING HAVE ACKNOWLEDGED
 THE SAME BEFORE ME IN MY JURISDICTION AFORESAID,

GIVEN UNDER MY HAND THIS 19 DAY OF July, 2018
 MY COMMISSION EXPIRES: 9-30-2020
 REGISTRATION NUMBER: 345573

REVISED PER COUNTY COMMENTS 7-18-18
 REVISED PER COUNTY COMMENTS 7-11-18

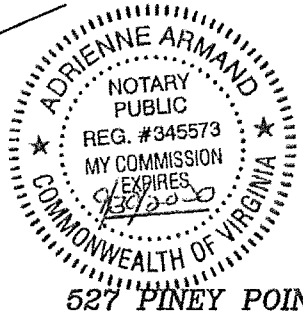
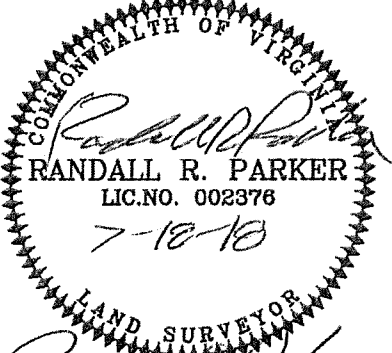

PINEY POINT RD.
 50' R/W, RTE. 661
 APPROVED FOR RECORDATION
 BY: *[Signature]*
 DIR. OF PLANNING & DEVELOPMENT SERVICES

DATE: JULY 19, 2018

527 PINEY POINT RD.

PROPERTY LINE VACATION PLAT

PINEY POINT ESTATES
 SECTION ONE

WESTERLY PART OF LOT 9 & EASTERLY PART OF LOT 8
 GRAFTON DISTRICT
 YORK COUNTY, VIRGINIA

JOB #: 18-109	DRAWN: RRP	F.B.-PG: 58-9	TO: VANDEVENDER	SCALE: 1" = 40'	DATE: 6-19-18
------------------	---------------	------------------	--------------------	--------------------	------------------

PARKER SURVEYING, INC.
 6858 MICHAEL LANE
 HAYES, VIRGINIA 23072
 PHONE: 804-684-0600

I, Randall R. Parker HEREBY CERTIFY
 THAT THE PROPERTY SHOWN ON THIS PLAT WAS SURVEYED
 ON THIS DATE AND IS CORRECT TO THE BEST OF MY
 KNOWLEDGE AND BELIEF.

THERE ARE NO ENCROACHMENTS OF OTHER BUILDINGS
 EXCEPT AS SHOWN.

TAXMAP: 30P-01-00-007
 GPIN: U05a-0451-3531
 529 PINEY POINT RD.
 DANIELSON, MARK A. ETUX.
 INST.# 080016927
 PLAT# 020005669
 ZONING: RR

LOT 7
 PLAT# 020005669
 P.B.6, PG.36

TAXMAP: 30P-01-00-009A
 GPIN: U05a-0652-3483
 527 PINEY POINT RD.
 VANDEVENDER, KEVIN L. ETUX.
 D.B.839, PG.297
 D.B.348, PG.28
 D.B.203, PG.102
 P.B.6, PG.36
 ZONING: RR

TAXMAP: 30P-01-00-008
 GPIN: U05a-0572-3479
 527 PINEY POINT RD.
 VANDEVENDER, KEVIN L. ETUX.
 D.B.839, PG.297
 D.B.348, PG.28
 D.B.203, PG.102
 P.B.6, PG.36
 ZONING: RR

TAXMAP: 30P-01-00-009
 GPIN: U05a-0674-3406
 525 PINEY POINT RD.
 DAVIS, DAVID A. ETUX.
 D.B.362, PG.337
 PLAT, D.B.203, PG.102
 ZONING: RR

EASTERLY PART
 OF LOT 9
 D.B.203, PG.102
 P.B.6, PG.36

LOT 8B
 34,659 Sq.Ft.
 0.7956 Acres

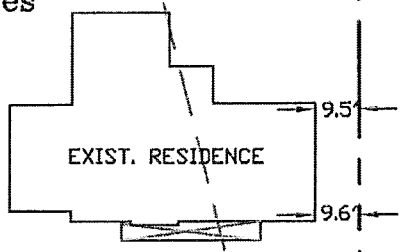

265.95'

S 62°43'00" E
 91.28'

S 23°43'00" E
 69.09'

261.53'

S 53°29'00" W

N 42°08'00" E

N 39°48'18" E

A 100.00'
 R 705.98'
 D 8°06'58"

IRF

IRS

