

EASEMENT LEGEND

- ① - EXISTING 40' YORK COUNTY DRAINAGE EASEMENT [D.B. 359, PG. 469]
- ② - EXISTING 20' YORK COUNTY UTILITY EASEMENT (CENTERED OVER SANITARY SEWER LINE) [INST. # 170019369]
- ③ - EXISTING VARIABLE WIDTH YORK COUNTY SIGHT EASEMENT [INST. # 170019369]
- ④ - EXISTING PRIVATE 25' DRAINAGE AND UTILITY EASEMENT FOR THE BENEFIT OF TAX PARCELS #36-00-00-022 & #36-01-00-000A [INST. # 100021723]
- ⑤ - EXISTING VARIABLE WIDTH PRIVATE DRAINAGE AND UTILITY EASEMENT FOR THE BENEFIT OF TAX PARCELS #36-00-00-022 & #36-01-00-000A [INST. # 140021262]
- ⑥ - EXISTING 35' PRIVATE INGRESS/EGRESS, DRAINAGE AND UTILITIES EASEMENT [INST. # 170020100]
- ⑦ - EXISTING VARIABLE WIDTH DRAINAGE EASEMENT (OVER AND THROUGH STORMWATER BASIN, BMP #'s 3 & 4) [INST. # 170020100]
- ⑧ - EXISTING 10' DRAINAGE EASEMENT (CENTERED ON STORM DRAIN) [INST. # 170020100]
- ⑨ - EXISTING VARIABLE WIDTH YORK COUNTY WETLANDS CONSERVATION EASEMENT (OVER AND ACROSS JURISDICTIONAL WETLANDS) [INST. # 170019369]
- ⑩ - EXISTING TEMPORARY TURNAROUND EASEMENT TO BE VACATED UPON THE EXTENSION OF KEENER WAY [INST. # 170020100]
- ⑪ - EXISTING VARIABLE WIDTH YORK COUNTY SIGHT EASEMENT [INST. # 170020100]
- ⑫ - EXISTING PRIVATE VARIABLE WIDTH PEDESTRIAN ACCESS ESMT. (ENCOMPASSING SIDEWALKS AND CROSSWALKS ADJACENT TO PUBLIC RIGHT-OF-WAYS). [INST. # 170019369]
- ⑬ - EXISTING PRIVATE VARIABLE WIDTH PEDESTRIAN ACCESS ESMT. (ENCOMPASSING SIDEWALKS AND CROSSWALKS ADJACENT TO PUBLIC RIGHT-OF-WAYS) [INST. # 170020100]
- ⑭ - EXISTING 20' YORK COUNTY UTILITY EASEMENT [INST. # 170020100]
- ⑮ - EXISTING PRIVATE 10' DRAINAGE EASEMENT (CENTERED ON STORM DRAIN) [INST. # 170019369]

LINE DATA TABLE

LINE	BEARING	DISTANCE	LINE	BEARING	DISTANCE	LINE	BEARING	DISTANCE
L1	S 52°53'42" E	34.51'	L37	N 35°13'01" E	34.53'	L73	N 89°57'38" W	12.55'
L2	S 38°08'01" E	115.77'	L38	N 36°58'28" W	22.16'	L74	S 52°21'03" W	15.66'
L3	S 72°39'26" E	133.70'	L39	N 03°24'00" E	27.42'	L75	S 03°51'00" W	13.19'
L4	S 72°48'23" E	84.27'	L40	N 14°01'34" E	7.71'	L76	S 77°34'42" W	17.12'
L5	S 80°15'53" E	47.00'	L41	N 72°37'10" W	80.00'	L77	S 05°06'51" E	11.62'
L6	S 09°44'07" W	21.36'	L42	S 78°14'24" W	24.16'	L78	S 55°13'35" W	11.75'
L7	N 80°15'53" W	137.70'	L43	N 41°02'25" W	22.47'	L79	N 77°41'13" W	11.01'
L8	S 89°53'33" W	18.04'	L44	N 72°37'10" W	98.05'	L80	S 06°32'57" E	21.84'
L9	N 77°59'33" W	25.81'	L45	S 44°45'26" W	32.89'	L81	S 63°24'14" W	17.76'
L10	S 87°56'28" W	30.36'	L46	N 38°42'19" W	20.44'	L82	S 59°11'39" E	18.62'
L11	N 65°46'22" W	18.49'	L47	S 81°31'34" W	30.27'	L83	S 54°38'16" W	10.93'
L12	N 05°40'01" W	15.07'	L48	S 51°12'14" W	18.81'	L84	N 59°11'39" W	9.32'
L13	N 74°07'36" W	18.60'	L49	S 17°08'55" W	38.17'	L85	N 59°11'39" W	50.00'
L14	N 03°25'42" W	25.44'	L50	S 51°58'29" W	22.90'	L86	S 59°11'39" W	36.94'
L15	S 81°10'18" W	28.53'	L51	N 79°17'31" W	25.01'	L87	N 42°52'35" W	136.18'
L16	S 75°00'14" W	18.28'	L52	S 88°30'15" W	24.99'	L88	N 32°16'43" W	122.21'
L17	S 86°30'42" W	32.79'	L53	S 65°34'20" W	19.60'	L89	N 57°51'02" W	109.47'
L18	S 60°36'03" W	22.47'	L54	S 03°51'23" W	26.53'	L90	S 69°05'37" W	110.54'
L19	S 31°51'48" W	29.55'	L55	S 52°52'44" W	21.13'	L91	N 72°37'10" W	94.62'
L20	S 31°37'48" W	27.80'	L56	S 69°56'35" W	23.00'	L92	N 17°22'50" E	50.00'
L21	S 43°12'44" W	28.96'	L57	S 79°56'26" W	30.12'	L93	N 69°05'37" E	110.54'
L22	S 80°46'12" W	28.58'	L58	N 88°07'43" W	19.02'	L98	N 34°53'13" W	15.98'
L23	N 53°35'16" W	31.67'	L59	S 57°32'55" W	16.07'	L99	S 32°08'58" W	36.34'
L24	N 58°09'12" W	16.43'	L60	N 66°46'39" W	25.52'	L100	S 17°22'50" W	77.64'
L25	N 70°19'10" W	45.15'	L61	N 89°47'45" W	14.12'	L101	S 24°02'52" W	51.98'
L26	N 53°41'27" W	20.92'	L62	S 25°57'17" W	17.25'	L102	S 59°11'39" E	15.00'
L27	N 37°32'44" W	29.12'	L63	N 56°21'59" W	24.83'	L103	N 30°48'21" E	59.66'
L28	N 30°58'10" W	41.09'	L64	N 76°23'56" W	32.64'	L104	N 69°05'37" E	10.11'
L29	N 45°44'26" W	31.02'	L65	N 64°41'27" W	22.80'	L105	S 41°00'26" E	43.78'
L30	N 66°46'38" W	27.01'	L66	N 73°33'23" W	33.87'	L106	S 40°15'00" E	21.32'
L31	N 82°01'05" W	18.77'	L67	S 61°45'16" W	26.26'	L107	N 29°41'39" W	21.95'
L32	S 81°06'07" W	14.28'	L68	S 88°50'17" W	27.21'	L108	N 24°43'48" W	83.50'
L33	N 15°51'41" W	18.60'	L69	S 71°49'31" W	33.63'			
L34	N 48°14'33" E	15.30'	L70	N 59°21'10" W	14.42'			
L35	N 44°00'20" W	33.55'	L71	N 80°33'58" W	40.14'			
L36	N 04°25'12" W	15.99'	L72	S 54°13'15" W	22.35'			

CONDOMINIUM PLAT OF PHASE THREE MAINSTAY AT COMMONWEALTH GREEN SECTION ONE

BETHEL MAGISTERIAL DISTRICT COUNTY OF YORK, VIRGINIA  
SCALE: 1"=10' DATE: NOVEMBER 12, 2018 SHEET 6 OF 7

DAVIS & ASSOCIATES, P.C.  
LAND SURVEYORS AND PLANNERS  
3630 GEORGE WASHINGTON MEMORIAL HIGHWAY  
YORKTOWN, VIRGINIA 23693  
(757)867-8583

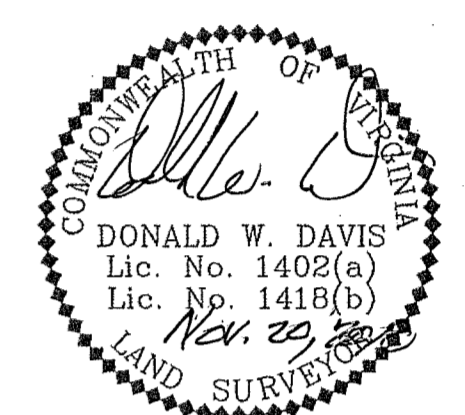
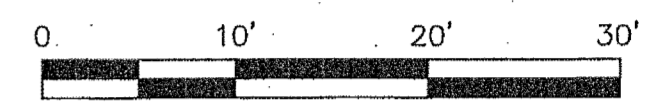

PHASE THREE - BUILDING FOUR DETAIL  
DIMENSIONS REFLECT INTERIOR FRAME LINE

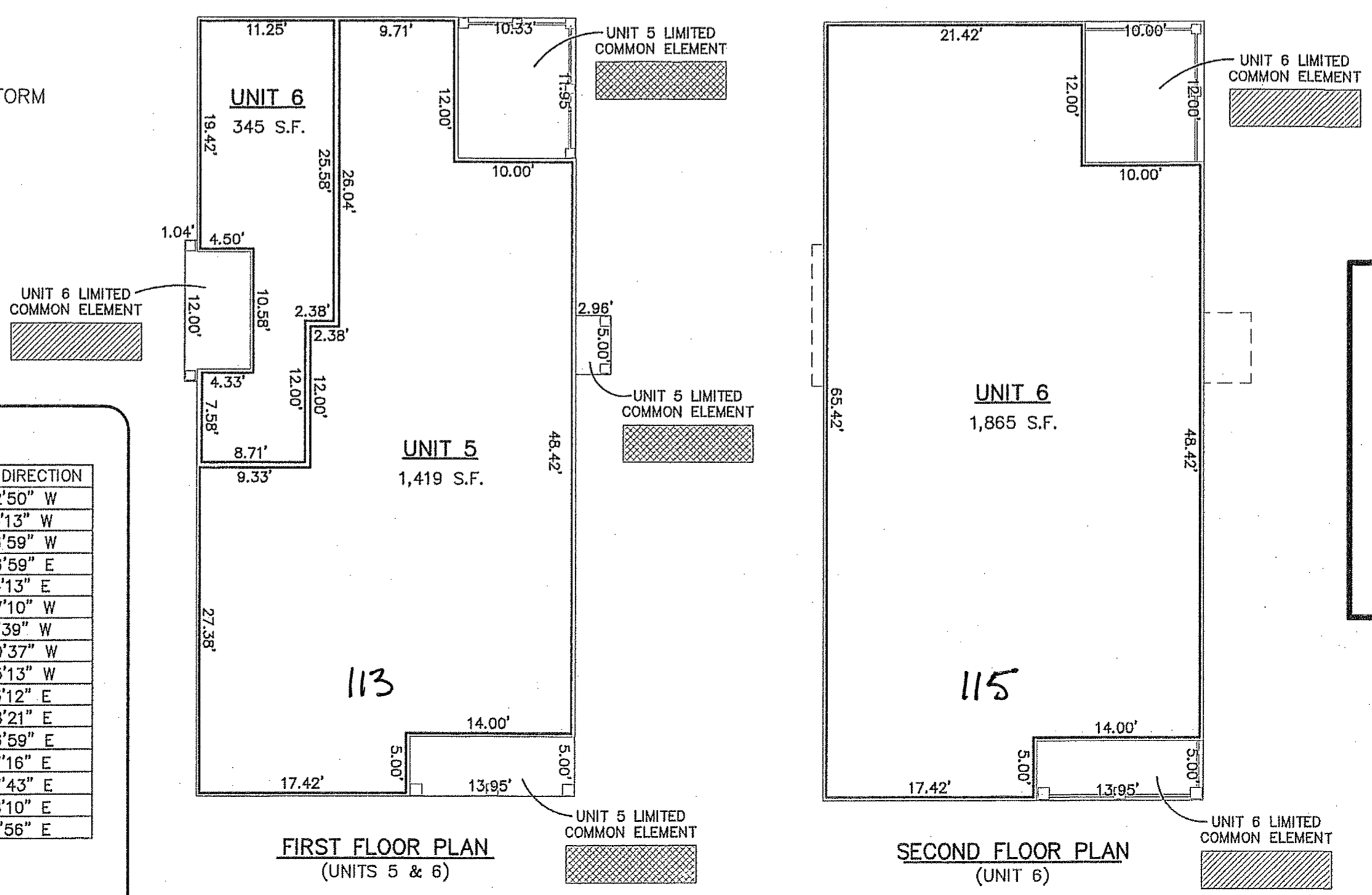

- SYMBOLS -
- DENOTES LIMITED COMMON ELEMENT - UNIT 5
  - DENOTES LIMITED COMMON ELEMENT - UNIT 6

APPROVED  
YORK COUNTY BOARD OF SUPERVISORS  
BY: *Erin Kassel*  
PLAT APPROVING AGENT  
DATE: MAY 16, 2019

STATE OF VIRGINIA 19 MAY 16 AM 11:20  
COUNTY OF YORK  
IN THE CLERK'S OFFICE OF THE YORK - POQUOSON CIRCUIT COURT THIS 16 DAY OF May 2019, THIS MAP WAS PRESENTED AND ADMITTED TO RECORD AS THE LAW DIRECTS AS INSTRUMENT # 190007160  
TESTE: *Kristen N. Nelson*  
CLERK  
BY: *Traci Bejae*

CURVE DATA TABLE

NUMBER	DELTA ANGLE	RADIUS	ARC LENGTH	TANGENT	CHORD LENGTH	CHORD DIRECTION
C1	90°00'00"	25.00'	39.27'	25.00'	35.36'	S 62°22'50" W
C2	38°17'13"	250.00'	167.06'	86.78'	163.97'	S 88°14'13" W
C3	38°17'16"	250.00'	167.06'	86.78'	163.97'	S 49°56'59" W
C4	38°17'16"	200.00'	133.65'	69.43'	131.18'	N 49°56'59" E
C5	38°17'13"	200.00'	133.65'	69.43'	131.17'	N 88°14'13" E
C6	90°00'00"	25.00'	39.27'	25.00'	35.36'	N 27°37'10" W
C7	90°00'00"	25.00'	39.27'	25.00'	35.36'	N 14°11'39" W
C8	03°14'48"	322.54'	18.28'	9.14'	18.27'	N 36°30'37" W
C9	13°14'23"	155.13'	35.85'	18.00'	35.77'	N 44°45'13" W
C11	47°16'53"	24.50'	20.22'	10.72'	19.65'	S 35°33'12" E
C12	90°00'00"	72.00'	113.10'	72.00'	101.82'	N 75°48'21" E
C13	38°17'16"	95.00'	63.48'	32.98'	62.31'	N 49°56'59" E
C15	72°13'40"	1.00'	1.26'	0.73'	1.18'	S 77°07'16" E
C16	145°12'46"	8.83'	22.38'	28.19'	16.85'	S 40°37'43" E
C17	72°13'40"	1.00'	1.26'	0.73'	1.18'	S 04°08'10" E
C18	20°00'28"	61.34'	21.42'	10.82'	21.31'	S 46°19'56" E