

DENOTES BMP CONSERVATION AREA
 "BMP CONSERVATION AREAS" SHALL REMAIN IN A NATURAL VEGETATED STATE
 "BMP CONSERVATION AREAS" CAN BE BUSH HOGGED NO MORE THAN FOUR (4) TIMES PER YEAR

NOW OR FORMERLY STEVEN E. MOORE, ET UX
 MAP #30-00-00-232
 GPIN U05d-4547-1037
 D.B. 570, PG. 278
 ZONE: RR

NOW OR FORMERLY SARA DEANE FERGUSON MILLS
 MAP #30-00-00-227A
 GPIN V05c-0141-1148
 INSTR. # 020002268
 ZONE: RR

NOW OR FORMERLY WILLIAM LEE BARBER, JR. ET UX
 MAP #31-00-00-021
 GPIN V05c-0180-0857
 INSTR. # 050003587
 ZONE: RR

NOW OR FORMERLY MALLORY FALLON PEEBLES ET ALS
 MAP #31-00-00-022A
 GPIN V05c-0320-0824
 INSTR. # 190000317
 ZONE: RR

APPROVED
 YORK COUNTY BOARD OF SUPERVISORS
 BY: *Susan Kaul*
 PLAT APPROVING AGENT
 DATE: NOVEMBER 25, 2019

STATE OF VIRGINIA
 COUNTY OF YORK
 IN THE CLERK'S OFFICE OF THE CIRCUIT COURT FOR THE COUNTY OF YORK-POQUOSON, ON THIS 25th DAY OF November, 2019.
 THIS MAP WAS PRESENTED AND ADMITTED TO RECORD AS THE LAW DIRECTS, AS INSTRUMENT NUMBER 190019805

TESTE: *Kristen N. Nelson*
 CLERK
 BY: *Priscilla J. Mc...*

CURVE DATA

CURVE #	RADIUS	LENGTH	DELTA	TANGENT	CHORD
C1	300.00'	268.73'	51°19'28"	144.14'	S83°55'37"E 259.84'
C5	250.00'	223.95'	51°19'28"	120.11'	N83°55'37"W 216.53'

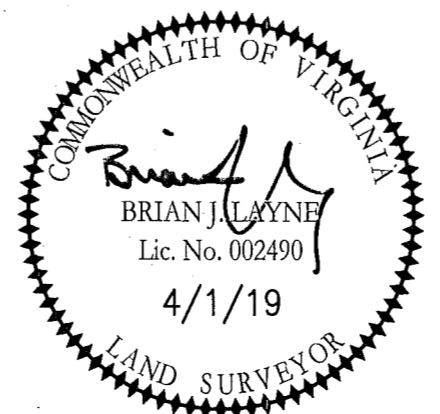

SUBDIVISION PLAT OF
BUNTING POINT PHASE 2
 BETHEL DISTRICT, YORK COUNTY, VIRGINIA

DRAWN: DHW	DATE: 4/1/19	REVISION:
COMP: BJL	SCALE: 1"=50'	
CHECKED: BJL		

PARRISH LAYNE
DESIGN GROUP
 Engineers • Surveyors • Planners
 P.O. Box 9164, Chesapeake, VA 23321
 Phone: 757.686.3345 Fax: 757.686.3348

REF: INST# 170014092
 SHEET NO. **4**
 SHEET: 4 of 6

- LEGEND**
- IRON PIN FOUND (UNLESS OTHERWISE NOTED)
 - #5 IRON REBAR SET (UNLESS OTHERWISE NOTED)
 - #5 IRON REBAR SET IN CONCRETE

