

EASEMENT LEGEND

- ① - EXISTING 40' YORK COUNTY DRAINAGE EASEMENT [D.B. 359, PG. 469]
- ② - EXISTING 20' YORK COUNTY UTILITY EASEMENT (CENTERED OVER SANITARY SEWER LINE) [INST. # 170019369]
- ③ - EXISTING VARIABLE WIDTH YORK COUNTY SIGHT EASEMENT [INST. # 170019369]
- ④ - EXISTING PRIVATE 25' DRAINAGE AND UTILITY EASEMENT FOR THE BENEFIT OF TAX PARCELS #36-00-00-022 & #36-01-00-000A [INST. # 100021723]
- ⑤ - EXISTING VARIABLE WIDTH PRIVATE DRAINAGE AND UTILITY EASEMENT FOR THE BENEFIT OF TAX PARCELS #36-00-00-022 & #36-01-00-000A [INST. # 140021262]
- ⑥ - EXISTING 35' PRIVATE INGRESS/EGRESS, DRAINAGE AND UTILITIES EASEMENT [INST. # 170020100]
- ⑦ - EXISTING VARIABLE WIDTH DRAINAGE EASEMENT (OVER AND THROUGH STORMWATER BASIN, BMP #'s 3 & 4) [INST. # 170020100]
- ⑧ - EXISTING 10' DRAINAGE EASEMENT (CENTERED ON STORM DRAIN) [INST. # 170020100]
- ⑨ - EXISTING VARIABLE WIDTH YORK COUNTY WETLANDS CONSERVATION EASEMENT (OVER AND ACROSS JURISDICTIONAL WETLANDS) [INST. # 170019369]
- ⑪ - EXISTING VARIABLE WIDTH YORK COUNTY SIGHT EASEMENT [INST. # 170020100]
- ⑫ - EXISTING PRIVATE VARIABLE WIDTH PEDESTRIAN ACCESS ESMT. (ENCOMPASSING SIDEWALKS AND CROSSWALKS ADJACENT TO PUBLIC RIGHT-OF-WAYS). [INST. # 170019369]
- ⑬ - EXISTING PRIVATE VARIABLE WIDTH PEDESTRIAN ACCESS ESMT. (ENCOMPASSING SIDEWALKS AND CROSSWALKS ADJACENT TO PUBLIC RIGHT-OF-WAYS) [INST. # 170020100]
- ⑭ - EXISTING 20' YORK COUNTY UTILITY EASEMENT [INST. # 170020100]
- ⑮ - EXISTING PRIVATE 10' DRAINAGE EASEMENT (CENTERED ON STORM DRAIN) [INST. # 170019369]

LINE DATA TABLE

LINE	BEARING	DISTANCE	LINE	BEARING	DISTANCE	LINE	BEARING	DISTANCE
L1	S 17°22'50" W	77.64'	L21	N 89°47'45" W	14.12'	L41	S 63°24'14" W	17.76'
L2	S 24°02'52" W	51.98'	L22	S 25°57'17" W	17.25'	L42	S 59°11'39" E	18.62'
L3	N 41°02'25" W	22.47'	L23	N 56°21'59" W	24.83'	L43	S 54°38'16" W	10.93'
L4	N 72°37'10" W	98.05'	L24	N 76°23'56" W	32.64'	L44	N 59°11'39" W	9.32'
L5	S 44°45'26" W	32.89'	L25	N 64°41'27" W	22.80'	L45	S 59°11'39" E	15.00'
L6	N 38°42'19" W	20.44'	L26	N 73°33'23" W	33.87'	L46	N 30°48'21" E	59.66'
L7	S 81°31'34" W	30.27'	L27	S 61°45'16" W	26.26'	L47	N 69°05'37" E	110.54'
L8	S 51°12'14" W	18.81'	L28	S 88°50'17" W	27.21'	L48	S 72°37'10" E	98.22'
L9	S 17°08'55" W	38.17'	L29	S 71°49'31" W	33.63'			
L10	S 51°58'29" W	22.90'	L30	N 59°21'10" W	14.42'			
L11	N 79°17'31" W	25.01'	L31	N 80°33'58" W	40.14'			
L12	S 88°30'15" W	24.99'	L32	S 54°13'15" W	22.35'			
L13	S 65°34'20" W	19.60'	L33	N 89°57'38" W	12.55'			
L14	S 03°51'23" W	26.53'	L34	S 52°21'03" W	15.66'			
L15	S 52°52'44" W	21.13'	L35	S 03°51'00" W	13.19'			
L16	S 69°56'35" W	23.00'	L36	S 77°34'42" W	17.12'			
L17	S 79°56'26" W	30.12'	L37	S 05°06'51" E	11.62'			
L18	N 88°07'43" W	19.02'	L38	S 55°13'35" W	11.75'			
L19	S 57°32'55" W	16.07'	L39	N 77°41'13" W	11.01'			
L20	N 66°46'39" W	25.52'	L40	S 06°32'57" E	21.84'			

CURVE DATA TABLE

NUMBER	DELTA ANGLE	RADIUS	ARC LENGTH	TANGENT	CHORD LENGTH	CHORD DIRECTION
C1	90°00'00"	25.00'	39.27'	25.00'	35.36'	N 14°11'39" W
C2	38°17'16"	200.00'	133.65'	69.43'	131.18'	N 49°56'59" E
C3	38°17'13"	200.00'	133.65'	69.43'	131.17'	N 88°14'13" E
C4	47°16'53"	24.50'	20.22'	10.72'	19.65'	S 35°33'12" E
C5	90°00'00"	72.00'	113.10'	72.00'	101.82'	N 75°48'21" E
C6	38°17'16"	95.00'	63.48'	32.98'	62.31'	N 49°56'59" E
C7	38°17'16"	95.00'	63.48'	32.98'	62.31'	N 88°14'13" E

CONDOMINIUM PLAT
OF
PHASE NINE
MAINSTAY AT
COMMONWEALTH GREEN
SECTION ONE

BETHEL MAGISTERIAL DISTRICT
COUNTY OF YORK, VIRGINIA
SCALE: 1"=10' DATE: APRIL 1, 2020
SHEET 4 OF 5

DAVIS & ASSOCIATES, P.C.
LAND SURVEYORS AND PLANNERS
3630 GEORGE WASHINGTON MEMORIAL HIGHWAY
YORKTOWN, VIRGINIA 23693
(757)867-8583

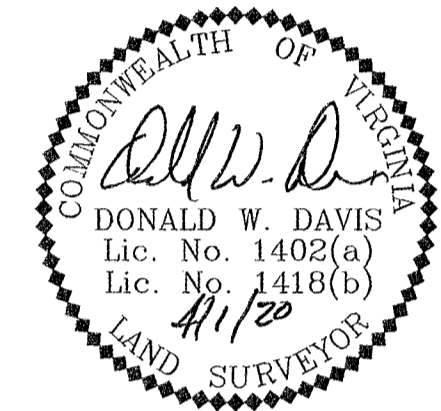

PHASE NINE - BUILDING TEN DETAIL

DIMENSIONS REFLECT INTERIOR FRAME LINE

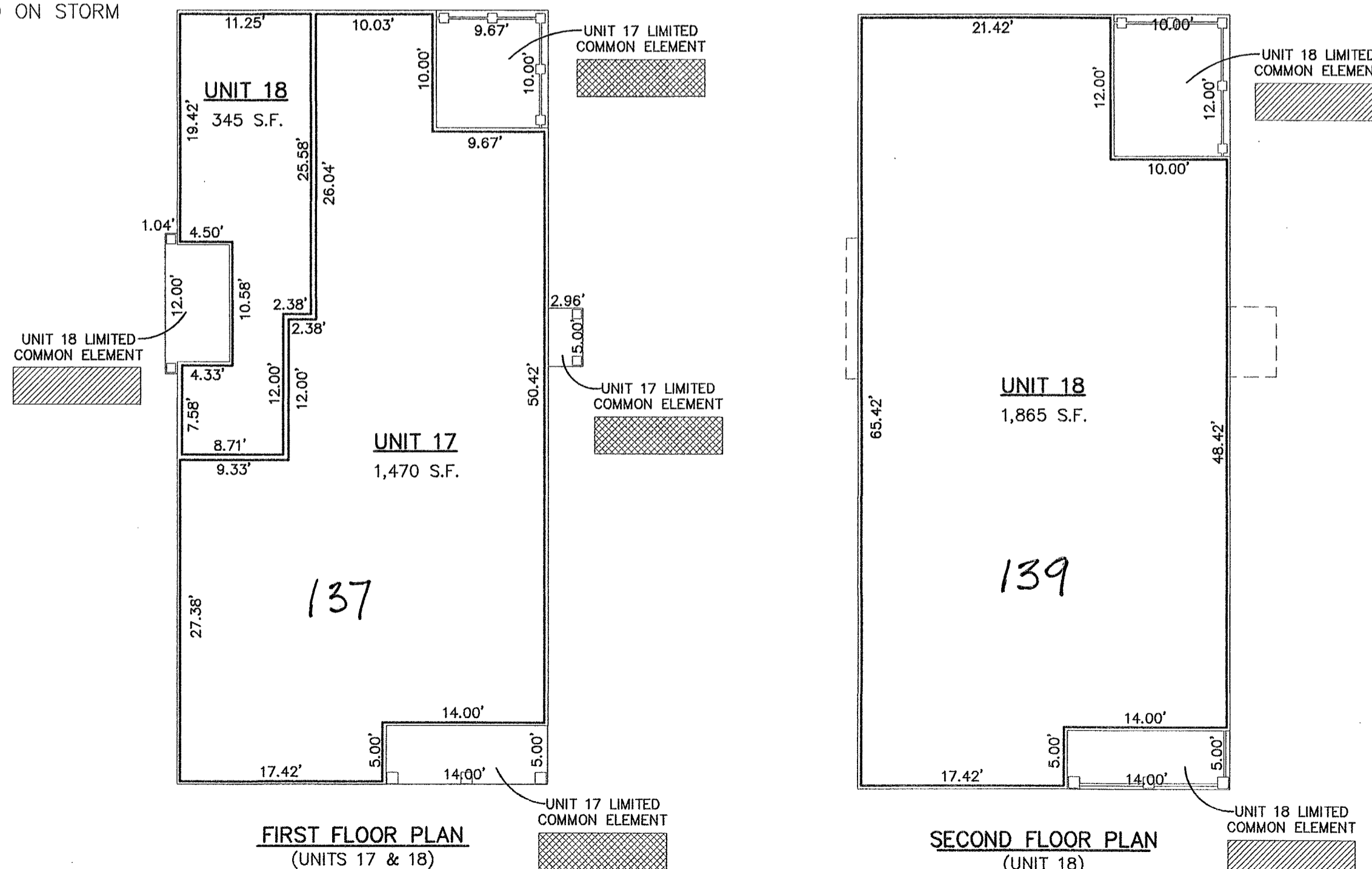

- SYMBOLS -

- DENOTES LIMITED COMMON ELEMENT - UNIT 17
- DENOTES LIMITED COMMON ELEMENT - UNIT 18

APPROVED
YORK COUNTY BOARD OF SUPERVISORS
BY: Erin Kassel
PLAT APPROVING AGENT
DATE: MAY 12, 2020

STATE OF VIRGINIA
COUNTY OF YORK
IN THE CLERK'S OFFICE OF THE YORK
POQUOSON CIRCUIT COURT THIS 14th
DAY OF May 2020, THIS MAP WAS
PRESENTED AND ADMITTED TO RECORD AS
THE LAW DIRECTS AS INSTRUMENT # 200008003

TESTE: KRISTEN N. NELSON, CLERK
CLERK
BY: Mega Buena