

Instrument # 200014836

LIMITED ACCESS HIGHWAY By Resolution of Commonwealth Transportation Board dated Oct. 4, 1956 and as amended on Oct. 30, 2018

d:\0668966.dgn  
Plotted By: trydel



PROJECT MANAGER Janet Hedrick, P.E. - VDOT Hampton Roads District - (757)494-5478  
SURVEYED BY, Dewberry Engineers Inc., 2/18  
DESIGNED BY Dewberry Engineers Inc. - (703) 289-4796  
SUBSURFACE UTILITY BY, Accumark, Inc., 3/18



REVISED	STATE	ROUTE	STATE PROJECT	SHEET NO.
	VA.	64	0064-965-229 R-201,C-501	66

DESIGN FEATURES RELATING TO CONSTRUCTION OR TO REGULATION AND CONTROL OF TRAFFIC MAY BE SUBJECT TO CHANGE AS DEEMED NECESSARY BY THE DEPARTMENT

Steven Kuntz  
2018.11.25 18:58:45 -05'00'  
Dewberry Engineers Inc.  
Fairfax, Virginia  
HYDRAULIC ENGINEER

Steven Kuntz  
2018.11.25 18:58:52 -05'00'  
Dewberry Engineers Inc.  
Fairfax, Virginia  
ROADWAY ENGINEER

CIVIL WAR  
PRESERVATION TRUST  
INSTR. # 150023134  
GPIN HI4c-0514-1246  
23.78 Ac.

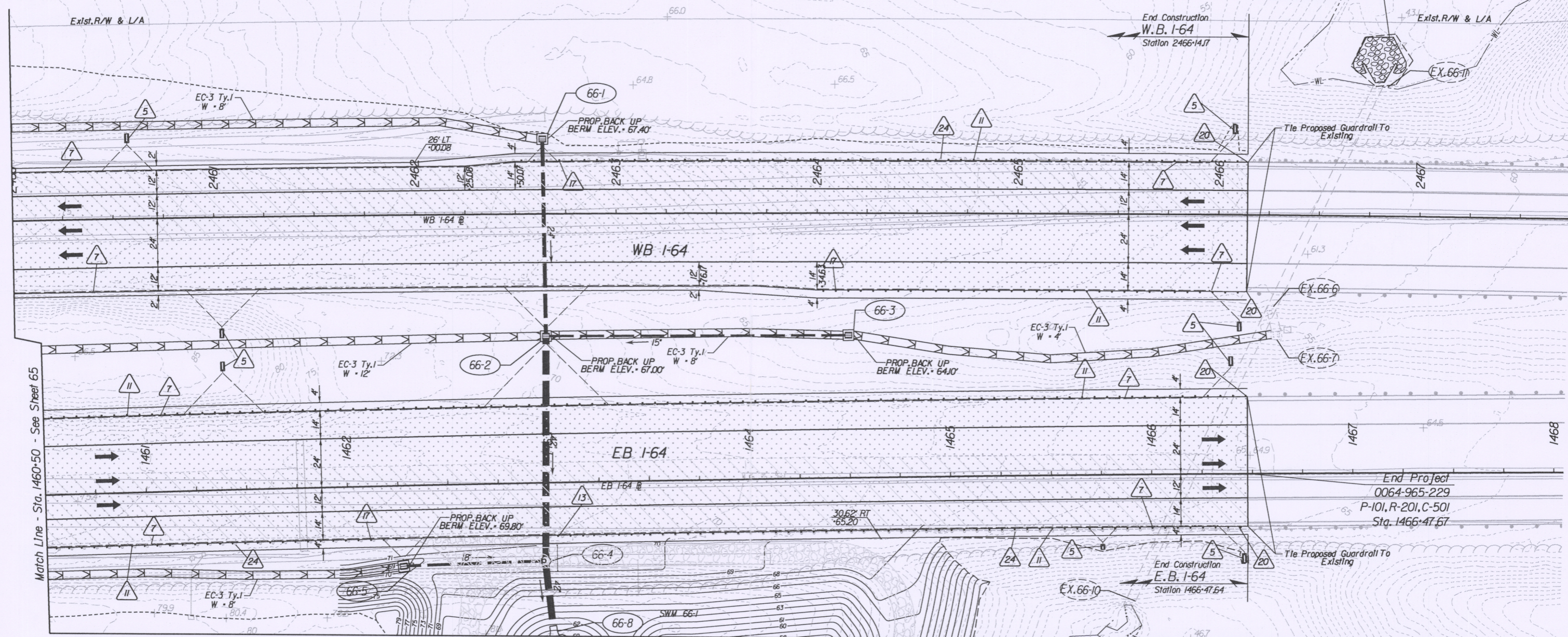

Match Line - Sta. 1460+50 - See Sheet 65

Match Line - See Sheet 66(1)

Key Legend

- 1 4" Curb, S'd, CG-3 Req'd.
- 2 Conc. Raised Median, S'd, MS-1 Req'd.
- 3 Conc. Raised Median, S'd, MS-1A Req'd.
- 4 Asphalt Concrete Curb, S'd, MC-3B Req'd.
- 5 Underdrain Endwall, S'd, EW-12 Req'd.
- 6 Median Underdrain, S'd, UD-2 Req'd.
- 7 Pavement Underdrain, S'd, UD-4 Req'd.
- 8 Crossdrain, S'd, CD-1 Req'd.
- 9 Crossdrain, S'd, CD-2 Req'd.
- 10 VDOT Fence, S'd, F-12 Req'd.
- 11 Guardrail, S'd, GR-MGS1A Req'd.
- 12 Guardrail, S'd, GR-MGS1A Req'd.
- 13 Guardrail Terminal, S'd, GR-MGS2 Req'd.
- 14 Guardrail, S'd, GR-10, Type I Req'd.
- 15 Guardrail, S'd, GR-10, Type II Req'd.
- 16 Guardrail, S'd, GR-10, Type III Req'd.
- 17 Trailing End Terminal, S'd, GR-MGS3 Req'd.
- 18 Fixed Object Att., S'd, GR-FOA-2 Ty. I Req'd.
- 19 Fixed Object Att., S'd, GR-FOA-2 Ty. II Req'd.
- 20 Guardrail, S'd, GR-MGS4 Req'd.
- 21 Conc. Median Barrier, S'd, MB-7D Req'd.
- 22 Conc. Median Barrier, S'd, MB-7F Req'd.
- 23 Bridge Pier Protection, BPPS-1 Req'd.
- 24 Remove Exst. Guardrail
- 25 Remove Exst. Fence
- 26 Remove Exst. Structure
- 27 Remove Exst. Pipe
- 28 Remove Exst. Pole
- 29 Adjust Exst. Structure
- 30 Clean Out Exst. Structure
- 31 Clean Out Existing Pipe
- 32 Pipe To Be Removed
- 33 Pipe To Be Abandoned and Plugged
- 34 Stone For Erosion Control, S'd, EC-I Class I Req'd.
- 35 Stone For Erosion Control, S'd, EC-I Class II Req'd.
- 36 Stone For Erosion Control, S'd, EC-I Class A1 Req'd.
- 37 S'd, EC-3 Type B Outlet Protection Req'd.
- 38 Fixed Object Att., S'd, GR-FOA-1 Ty. I Req'd.
- 39 Fixed Object Att., S'd, GR-FOA-1 Ty. II Req'd.

- Denotes Full Depth Pavement
- Denotes Pavement Demolition
- Denotes Pavement Overlay
- Denotes Milling and Overlay
- Denotes Gravel

C --- Denotes Construction Limits In Cuts  
F --- Denotes Construction Limits In Fills

REFERENCES  
(PROFILES, DETAIL & DRAINAGE DESCRIPTION SHEETS, ETC.)

- Alignment Data 1G
- Erosion & Sediment Control 2D
- SWM #66-1 Detail 2B(25)
- I-64 Profiles 66A
- Drainage Descriptions 67
- Storm Sewer Profiles 68
- Ditch Tabulations 69

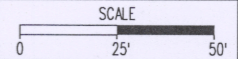

PROJECT	SHEET NO.
0064-965-229	66