

EASEMENT LEGEND

- 1 - EXISTING PRIVATE 25' DRAINAGE AND UTILITY EASEMENT FOR THE BENEFIT OF TAX PARCELS #36-00-00-022 & #36-01-00-000A [INST. # 100021723]
- 2 - EXISTING VARIABLE WIDTH PRIVATE DRAINAGE AND UTILITY EASEMENT FOR THE BENEFIT OF TAX PARCELS #36-00-00-022 & #36-01-00-000A [INST. # 140021262]
- 3 - EXISTING 35' PRIVATE INGRESS/EGRESS, DRAINAGE AND UTILITIES EASEMENT [INST. # 170020100]
- 4 - EXISTING VARIABLE WIDTH DRAINAGE EASEMENT (OVER AND THROUGH STORMWATER BASIN, BMP #'s 3 & 4) [INST. # 170020100]
- 5 - EXISTING 10' DRAINAGE EASEMENT (CENTERED ON STORM DRAIN) [INST. # 170020100]
- 6 - EXISTING VARIABLE WIDTH YORK COUNTY WETLANDS CONSERVATION EASEMENT (OVER AND ACROSS JURISDICTIONAL WETLANDS) [INST # 170019369]
- 7 - EXISTING VARIABLE WIDTH YORK COUNTY SIGHT EASEMENT [INST. # 170020100]
- 8 - EXISTING PRIVATE VARIABLE WIDTH PEDESTRIAN ACCESS ESMT. (ENCOMPASSING SIDEWALKS AND CROSSWALKS ADJACENT TO PUBLIC RIGHT-OF-WAYS) [INST. # 170020100]
- 9 - EXISTING 20' YORK COUNTY UTILITY EASEMENT [INST. # 170020100]
- 10 - 35' PRIVATE INGRESS/EGRESS, DRAINAGE AND UTILITIES EASEMENT [INST. # 200004253]
- 11 - 10' DRAINAGE EASEMENT [INST. # 200004253]
- 12 - TEMPORARY TURNAROUND EASEMENT TO BE VACATED UPON THE EXTENSION OF KEENER WAY (50' PUBLIC R/W) AND FUTURE JEANETTE DRIVE (50' PUBLIC R/W) [INST. # 200004253]
- 13 - VARIABLE WIDTH SIGHT EASEMENT [INST. # 200004253]
- 14 - VARIABLE WIDTH PRIVATE PEDESTRIAN ACCESS EASEMENT (ENCOMPASSING SIDEWALKS AND CROSSWALKS ADJACENT TO PUBLIC) RIGHT-OF-WAYS) [INST. # 200004253]

LINE DATA TABLE

LINE	BEARING	DISTANCE	LINE	BEARING	DISTANCE	LINE	BEARING	DISTANCE
L1	S 72°39'25" E	133.70'	L21	N 53°35'16" W	31.67'	L41	S 24°02'52" W	51.98'
L2	S 72°48'23" E	84.27'	L22	N 58°09'12" W	16.43'	L42	S 17°22'50" W	77.64'
L3	S 80°15'53" E	47.00'	L23	N 70°19'10" W	45.15'	L43	N 74°32'39" E	12.81'
L4	S 09°44'07" W	21.36'	L24	N 53°41'27" W	20.92'	L44	S 72°37'10" E	101.63'
L5	N 80°15'53" W	137.70'	L25	N 37°32'44" W	29.12'	L45	S 17°22'50" W	63.00'
L6	S 89°53'33" W	18.04'	L26	N 30°58'10" W	41.09'			
L7	N 77°59'33" W	25.81'	L27	N 45°44'26" W	31.02'			
L8	S 87°56'28" W	30.36'	L28	N 66°46'38" W	27.01'			
L9	N 65°46'22" W	18.49'	L29	N 82°01'05" W	18.77'			
L10	N 05°40'01" W	15.07'	L30	S 81°06'07" W	14.28'			
L11	N 74°07'36" W	18.60'	L31	N 15°51'41" W	18.60'			
L12	N 03°25'42" W	25.44'	L32	N 48°14'33" E	15.30'			
L13	S 81°10'18" W	28.53'	L33	N 44°00'20" W	33.55'			
L14	S 75°00'14" W	18.28'	L34	N 04°25'12" W	15.99'			
L15	S 86°30'42" W	32.79'	L35	N 35°13'01" E	34.53'			
L16	S 60°36'03" W	22.47'	L36	N 36°58'28" W	22.16'			
L17	S 31°51'48" W	29.55'	L37	N 03°24'00" E	27.42'			
L18	S 31°37'48" W	27.80'	L38	N 14°01'34" E	7.71'			
L19	S 43°12'44" W	28.96'	L39	N 72°37'10" W	80.00'			
L20	S 80°46'12" W	28.58'	L40	S 78°14'24" W	24.16'			

CURVE DATA TABLE

NUMBER	DELTA ANGLE	RADIUS	ARC LENGTH	CHORD LENGTH	CHORD DIRECTION
C1	57°09'49"	54.50'	54.37'	52.15'	S 44°02'15" E
C2	47°16'53"	24.50'	20.22'	19.65'	N 06°15'36" W
C3	32°50'11"	24.50'	31.23'	30.81'	S 00°57'45" W

CONDOMINIUM PLAT
OF
PHASE FOURTEEN
AND
PHASE FIFTEEN
MAINSTAY AT
COMMONWEALTH GREEN
SECTION TWO

BETHEL MAGISTERIAL DISTRICT
COUNTY OF YORK, VIRGINIA
SCALE: 1"=10' DATE: AUGUST 25, 2020
SHEET 5 OF 6

DAVIS & ASSOCIATES, P.C.
LAND SURVEYORS AND PLANNERS
3630 GEORGE WASHINGTON MEMORIAL HIGHWAY
YORKTOWN, VIRGINIA 23693
(757)867-8583

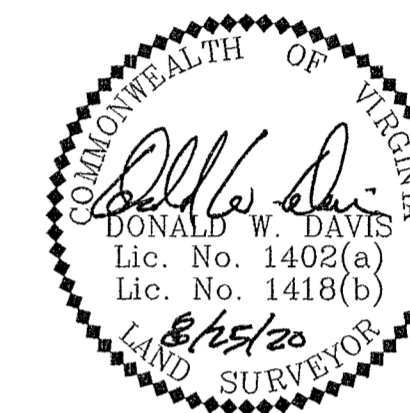

PHASE FOURTEEN - BUILDING FIFTEEN DETAIL (UNITS 27 & 28)
PHASE FIFTEEN - BUILDING SIXTEEN DETAIL (UNITS 29 & 30)

DIMENSIONS REFLECT INTERIOR FRAME LINE

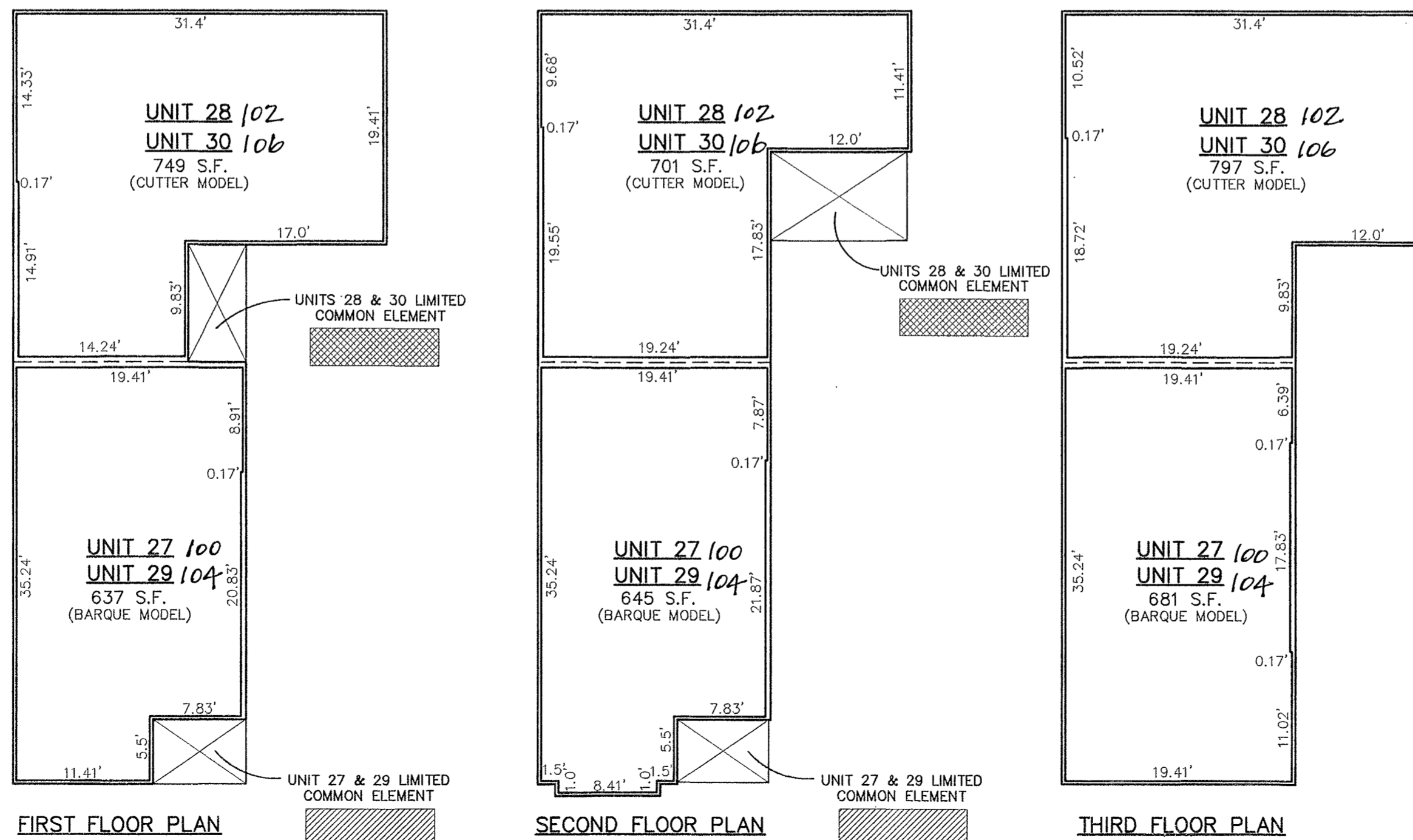

- S Y M B O L S -

- DENOTES LIMITED COMMON ELEMENT - UNITS 27 & 29
- DENOTES LIMITED COMMON ELEMENT - UNITS 28 & 30

APPROVED
YORK COUNTY BOARD OF SUPERVISORS
BY: Shawn Kassel
PLAT APPROVING AGENT
DATE: SEPTEMBER 24, 2020

STATE OF VIRGINIA
COUNTY OF YORK
IN THE CLERK'S OFFICE OF THE YORK
POQUOSON CIRCUIT COURT THIS 25th
DAY OF September 2020, THIS MAP WAS
PRESENTED AND ADMITTED TO RECORD AS
THE LAW DIRECTS AS INSTRUMENT # 20010280
TESTE: KRISTEN N. NELSON, CLERK
CLERK
BY: Deborah Mettelt