

PHASE SIXTEEN – BUILDING TWENTY FIVE DETAIL (UNITS 31 & 32)
 PHASE SEVENTEEN – BUILDING TWENTY SIX DETAIL (UNITS 33 & 34)

DIMENSIONS REFLECT INTERIOR FRAME LINE

CONDOMINIUM PLAT
 OF
 PHASE SIXTEEN
 AND
 PHASE SEVENTEEN
 MAINSTAY AT
 COMMONWEALTH GREEN
 SECTION TWO

BETHEL MAGISTERIAL DISTRICT
 COUNTY OF YORK, VIRGINIA
 SCALE: 1"=10' DATE: OCTOBER 15, 2020
 SHEET 5 OF 6

DAVIS & ASSOCIATES, P.C.
 LAND SURVEYORS AND PLANNERS
 3630 GEORGE WASHINGTON MEMORIAL HIGHWAY
 YORKTOWN, VIRGINIA 23693
 (757)867-8583

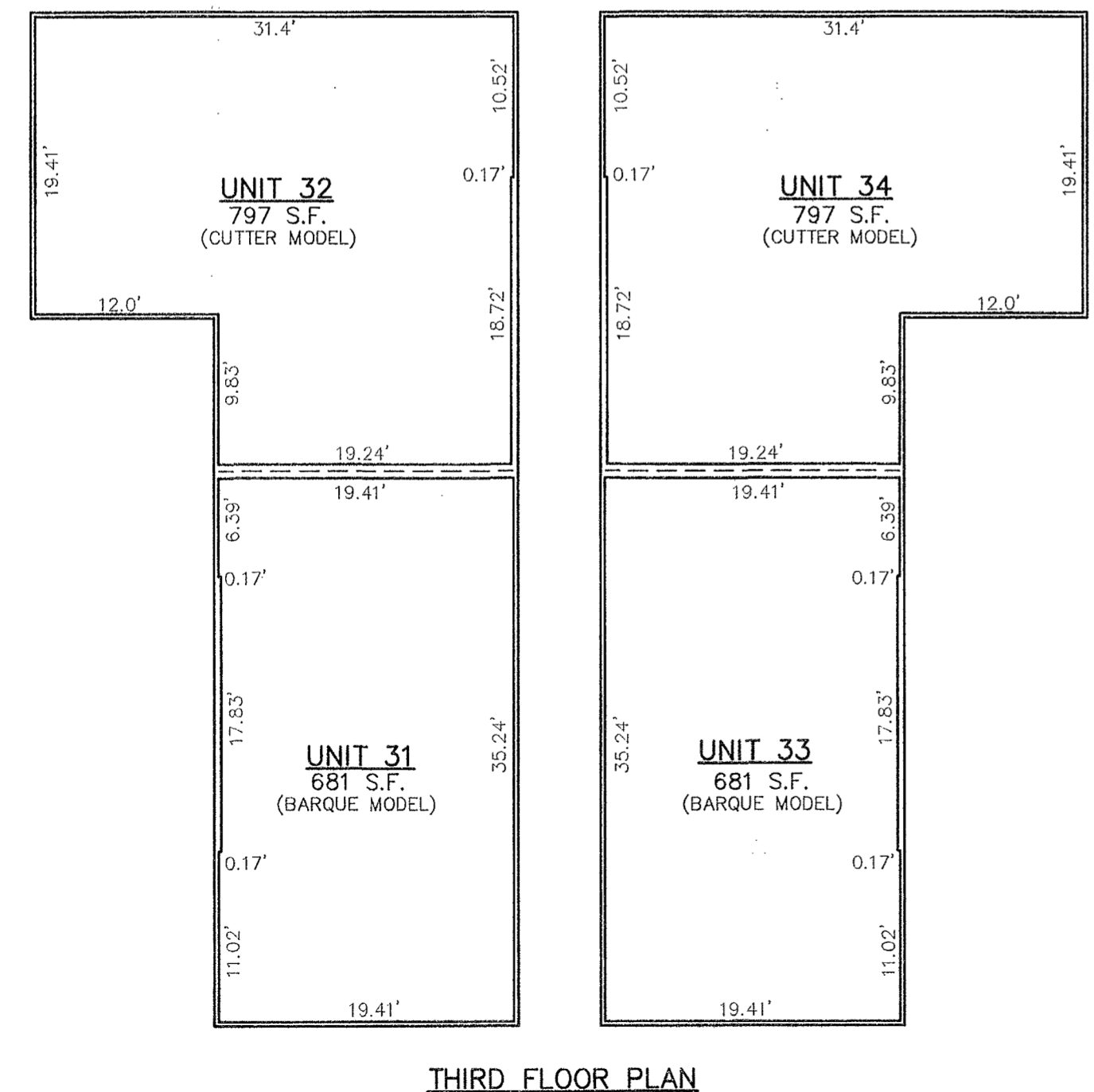
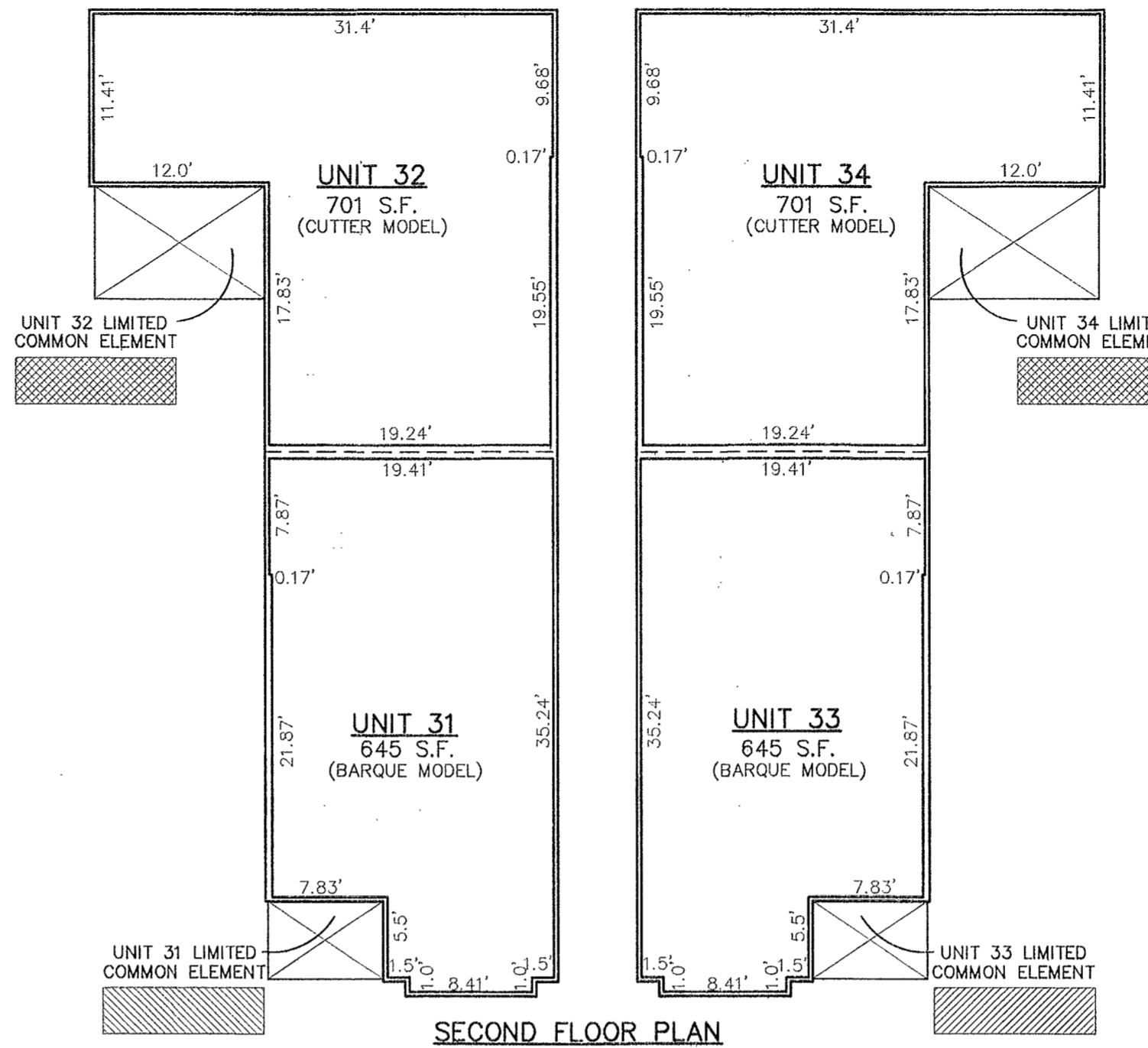
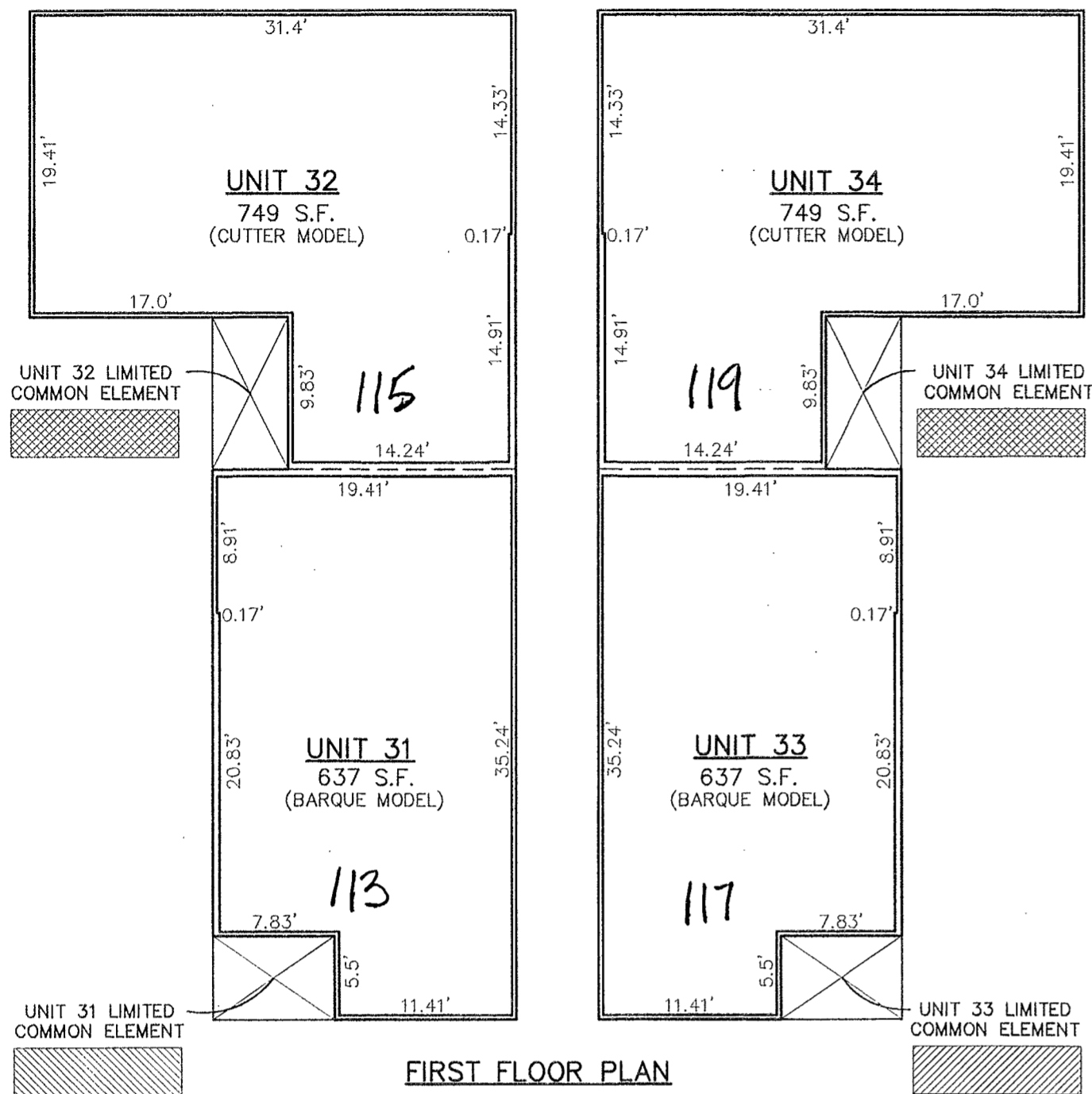
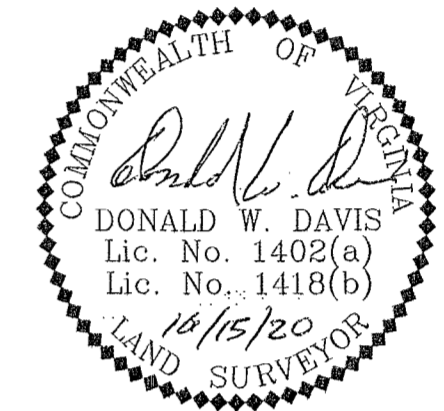
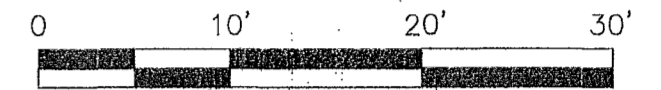

- SYMBOLS -

- DENOTES LIMITED COMMON ELEMENT - UNITS 31 & 33
- DENOTES LIMITED COMMON ELEMENT - UNITS 32 & 34

LINE DATA TABLE

LINE	BEARING	DISTANCE	LINE	BEARING	DISTANCE	LINE	BEARING	DISTANCE
L1	S 72°39'25" E	133.70'	L21	N 53°35'16" W	31.67'	L41	S 24°02'52" W	51.98'
L2	S 72°48'23" E	84.27'	L22	N 58°09'12" W	16.43'	L42	S 17°22'50" W	77.64'
L3	S 80°15'53" E	47.00'	L23	N 70°19'10" W	45.15'	L43	N 74°32'39" E	12.81'
L4	S 09°44'07" W	21.36'	L24	N 53°41'27" W	20.92'	L44	S 17°22'50" W	63.00'
L5	N 80°15'53" W	137.70'	L25	N 37°32'44" W	29.12'	L45	S 17°22'50" W	105.00'
L6	S 89°53'33" W	18.04'	L26	N 30°58'10" W	41.09'	L46	S 17°22'50" W	105.00'
L7	N 77°59'33" W	25.81'	L27	N 45°44'26" W	31.02'			
L8	S 87°56'28" W	30.36'	L28	N 66°46'38" W	27.01'			
L9	N 65°46'22" W	18.49'	L29	N 82°01'05" W	18.77'			
L10	N 05°40'01" W	15.07'	L30	S 81°06'07" W	14.28'			
L11	N 74°07'36" W	18.60'	L31	N 15°51'41" W	18.60'			
L12	N 03°25'42" W	25.44'	L32	N 48°14'33" E	15.30'			
L13	S 81°10'18" W	28.53'	L33	N 44°00'20" W	33.55'			
L14	S 75°00'14" W	18.28'	L34	N 04°25'12" W	15.99'			
L15	S 86°30'42" W	32.79'	L35	N 35°13'01" E	34.53'			
L16	S 60°36'03" W	22.47'	L36	N 36°58'28" W	22.16'			
L17	S 31°51'48" W	29.55'	L37	N 03°24'00" E	27.42'			
L18	S 31°37'48" W	27.80'	L38	N 14°01'34" E	7.71'			
L19	S 43°12'44" W	28.96'	L39	N 72°37'10" W	80.00'			
L20	S 80°46'12" W	28.58'	L40	S 78°14'24" W	24.16'			

CURVE DATA TABLE

NUMBER	DELTA ANGLE	RADIUS	ARC LENGTH	CHORD LENGTH	CHORD DIRECTION
C1	57°09'49"	54.50'	54.37'	52.15'	S 44°02'15" E
C2	47°16'53"	24.50'	20.22'	19.65'	S 41°01'17" W
C3	90°00'00"	24.00'	31.23'	33.94'	S 27°37'10" E

APPROVED
 YORK COUNTY BOARD OF SUPERVISORS

BY: Jason Kassel
 DEPUTY APPROVING AGENT

DATE: NOVEMBER 19, 2020

STATE OF VIRGINIA
 COUNTY OF YORK
 IN THE CLERK'S OFFICE OF THE YORK -
 POQUOSON CIRCUIT COURT THIS 20th
 DAY OF November 2020, THIS MAP WAS
 PRESENTED AND ADMITTED TO RECORD AS
 THE LAW DIRECTS AS INSTRUMENT # 20200615

TESTE: ANTHONY W. NELSON, CLERK
 CLERK

BY: Christina Webster-Roy, P.E.