

CONDOMINIUM PLAT OF PHASE TWENTY AND PHASE TWENTY ONE MAINSTAY AT COMMONWEALTH GREEN SECTION TWO

BETHEL MAGISTERIAL DISTRICT COUNTY OF YORK, VIRGINIA SCALE: 1"=40' DATE: NOVEMBER 23, 2020 SHEET 3 OF 6

DAVIS & ASSOCIATES, P.C. LAND SURVEYORS AND PLANNERS 3630 GEORGE WASHINGTON MEMORIAL HIGHWAY YORKTOWN, VIRGINIA 23693 (757)867-8583

BASIS: D.B.361 PG.769

'PARCEL D' SUBDIVISION PLAT OF MAINSTAY AT COMMONWEALTH GREEN SECTION ONE INST.# 170020100 ZONE: PDMU WITH PROFFERS GPIN: S03c-1292-0050 TAX MAP #: 36C-01-00-000D

NOW OR FORMERLY JEANETTE J. KEENER, TRUSTEE GPIN: S02a-2108-4966 TAX MAP # 36-00-00-022 INST. # 050008026 ZONE: EO / PD

'COMMON AREA C' INST.# 200004253 ZONE: PD GPIN: S02a-2450-4789 TAX MAP #: 36C-00-02-000C

'PARCEL A-1' PROPERTY LINE VACATION PLAT OF MAINSTAY AT COMMONWEALTH GREEN SECTION ONE INST.# 190004472 ZONE: PDMU WITH PROFFERS GPIN: S02a-1568-4684 TAX MAP #: 36C-01-00-000A

'PARCEL E' SUBDIVISION PLAT OF MAINSTAY AT COMMONWEALTH GREEN SECTION TWO INST.# 200004253 ZONE: PDMU WITH PROFFERS GPIN: S02a-2195-3879 TAX MAP #: 36-01-00-000A

'COMMON AREA B' SUBDIVISION PLAT OF NEW PARCEL ONE INST.# 170019369 ZONE: PDMU WITH PROFFERS GPIN: S02a-2177-4294 TAX MAP #: 36-01-00-001B

'PARCEL F' SUBDIVISION PLAT OF MAINSTAY AT COMMONWEALTH GREEN SECTION TWO INST.# 200004253 ZONE: PDMU WITH PROFFERS GPIN: S02a-2314-4523 TAX MAP #: 36-01-00-000A4

SYMBOLS legend including: DENOTES IRON PIPE FOUND, DENOTES IRON ROD FOUND, DENOTES IRON ROD TO BE SET AT ALL PROPERTY LINE JUNCTURES, DENOTES CONCRETE MONUMENT FOUND, DENOTES CONCRETE MONUMENT TO BE SET, DENOTES JURISDICTIONAL WETLANDS MARKED BY WOLFE ENVIRONMENTAL & ENGINEERING CONSULTANTS AND FIELD LOCATED BY DAVIS AND ASSOCIATES, P.C. ON DECEMBER 30, 2005 USCOE PROJECT # 05-R2629 USCOE PROJECT # 95-5485, DENOTES ADDITIONAL AND WITHDRAWABLE LAND "A", DENOTES LIMITED COMMON ELEMENT - UNIT 39 & UNIT 41, DENOTES LIMITED COMMON ELEMENT - UNIT 40 & UNIT 42

APPROVED YORK COUNTY BOARD OF SUPERVISORS BY: [Signature] PLAT APPROVING AGENT DATE: FEBRUARY 2, 2021

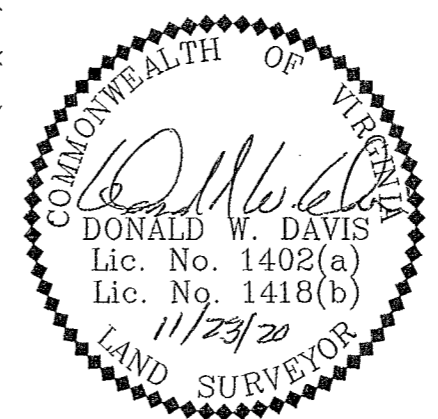

STATE OF VIRGINIA COUNTY OF YORK IN THE CLERK'S OFFICE OF THE YORK - POQUOSON, CIRCUIT COURT THIS 18th DAY OF February 2021, THIS MAP WAS PRESENTED AND ADMITTED TO RECORD AS THE LAW DIRECTS AS INSTRUMENT # 210002594 TESTE: Kristen N. Nelson CLERK BY: Leah Hyslop