

CONDOMINIUM PLAT  
OF  
PHASE TWENTY EIGHT  
AND  
PHASE TWENTY NINE  
MAINSTAY AT  
COMMONWEALTH GREEN  
SECTION TWO

BETHEL MAGISTERIAL DISTRICT  
COUNTY OF YORK, VIRGINIA  
SCALE: 1"=40' DATE: SEPTEMBER 22, 2021  
SHEET 3 OF 6

DAVIS & ASSOCIATES, P.C.  
LAND SURVEYORS AND PLANNERS  
3630 GEORGE WASHINGTON MEMORIAL HIGHWAY  
YORKTOWN, VIRGINIA 23693  
(757)867-8583

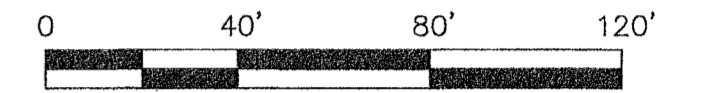

- SYMBOLS —
- DENOTES IRON PIPE FOUND
  - DENOTES IRON ROD FOUND
  - DENOTES IRON ROD TO BE SET AT ALL PROPERTY LINE JUNCTURES
  - DENOTES CONCRETE MONUMENT FOUND
  - DENOTES CONCRETE MONUMENT TO BE SET
  - DENOTES JURISDICTIONAL WETLANDS MARKED BY WOLFE ENVIRONMENTAL & ENGINEERING CONSULTANTS AND FIELD LOCATED BY DAVIS AND ASSOCIATES, P.C. ON DECEMBER 30, 2005 USCOE PROJECT # 05-R2629 USCOE PROJECT # 95-5485
  - DENOTES ADDITIONAL AND WITHDRAWABLE LAND "A"
  - DENOTES LIMITED COMMON ELEMENT - UNITS 55 & 57
  - DENOTES LIMITED COMMON ELEMENT - UNITS 56 & 58
  - DENOTES COMMON AREA WITHIN EACH PHASE

'PARCEL D'  
SUBDIVISION PLAT OF  
MAINSTAY AT COMMONWEALTH GREEN  
SECTION ONE  
INST. # 170020100  
ZONE: PDMU WITH PROFFERS  
GPIN: S03c-1292-0050  
TAX MAP #: 36C-01-00-000D

NOW OR FORMERLY  
JEANETTE J. KEENER, TRUSTEE  
GPIN: S02a-2108-4966  
TAX MAP # 36-00-00-022  
INST. # 050008026  
ZONE: EO / PD

BASIS: D.B.361 PG.769

'COMMON AREA C'  
INST. # 200004253  
ZONE: PD  
GPIN: S02a-2450-4789  
TAX MAP #: 36C-00-02-000C

'PARCEL A-1'  
PROPERTY LINE VACATION PLAT OF  
MAINSTAY AT COMMONWEALTH GREEN  
SECTION ONE  
INST. # 190004472  
ZONE: PDMU WITH PROFFERS  
GPIN: S02a-1568-4684  
TAX MAP #: 36C-01-00-000A

'PARCEL E'  
SUBDIVISION PLAT OF  
MAINSTAY AT COMMONWEALTH GREEN  
SECTION TWO  
INST. # 200004253  
ZONE: PDMU WITH PROFFERS  
GPIN: S02a-2195-3879  
TAX MAP #: 36-01-00-000A

'COMMON AREA B'  
SUBDIVISION PLAT OF  
NEW PARCEL ONE  
INST. # 170019369  
ZONE: PDMU WITH PROFFERS  
GPIN: S02a-2177-4294  
TAX MAP #: 36-01-00-001B

'PARCEL F'  
SUBDIVISION PLAT OF  
MAINSTAY AT COMMONWEALTH GREEN  
SECTION TWO  
INST. # 200004253  
ZONE: PDMU WITH PROFFERS  
GPIN: S02a-2314-4523  
TAX MAP #: 36-01-00-000A4

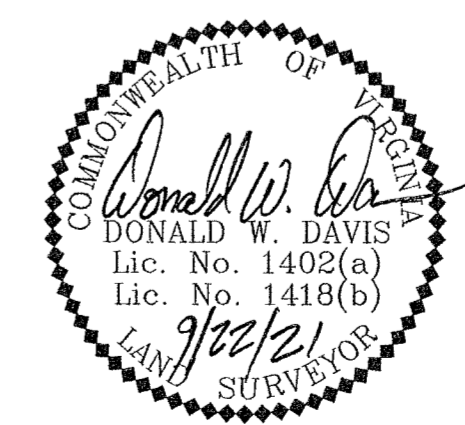

APPROVED  
YORK COUNTY BOARD OF SUPERVISORS  
BY: Sharon Kessler  
PLAT APPROVING AGENT  
DATE: NOVEMBER 8, 2021

STATE OF VIRGINIA  
COUNTY OF YORK  
IN THE CLERK'S OFFICE OF THE YORK -  
POQUOSON CIRCUIT COURT THIS 9th  
DAY OF November 2021, THIS MAP WAS  
PRESENTED AND ADMITTED TO RECORD AS  
THE LAW DIRECTS AS INSTRUMENT # 210022655  
TESTE: Kristen N. Nelson  
CLERK  
BY: Walter White, Jr.