

EASEMENT LEGEND

- ① - EXISTING 40' YORK COUNTY DRAINAGE EASEMENT [D.B. 359, PG. 469]
- ② - EXISTING 20' YORK COUNTY UTILITY EASEMENT (CENTERED OVER SANITARY SEWER LINE) [INST. # 170019369]
- ③ - EXISTING PRIVATE 25' DRAINAGE AND UTILITY EASEMENT FOR THE BENEFIT OF TAX PARCELS #36-00-00-022 & #36-01-00-000A [INST. # 100021723]
- ④ - EXISTING VARIABLE WIDTH DRAINAGE EASEMENT (OVER AND THROUGH STORMWATER BASIN, BMP #'s 3 & 4) [INST. # 170020100]
- ⑤ - EXISTING 10' DRAINAGE EASEMENT (CENTERED ON STORM DRAIN) [INST. # 170020100]
- ⑥ - EXISTING PRIVATE VARIABLE WIDTH PEDESTRIAN ACCESS ESMT. (ENCOMPASSING SIDEWALKS AND CROSSWALKS ADJACENT TO PUBLIC RIGHT-OF-WAYS) [INST. # 170020100]
- ⑦ - EXISTING PRIVATE 10' DRAINAGE EASEMENT (CENTERED ON STORM DRAIN) [INST. # 170019369]
- ⑧ - EXISTING VARIABLE WIDTH PRIVATE DRAINAGE AND UTILITY EASEMENT FOR THE BENEFIT OF TAX PARCELS #36-00-00-022 & #36-01-00-000A [INST. # 140021262]
- ⑨ - EXISTING VARIABLE WIDTH YORK COUNTY WETLANDS CONSERVATION EASEMENT (OVER AND ACROSS JURISDICTIONAL WETLANDS) [INST # 170019369]
- ⑩ - EXISTING 35' PRIVATE INGRESS/EGRESS, DRAINAGE AND UTILITIES EASEMENT [INST. # 200004253]
- ⑪ - EXISTING TEMPORARY TURNAROUND EASEMENT TO BE VACATED UPON THE EXTENSION OF KEENER WAY (50' PUBLIC R/W) AND FUTURE JEANETTE DRIVE (50' PUBLIC R/W)
- ⑫ - EXISTING VARIABLE WIDTH SIGHT EASEMENT [INST. # 200004253]
- ⑬ - 35' PRIVATE INGRESS/EGRESS, DRAINAGE AND UTILITIES EASEMENT HEREBY CONVEYED TO MAINSTAY CONDOMINIUM OWNERS ASSOCIATION
- ⑭ - EXISTING 20' DRAINAGE EASEMENT [INST. # 220008211]

CURVE DATA TABLE						
NUMBER	DELTA ANGLE	RADIUS	ARC LENGTH	TANGENT	CHORD LENGTH	CHORD DIRECTION
C1	90°00'00"	25.00'	39.27'	25.00'	35.36'	S 62°22'50" W
C2	38°17'13"	250.00'	167.06'	86.78'	163.97'	S 88°14'13" W
C3	38°17'16"	250.00'	167.06'	86.78'	163.97'	S 49°56'59" W
C4	03°14'48"	322.54'	18.28'	9.14'	18.27'	N 36°30'37" W
C5	13°14'23"	155.13'	35.85'	18.00'	35.77'	N 44°45'13" W
C6	03°14'48"	357.54'	20.26'	10.13'	20.26'	N 36°30'37" W

LINE DATA TABLE		
LINE	BEARING	DISTANCE
L1	N 59°11'39" W	36.94'
L2	S 52°53'42" E	34.51'
L3	N 34°53'13" W	15.98'
L4	S 32°08'58" W	36.34'
L5	N 34°53'13" W	15.98'
L6	N 38°08'01" W	67.14'

CONDOMINIUM PLAT
 OF
PHASE THIRTY FOUR
 AND
PHASE THIRTY FIVE
MAINSTAY AT
COMMONWEALTH GREEN
SECTION ONE - PARCEL 'D'
 BETHEL MAGISTERIAL DISTRICT
 COUNTY OF YORK, VIRGINIA
 SCALE: 1"=10' DATE: JUNE 27, 2022
 SHEET 6 OF 7
 DAVIS & ASSOCIATES, P.C.
 LAND SURVEYORS AND PLANNERS
 3630 GEORGE WASHINGTON MEMORIAL HIGHWAY
 YORKTOWN, VIRGINIA 23693
 (757)867-8583

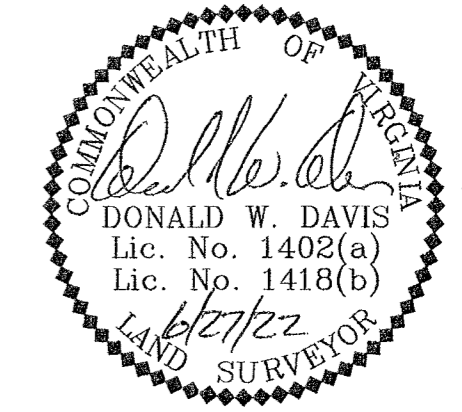
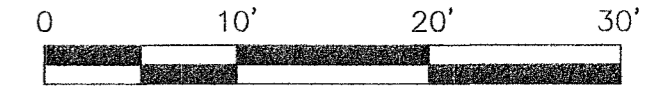

PHASE THIRTY FOUR - BUILDING FORTY FIVE DETAIL (UNITS 67 & 68)
PHASE THIRTY FIVE - BUILDING FORTY FOUR DETAIL (UNITS 69 & 70)

DIMENSIONS REFLECT INTERIOR FRAME LINE

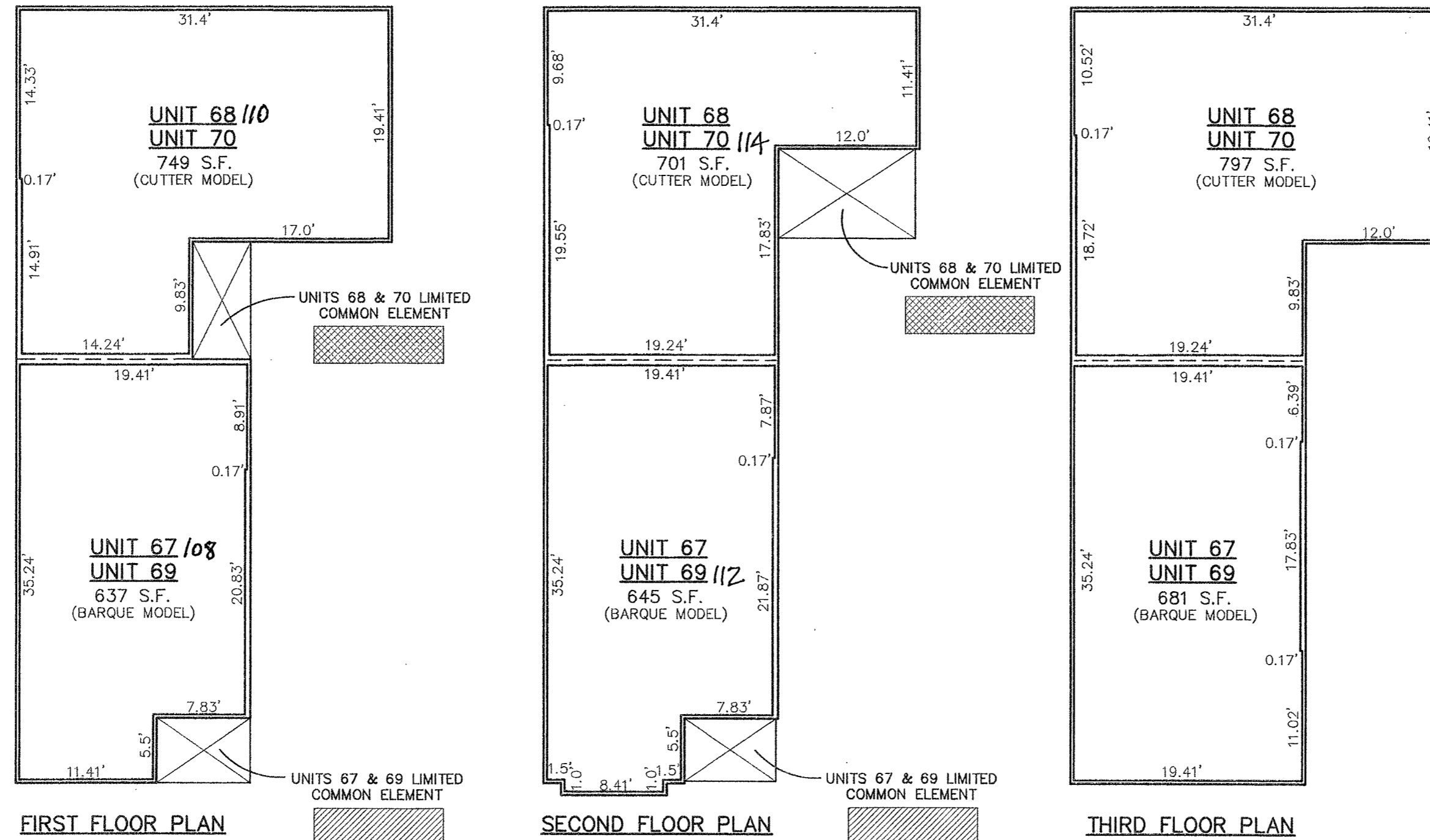

- S Y M B O L S -
- DENOTES LIMITED COMMON ELEMENT - UNITS 67 & 69
 - DENOTES LIMITED COMMON ELEMENT - UNITS 68 & 70

A P P R O V E D

YORK COUNTY BOARD OF SUPERVISORS

BY: *Susan Kassel* PLAT APPROVING AGENT

DATE: 8/11/22

STATE OF VIRGINIA
 COUNTY OF YORK
 IN THE CLERK'S OFFICE OF THE YORK -
 POQUOSON CIRCUIT COURT THIS 11
 DAY OF August 2022. THIS MAP WAS
 PRESENTED AND ADMITTED TO RECORD AS
 THE LAW DIRECTS AS INSTRUMENT #220013482

TESTE: *Kristen N. Nelson*
 CLERK

BY: *Donald W. Davis*