

MATCH LINE SEE SHEET 9

MONUMENTS LEGEND

	#5 REBAR SET	UNLESS OTHERWISE NOTED
	#5 REBAR FOUND	UNLESS OTHERWISE NOTED
	MON(F)	CONCRETE MONUMENT FOUND
	VDOT(F)	VDOT MONUMENT FOUND

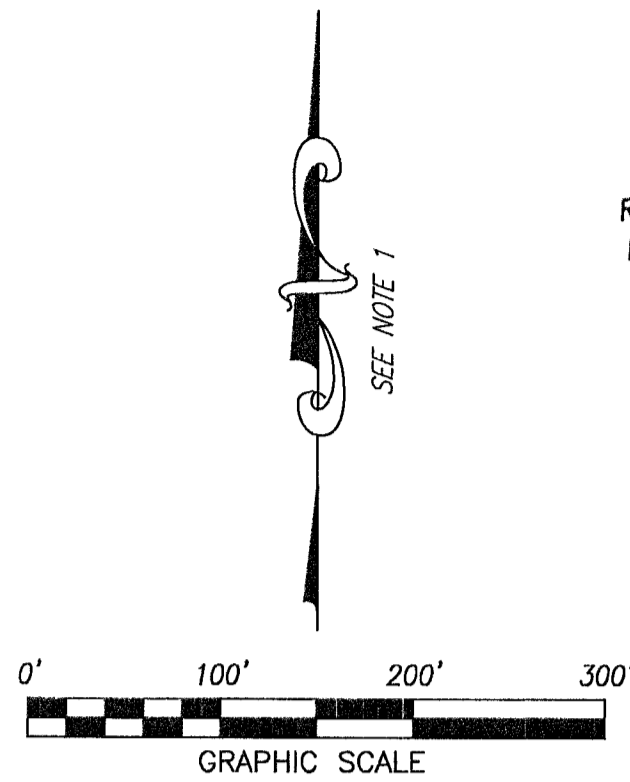

PLAT OF  
BOUNDARY LINE ADJUSTMENT AND PROPERTY LINE VACATION  
PART OF PARCEL 1A AND PART OF PARCEL 2

PROPERTY OWNED BY

**PENINSULA AIRPORT COMMISSION**

LOCATED IN  
GRAFTON DISTRICT  
YORK COUNTY, VIRGINIA

SCALE: 1" = 100'      DATE: JULY 16, 2022

(SHEET 11 OF 12)

**PRECISION MEASUREMENTS, INC.**

SURVEYORS • GPS • 3-D SCANNING • GIS • MAPPERS  
VIRGINIA BEACH-RICHMOND-NEWPORT NEWS-CHANTILLY, VIRGINIA  
11835 CANON BLVD, SUITE B-103  
NEWPORT NEWS, VIRGINIA 23606  
TEL: (757) 595-7570

NOW OR FORMERLY  
CITY OF NEWPORT NEWS  
N.N.D.B. 51, PG. 2  
D.B. 278, PG. 390  
P.B. 11, PG. 428-489  
CPIN: R06c-1589-2324  
ZONED: RC

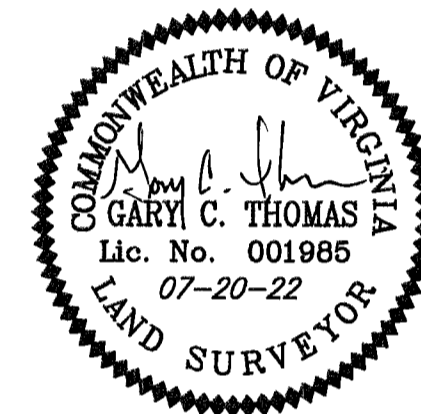

**PARCEL 2-A**

6,119,626 SQ. FEET  
140.487 ACRES

FORMER  
PARCEL 1A  
8,585,807 S.F./197.1030 AC.

FORMER  
PARCEL 2  
6,145,814 S.F./141.0885 AC.

MATCH LINE SEE SHEET 10

MATCH LINE SEE SHEET 12

APPROXIMATE  $\frac{1}{2}$  OF  
BRICK CHURCH ROAD  
DIRT & GRAVEL ROAD  
(WIDTH & STATUS UNDETERMINED)

N= 3,582,854.943  
E=12,070,118.884

S 75°17'53" W  
159.04'

PIPE(F)  
BENT

S 65°48'18" W  
149.70'

PIPE(F)  
BENT

S 14°51'43" E  
388.41'

PIPE(F)  
BENT

S 16°04'42" E  
1,049.23'

ROD(F)  
BENT

S 15°41'02" E  
1,299.96' TOTAL

**APPROVED**

YORK COUNTY BOARD OF SUPERVISORS

BY: Susan Kassel  
PLAT APPROVING AGENT

DATE: 9/23/22

STATE OF VIRGINIA:  
COUNTY OF YORK  
IN THE CLERK'S OFFICE OF THE CIRCUIT COURT FOR  
THE COUNTY OF YORK-POQUOSON, ON THIS  
23rd DAY OF September, 2022,  
THIS PLAT WAS PRESENTED AND ADMITTED TO RECORD  
AS THE LAW DIRECTS, AS INSTRUMENT NUMBER

220016710

TESTE KRISTEN H. NELSON, CLERK  
CLERK

BY: Barbara Hutchinson  
DEPUTY CLERK